

## Model 007 Cartridge Circulator

The Taco 007 Cartridge Circulator is the most popular hydronic circulator sold today. With its field serviceable cartridge design, the compact 007 provides quiet, efficient operation and unmatched reliability. The self-lubricating, maintenance free design and flow characteristics make it the ideal hydronic circulator for a wide range of applications.



Stainless Steel



Low Lead  
Compliant



# Submittal Data Information Model 007 Cartridge Circulators

Submittal Data # 101-029  
Supersedes: 06/01/11

Effective: 03/25/13

## Features

- Standard High Capacity Output-Compact Design
- Quiet, Efficient Operation
- Direct Drive-Low Power Consumption
- Unique Replaceable Cartridge Design-Field Serviceable
- Self Lubricating
- No Mechanical Seal
- Unmatched Reliability-Maintenance Free
- Universal Flange to Flange Dimensions
- Cast Iron or Stainless Steel Construction

## Materials of Construction

Casing (Volute):..... Cast Iron or Stainless Steel  
Stator Housing:..... Steel  
Cartridge:..... Stainless Steel  
Impeller: ..... Non-Metallic  
Shaft:..... Ceramic  
Bearings:..... Carbon  
O-Ring & Gaskets:..... EPDM

## Model Nomenclature

F - Cast Iron, Flanged  
SF - Stainless Steel, Flanged

## Performance Data

Flow Range: 0 – 23 GPM  
Head Range: 0 – 10 Feet  
Minimum Fluid Temperature: 40°F (4°C)  
Maximum Fluid Temperature:  
Cast Iron: 240°F (115°C)  
Stainless Steel: 230°F (110°C)  
Maximum Working Pressure: 125 psi  
Connection Sizes: 3/4", 1", 1-1/4", 1-1/2" Flanged

## Certifications & Listings

 **UL LISTED FOR INDOOR USE ONLY**

 **NSF Low-Lead Compliant**  
Certified to NSF/ANSI 372

## Application

The Taco 007 is a cartridge style, maintenance free, wet-rotor, in-line, single stage circulator pump. It is designed for quiet operation in Hydronic heating, Radiant heating, Hydro-Air fan coils, Indirect water heaters, Chilled fresh water, and Domestic Water Recirculation systems. Available in Cast Iron or Stainless Steel construction with universal flanged connections. The unique replaceable cartridge contains all of the moving parts and allows the circulator to be easily serviced instead of replacing the entire unit. Ideal for a wide range of applications.

## Pump Dimensions & Weights

Models	Casing	Flange Type*	A		B		C		D		F		G		Ship Wt.	
			in.	mm	in.	mm	in.	mm	in.	mm	in.	mm	in.	mm	lbs.	Kg
007-F5	Cast Iron	S	6-3/8	162	4-1/2	114	3-3/16	81	3-15/16	75	4-3/4	121	6-3/8	162	8.0	3.6
007-F5-5	Cast Iron	R	6-1/2	152	4-1/2	114	3-3/16	81	3-15/16	75	4-3/4	121	6-3/8	162	8.0	3.6
007-SF5	St. Steel	S	6-3/8	162	4-1/2	114	3-3/16	81	3-15/16	75	4-3/4	121	6-3/8	162	7.0	3.2

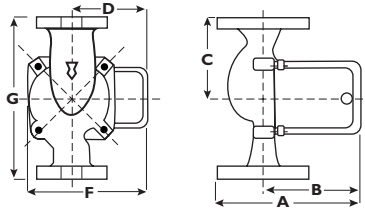

## Mounting Positions

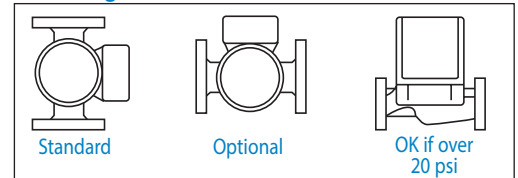

## Electrical Data

Model	Volts	Hz	Ph	Amps	RPM	HP
007-F5	115	60	1	.71	3250	1/25
007-SF5	115	60	1	.75	3250	1/25
Motor Type	Permanent Split Capacitor Impedance Protected					
Motor Options	220/50/1, 220/60/1, 230/60/1, 100/110/50/60/1					

## \*Flange Orientation Type

