



# Submittal Data Information

101-067

## Model 006-IFC Cartridge Circulator

Effective: March 29, 2017

Supersedes: March 26, 2013

Job: \_\_\_\_\_ Engineer: \_\_\_\_\_ Contractor: \_\_\_\_\_ Rep: \_\_\_\_\_

ITEM NO.	MODEL NO.

### Features

- Integral Flow Check (IFC) Patent# 5,664,939
  - Prevents gravity flow / reverse flow
  - Eliminates separate in-line flow check
  - Reduces installed cost
  - Improves system performance
  - Easy to service
- Unique replaceable cartridge
  - Field serviceable
- Unmatched reliability-Maintenance free
- Quiet, efficient operation
- Self lubricating, No mechanical seal
- Wide range of applications
- Bronze 1/2", 3/4" sweat or Stainless Steel with union connections

### Materials of Construction

Casing (Volute): .....Low-lead Bronze or St. Steel  
 Integral Flow Check:  
 Body, Plunger.....Acetal  
 O-ring Seals.....EPDM  
 Spring .....Stainless Steel  
 Stator housing: .....Steel  
 Cartridge: .....Stainless Steel  
 Impeller:.....Non-metallic  
 Shaft:.....Ceramic  
 Bearings:.....Carbon  
 O-Ring & Gaskets:.....EPDM - Chlorine resistant

### Model Nomenclature

BC - Bronze sweat connections, panel mount tapings  
 SC - Stainless Steel, union connection, panel mount tapings  
 IFC - Integral Flow Check

### Performance Data

Flow Range: 0 – 9 GPM  
 Head Range: 0 – 8.5 Feet  
 Minimum Fluid Temperature: 40°F (4°C)  
 Maximum Fluid Temperature: 220°F (104°C)  
 Maximum Working Pressure: 125 psi  
 Connection sizes: 1/2", 3/4" sweat or union

### Certifications & Listings



### Application

- Domestic Hot Water Recirculation
- Hydro-Air Fan Coils
- Heat Recovery Units
- Water Source Heat Pumps
- Potable Water Systems

The 006-IFC with an Integral Flow Check (IFC) is designed for the circulation of hot or chilled fresh water in open or closed loop applications. The IFC feature simplifies piping, eliminates separate in-line flow check, reduces installation costs and improves system performance. With its patented location at the impeller inlet\*, the IFC is easy to service without removing the entire unit from system piping. The unique, replaceable cartridge contains all of the moving parts and allows for easy service instead of replacing the entire circulator.

\* IFC is located in the discharge port on union connection model only

### Pump Dimensions & Weights

Models	Conn.	A		B		C		D		E		F		Ship Wt.	
		in.	mm	in.	mm	in.	mm	in.	mm	in.	mm	in.	mm	lbs.	Kg
006-BC7-1 IFC	1/2" Swt.	6	152	4-7/8	124	2-3/16	56	3-15/16	75	3-15/16	84	4-3/8	111	6.0	2.7
006-BC7-IFC	3/4" Swt.	6	152	4-7/8	124	2-3/16	56	3-15/16	75	3-15/16	84	4-3/8	111	6.0	2.7
006-SC7-IFC	Union	6	152	4-7/8	124	2-31/32	76	3-15/16	75	3-15/16	84	5-15/16	151	6.0	2.7

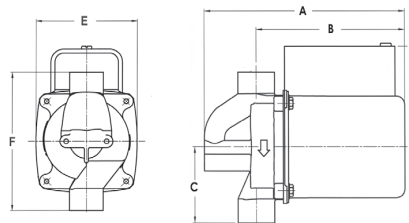

### Mounting Positions

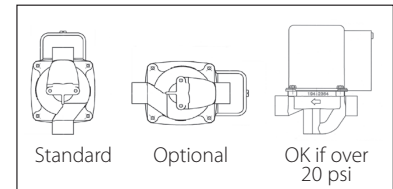

### Electrical Data

Model	Volts	Hz	Ph	Amps	RPM	HP
All 006 Models	115	60	1	.52	3250	1/40
Motor Type	Permanent Split Capacitor Impedance Protected					
Motor Options	220/50/1, 220/60/1, 230/60/1, 100/110/50/60/1					

Taco INTEGRAL FLOWCHECK (IFC) MODELS

