

Direct Drive Fan Single & Double Shaft 5.0" Diameter, Open Air Over

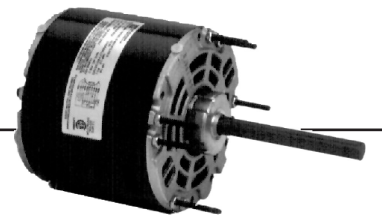

APPLICATIONS:

To meet manufacturer's requirements for direct drive fans and blowers.

FEATURES:

- Bearings Have All Angle Thrust System
- Continuous Duty, Air Over
- 24" Line Leads Unless Otherwise Noted
- Automatic Reset Thermal Overload Protector
- Connection Information Furnished in the Nameplate Data
- Shaded Pole Design Except Where Noted
- **Discount Symbol: DS-3HAC**

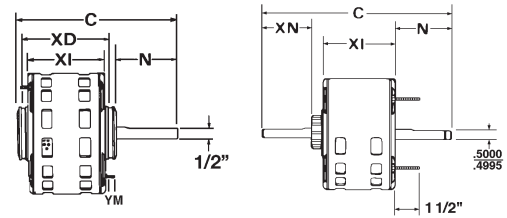

Figure A

Figure B

5.0" Diameter, Stud or Hub Ring Mount (2.5") (Figure A)

HP	RPM/ Spds.	Voltage	Catalog Number	List	Bearings	NEMA [†] Frame	Amps	Shaft N	Base XD	Shell XI	Total C	Stud YM	Ship Wt. (lbs)	Notes	OEM
1/15	1050	115	1334	\$134	SAB	42Y	2.8	1.9	--	3.3	5.2	0.6	10	84,H3,H6,H16	
	1050	115	1335	\$136	SAB	42Y	2.8	1.3	3.8	3.3	5.7	--	12	35,84,H6,H16	
	1050	115	1342	\$126	SAB	42Y	2.6	2.8	--	3.8	6.6	0.6	10	84,H16,H19	
	1050/2	115	1333	\$138	SAB	42Y	3	1.9	--	3.3	5.2	0.6	11	84,H3,H16	
1/10	1050	115	1336	\$124	SAB	42Y	3.7	1.8	--	3.8	5.7	0.6	11	84,H3,H6,H16	
1/8	1050	115	1337	\$129	SAB	42Y	5.5	5.0	5.0	4.5	10.4	0.9	13	84,H3,H16	
1/6	1050	115	1127P	\$101	SAB	42Y	3.0	4.0	5.0	4.3	9.4	--	12	84,H3,H16,H38	
	1050	115	2166P	\$198	SAB	42Y	5.2	3.5	4.5	3.8	8.9	--	10	84,H16	MI
1/5	1050	115	1340	\$133	SAB	42Y	7.1	2.2	5.2	4.7	7.9	0.9	14	84,H3,H16	
	1050/3	115	1338P	\$151	SAB	42Y	3.2	4.9	5.5	5.0	10.9	0.9	14	84,H3,H16,H38	
	1050/3	208-230	1339	\$164	SAB	42Y	3.9	4.9	5.5	5.0	10.9	0.9	14	84,H3,H16	
1/4	1050	115	1341	\$134	SAB	42Y	8.9	2.6	5.7	5.2	8.7	0.9	15	84,H3,H16	

5.0" Diameter, Resilient Base, Double Shaft (Figure B)

HP	RPM/ Spds.	Voltage	Catalog Number	List	Bearings	Rotation LE	Amps	Shaft N	Shaft XN	Shell XI	Total C	Ship Wt. (lbs)	Notes	OEM
1/10	1050/2	115	2819	\$123	SAB	CCW	3.7	4.0	4.0	3.8	14.3	10		
	1050/2	230	2820	\$244	SAB	CCW	2.0	4.0	4.0	3.3	14.3	10		
	1050/4	115	2818	\$196	SAB	CCW	4.8	8.4	8.4	4.6	22.4	11		
	1050/5	115	2827P	\$265	SAB	CW	2.5	10.0	10.0	4.1	25.2	9	H34	
	1550/3	115	2817	\$273	SAB	CCW	3.8	8.4	8.4	4.6	22.4	8		
1/6	1625/2	115	1238	\$176	SAB	CCW	2.3	7.0	7.0	3.9	18.9	11	H38	
1/5	1075	208-230	1124	\$209	SAB	CW	1.3	5.7	5.7	4.1	16.5	12	H37	YK
1/4	1550/3	230	1221P	\$262	SAB	CCW	1.6	8.0	8.0	4.3	20.9	14	H3,H21	

MI = Miller^{®†} YK = York^{®†}

Note 35 Includes Base
 Note 84 Non-reversible
 Note H3 20" Leads
 Note H6 3/8" Shaft
 Note H16 Rotation CCWLE

Note H19 Conduit Box on Motor
 Note H21 Figure B Type Includes Mounting Kit; Non-reversible
 Note H34 Non-reversible; 54" Leads; Includes Resilient Base
 Note H37 PSC; 5.0 MFD Capacitor Required
 Note H38 PSC; Capacitor Included and Attached

† All marks shown within this document are properties of their respective owners.

