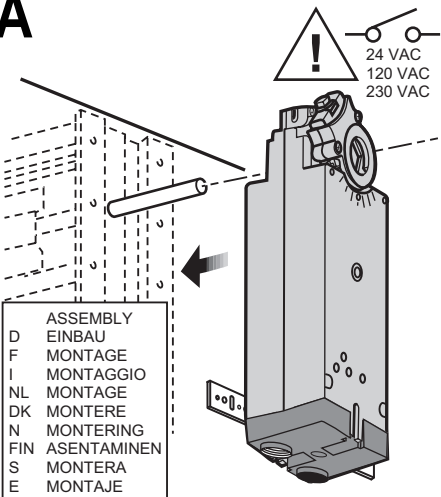
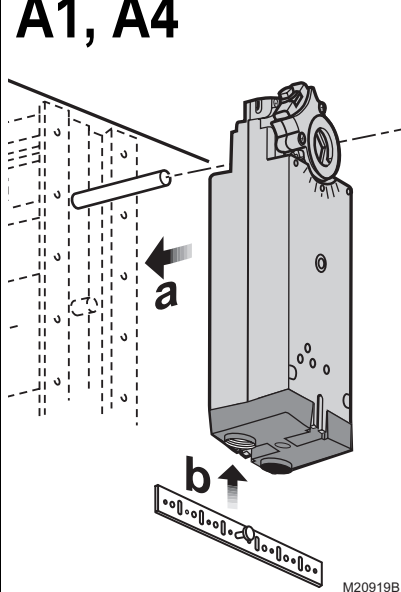
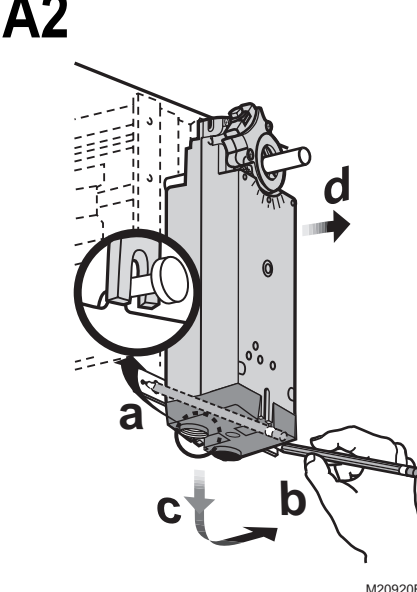
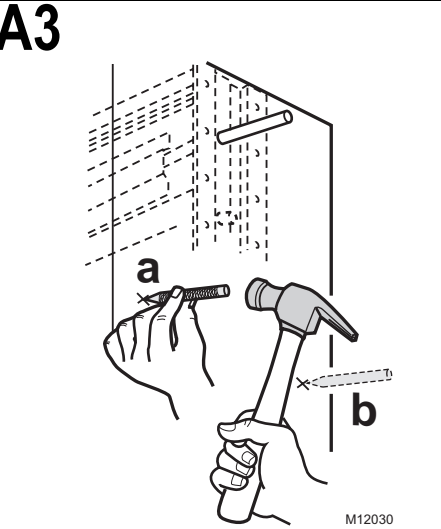
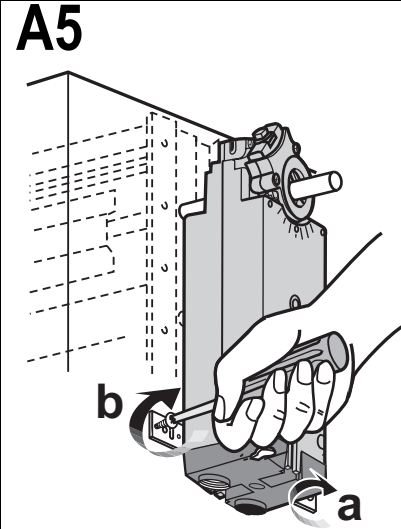
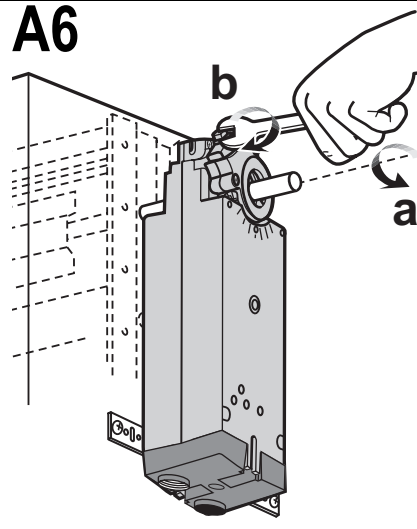

- D Montageanweisung
- F Instructions d'Installation
- I Istruzioni per l'Installazione
- NL Installatievoorschrift
- DK Installationsinstruks
- N Installationsinstruktioner
- SF Asennusohje
- S Installations Instruktioner
- E Instrucciones de montaje

S05, S10, S20 Series Spring Return Direct Coupled Actuators

MS41XX, MS46XX, MS71XX, MS75XX, MS81XX

INSTALLATION INSTRUCTIONS

<p>A</p>  <table border="1" style="width: 100%; border-collapse: collapse; margin-top: 10px;"> <tr> <td style="padding: 2px;">ASSEMBLY</td> </tr> <tr> <td style="padding: 2px;">D EINBAU</td> </tr> <tr> <td style="padding: 2px;">F MONTAGE</td> </tr> <tr> <td style="padding: 2px;">I MONTAGGIO</td> </tr> <tr> <td style="padding: 2px;">NL MONTAGE</td> </tr> <tr> <td style="padding: 2px;">DK MONTERE</td> </tr> <tr> <td style="padding: 2px;">N MONTERING</td> </tr> <tr> <td style="padding: 2px;">FIN ASENTAMINEN</td> </tr> <tr> <td style="padding: 2px;">S MONTERA</td> </tr> <tr> <td style="padding: 2px;">E MONTAJE</td> </tr> </table> <p style="text-align: right; font-size: small;">M20918B</p>	ASSEMBLY	D EINBAU	F MONTAGE	I MONTAGGIO	NL MONTAGE	DK MONTERE	N MONTERING	FIN ASENTAMINEN	S MONTERA	E MONTAJE	<p>A1, A4</p>  <p style="text-align: right; font-size: small;">M20919B</p>	<p>A2</p>  <p style="text-align: right; font-size: small;">M20920B</p>
ASSEMBLY												
D EINBAU												
F MONTAGE												
I MONTAGGIO												
NL MONTAGE												
DK MONTERE												
N MONTERING												
FIN ASENTAMINEN												
S MONTERA												
E MONTAJE												
<p>A3</p>  <p style="text-align: right; font-size: small;">M12030</p>	<p>A5</p>  <p style="text-align: right; font-size: small;">M20921B</p>	<p>A6</p>  <p style="text-align: right; font-size: small;">M20922B</p>										



S05, S10, S20 SERIES SPRING RETURN DIRECT COUPLED ACTUATORS

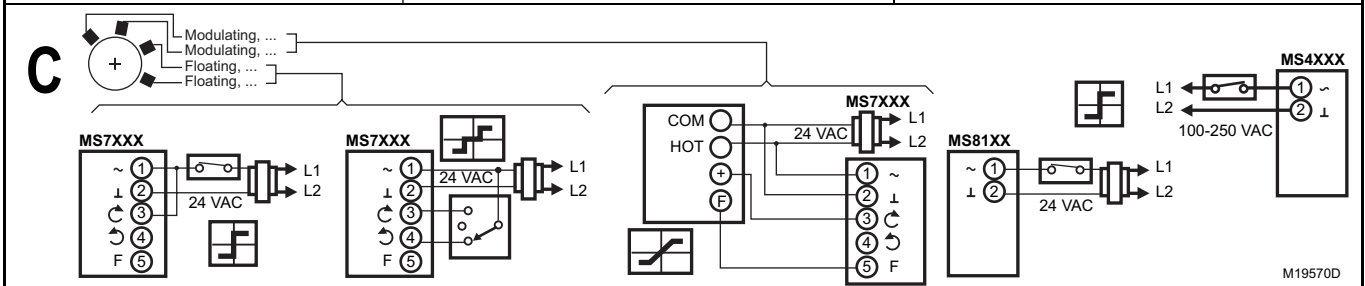
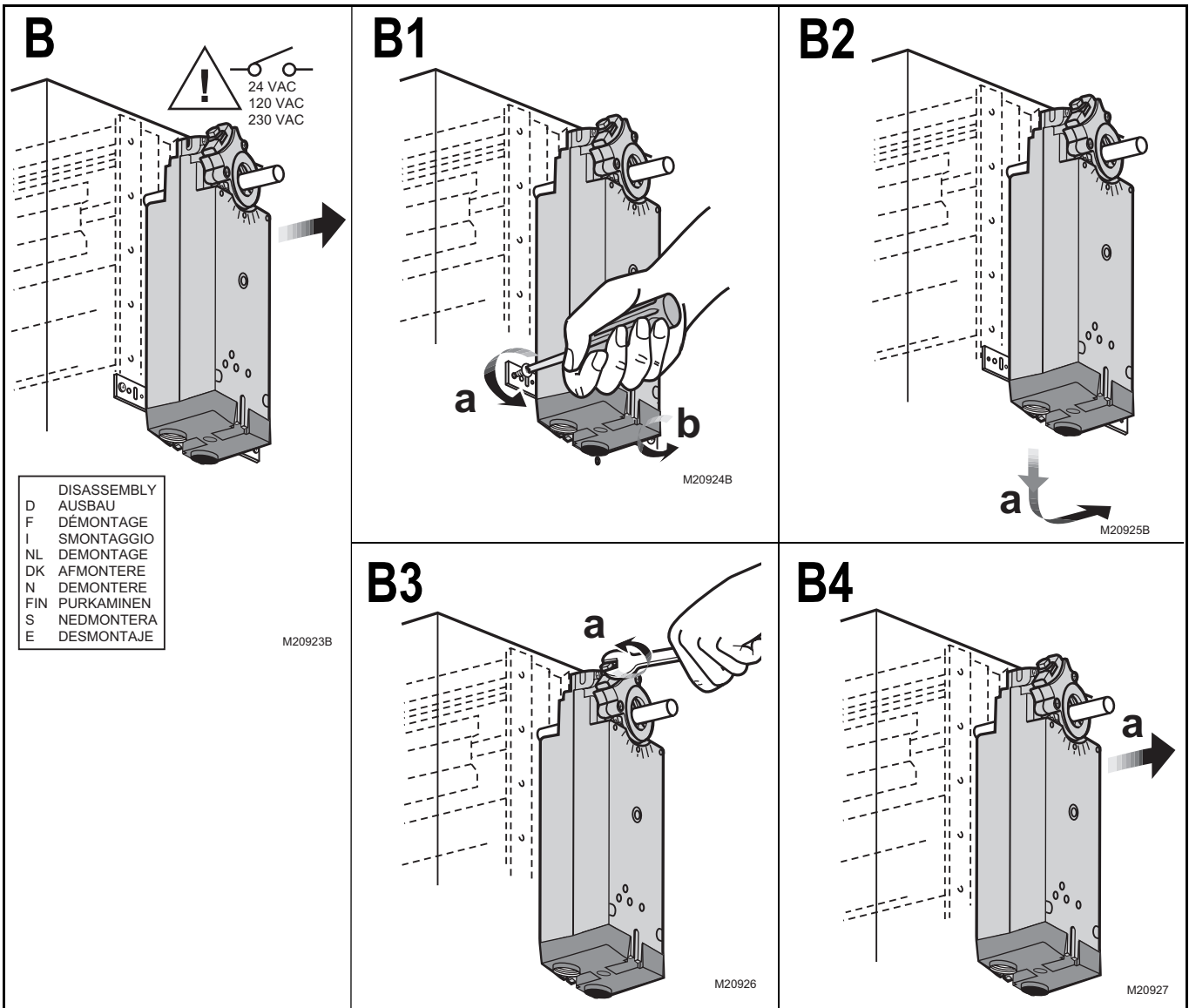

The internal auxiliary switches must be connected to the same power source, the auxiliary switches shall be connected to the same pole of the same supply circuit, connected in a same polarity manner.

Automation and Control Solutions

Honeywell International Inc.
1985 Douglas Drive North
Golden Valley, MN 55422
customer.honeywell.com

Honeywell Limited-Honeywell Limitée
35 Dynamic Drive
Toronto, Ontario M1V 4Z9



© U.S. Registered Trademark
© 2008 Honeywell International Inc.
62-0188—05 M.S. Rev. 07-08

Printed in U.S.A. on recycled paper containing at least 10% post-consumer paper fibers.