

## SPECIFICATIONS

### GENERAL SPECIFICATIONS

Working Pressure: ¼" – 2" 600 psig CWP  
 2 ½" – 4" 400 psig CWP  
 ¼" – 4" 150 psig WSP

Working Temperature: See Temperature and Pressure Chart

### FEATURES

- Full port
- Adjustable Stem Packing Nut
- Compact
- Silicone Free

### MATERIAL SPECIFICATIONS

Part Name	Material
Body	Forged Brass, UNS#C37700
Seat	Virgin PTFE
Ball	Copper Alloy, Cu>57%, Cr Plated
Stem Packing	Virgin PTFE
Nut	Corrosion Resistant Plated Steel
Stem	Brass, ASTM B16, UNS#C36000
Retainer	Forged Brass, UNS#C37700
Handle	Corrosion Resistant Plated Steel
Gland	Brass, ASTM B16, UNS#C36000

\*Forged Brass Composition: 58-61% Cu, 1.5-2.5% Pb, ≤ .30% Fe, % Rem. Zn

### DIMENSIONS (in.)

Part No.	Size	A	B	C	D	E	Wt. (Lb.)
<b>NPT</b>							
94A-101-01	¼"	0.395	1.746	1.278	3.543	-	0.33
94A-102-01	¾"	0.407	1.756	1.278	3.543	-	0.30
94A-103-01	½"	0.583	2.047	1.921	3.543	-	0.44
94A-104-01	¾"	0.748	2.362	2.087	3.780	-	0.66
94A-105-01	1"	0.945	2.756	2.559	4.528	-	1.10
94A-106-01	1 ¼"	1.260	3.307	2.953	4.528	-	1.57
94A-107-01	1 ½"	1.575	3.661	3.346	5.512	-	2.40
94A-108-01	2"	1.969	4.181	3.681	5.512	-	3.37
94A-109-01	2 ½"	2.520	5.378	4.764	8.661	-	7.60
94A-100-01	3"	2.953	6.039	5.079	8.661	-	9.36
94A-10A-01	4"	3.898	7.386	5.866	9.606	-	16.85
<b>Sweat</b>							
94A-203-01	½"	0.583	2.047	1.839	3.543	0.630	0.38
94A-204-01	¾"	0.748	2.748	1.996	3.780	0.878	0.64
94A-205-01	1"	.0945	3.228	2.441	4.528	1.130	0.99
94A-206-01	1 ¼"	1.260	3.819	2.854	4.528	1.378	1.40
94A-207-01	1 ½"	1.575	4.425	3.169	5.512	1.630	2.17
94A-208-01	2"	1.969	5.315	3.449	5.512	2.130	2.97
94A-209-01	2 ½"	2.520	6.283	4.764	8.661	2.630	6.36
94A-200-01	3"	2.953	7.150	5.079	8.661	3.130	8.32
94A-20A-01	4"	3.945	9.276	5.866	9.606	4.130	15.78

## Forged Brass Ball Valve NPT & Sweat



### APPROVALS

**CSA:** ¼"-4" NPT per ANSI Z21.15/CGA 9.1 (½ psig)  
 ¼"-4" NPT per ASME B16.44 (5 psig)  
 ½"-2" NPT per ASME B16.33 (125 psig)  
 2 ½"-4" NPT per ASME B16.38 (125 psig)

**UL:** Guides YQNZ, YRBX, YRPV and YSDT (NPT only)

**FM:** ¼" – 2" per FM1140 (<175 psig)

**NSF:** ¼" – 4" meets ANSI/NSF 61 Section 8 (61<5)

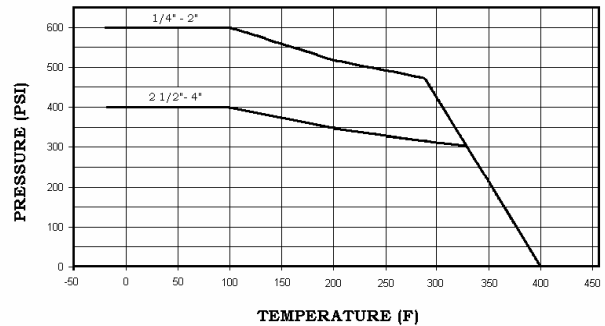

### NPT

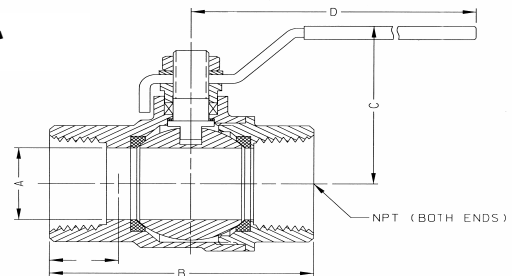

### Sweat

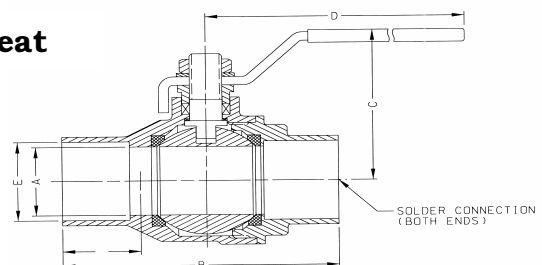

### COMMERCIAL PRODUCTS DIVISION