

## R119 Standard Regulators

**B**

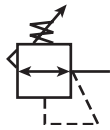

### Features

- High Flow Performance Featuring Rugged Design for the Most Demanding Applications
- Ideal for Those Installations Calling for Constant Pressure with Wide Variation in Flow
- Diaphragm Operated Design with Balanced Poppet Design for Quick and Accurate Regulation
- Secondary Aspiration Plus Balanced Poppet Provides Quick Response and Accurate Pressure Regulation
- Heavy Duty Tee Handle Adjustment
- Reverse Flow Version Available
- Panel Mount Version Available
- High Flow: 1/4" - 100 SCFM<sup>§</sup>  
 3/8" - 110 SCFM<sup>§</sup>  
 1/2" - 150 SCFM<sup>§</sup>

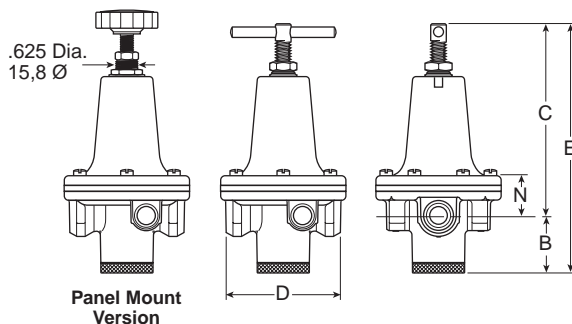
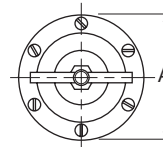
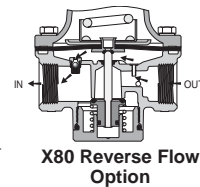

Port Size	NPT Relieving	BSPB Relieving
<b>Without Gauge 0-125 PSIG Reduced Pressure</b>		
1/4"	<b>R119-02C</b>	R119G02C
3/8"	<b>R119-03C</b>	R119G03C
1/2"	<b>R119-04C</b>	R119G04C
<b>With Gauge 0-125 PSIG Reduced Pressure</b>		
1/4"	<b>R119-02CG</b>	—
3/8"	<b>R119-03CG</b>	—
1/2"	<b>R119-04CG</b>	—

R119 Regulator Dimensions					
A	B	C	D	E	N
<b>R119-02C, R119-03C</b>					
3.00 (76)	1.38 (35)	4.60 (117)	2.74 (70.5)	5.98 (152)	0.96 (24)
<b>R119-04C</b>					
3.56 (90)	1.56 (40)	5.20 (132)	3.25 (83)	6.76 (172)	1.27 (32)

inches  
(mm)

**Bold Items are Most Popular.**

For other models refer to ordering information below.

§ SCFM = Standard cubic feet per minute at 100 PSIG inlet, 75 PSIG no flow secondary setting, and 20 PSIG pressure drop.

### Ordering Information

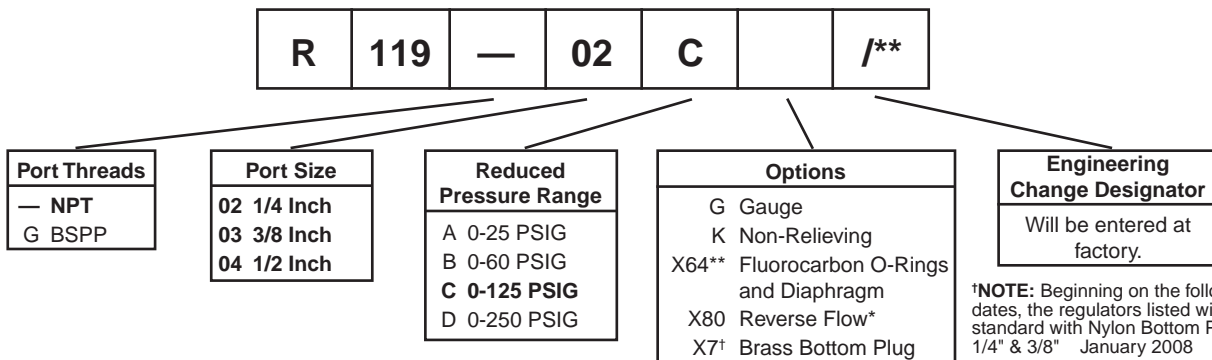

<sup>†</sup>NOTE: Beginning on the following dates, the regulators listed will come standard with Nylon Bottom Plugs.  
 1/4" & 3/8" January 2008  
 1/2" March 2008

\* Reverse flow for use downstream of control valves.

\*\* Brass Bottom Plug Standard with X64 Option.

**BOLD ITEMS ARE MOST POPULAR.**

**Technical Information**

**B**

**Flow Characteristics  
 R119-02C**

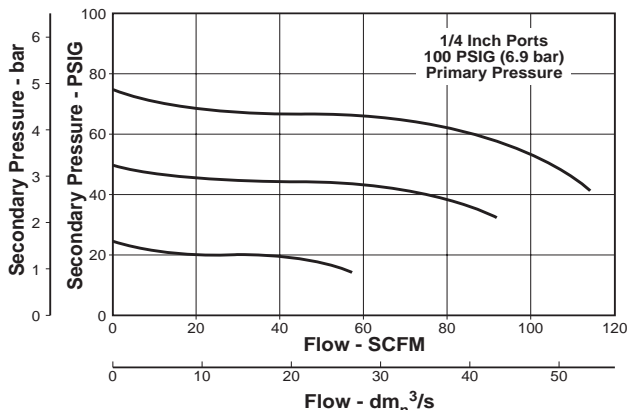

**Flow Characteristics  
 R119-03C**

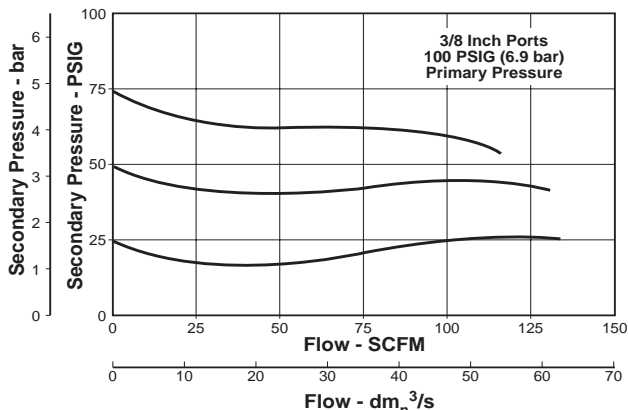

**Flow Characteristics  
 R119-04C**

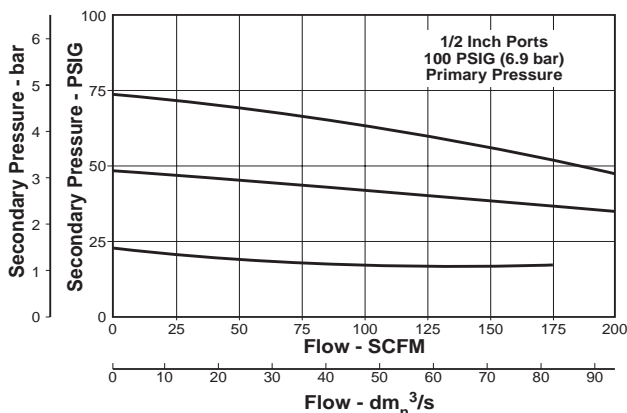

**⚠ WARNING**  
 Product rupture can cause serious injury.  
 Do not connect regulator to bottled gas.  
 Do not exceed maximum primary pressure rating.

**⚠ CAUTION:**  
**REGULATOR PRESSURE ADJUSTMENT** – The working range of knob adjustment is designed to permit outlet pressures within their full range. Pressure adjustment beyond this range is also possible because the knob is not a limiting device. This is a common characteristic of most industrial regulators, and limiting devices may be obtained only by special design. For best performance, regulated pressure should always be set by increasing the pressure up to the desired setting.

**R119 Regulator Kits & Accessories**

**Gauges –**

- 2" Dial Size, 1/4" Back Connection  
 0 to 60 PSIG (0 to 400 kPa) ..... K4520N14060
- 2" Dial Size, 1/4" Back Connection  
 0 to 160 PSIG (0 to 1100 kPa) ..... K4520N14160
- 2" Dial Size, 1/4" Back Connection  
 0 to 300 PSIG (0 to 2068 kPa) ..... K4520N14300

**Mounting Bracket Kit –**

- 1/4", 3/8" ..... SA15Y57
- 1/2" ..... 18A57

**Panel Mount Conversion Kit –**

- 1/4", 3/8" ..... 4202
- 1/2" ..... 4204

**Repair Kits –**

- Non-Relieving Diaphragm,  
 Valve Assembly (1/4", 3/8"; All PSIG) ..... RK118Y
- Relieving Diaphragm,  
 Valve Assembly (1/4", 3/8"; All PSIG) ..... RK119Y
- Non-Relieving Diaphragm,  
 Valve Assembly (1/2"; 25, 60, 125 PSIG) ..... RK118A
- Non-Relieving Diaphragm,  
 Valve Assembly (1/2"; 250 PSIG) ..... RK118A250
- Relieving Diaphragm,  
 Valve Assembly (1/2"; 25, 60, 125 PSIG) ..... RK119A

- Relieving Diaphragm,  
 Valve Assembly (1/2"; 250 PSIG) ..... RK119A250

For Fluorocarbon Repair Kits, add X64 to Kit Number suffix.

**Specifications**

- Gauge Ports (2)** ..... 1/4 Inch
- Port Threads** ..... 1/4, 3/8, 1/2 Inch
- Reduced Pressure Range** ..... 2 to 125 PSIG (0.15 to 8.5 bar)
- Supply Pressure** ..... 300 PSIG Maximum (20.4 bar)
- Temperature Rating** ..... 40°F to 125°F (4.4°C to 52°C)
- Weight –**
- R119-02, R119-03 ..... 1.8 lb. (0.82 kg) / Unit  
 26 lb. (11.79 kg) / 12-Unit Master Pack
- R119-04 ..... 3.2 lb. (1.45 kg) / Unit  
 27 lb. (12.25 kg) / 8-Unit Master Pack

**Materials of Construction**

- Adjusting Screw, Springs** ..... Steel
- Body, Spring Cage** ..... Zinc
- Bottom Plug** ..... Nylon
- Innervalve** ..... Brass
- Seals** ..... Buna N



## R119 Standard Regulators

**B**



### Features

- High Flow Performance Featuring Rugged Design for the Most Demanding Applications
- Ideal for Those Installations Calling for Constant Pressure with Wide Variation in Flow
- Diaphragm Operated Design with Balanced Poppet Design for Quick and Accurate Regulation
- Secondary Aspiration Plus Balanced Poppet Provides Quick Response and Accurate Pressure Regulation
- Heavy Duty Tee Handle Adjustment
- Reverse Flow Version Available
- High Flow: 3/4" - 300 SCFM<sup>§</sup>  
 1" - 400 SCFM<sup>§</sup>  
 1-1/4" & 1-1/2" - 500 SCFM<sup>§</sup>

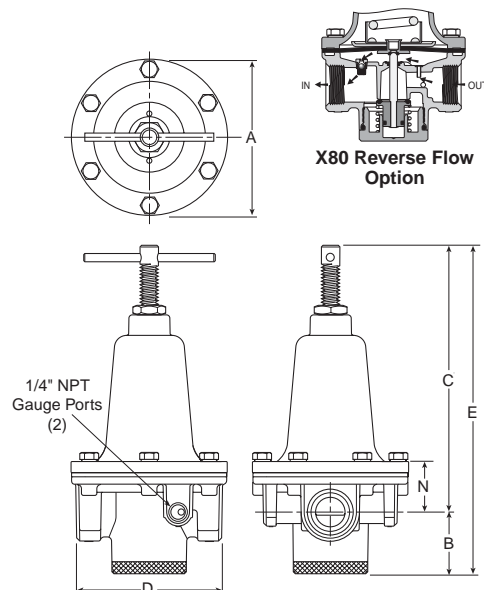

Port Size	NPT Relieving	BSPP Relieving
<b>Without Gauge 0-125 PSIG Reduced Pressure</b>		
3/4"	<b>R119-06C</b>	R119G06C
1"	<b>R119-08C</b>	R119G08C
1-1/4"	<b>R119-10C</b>	R119G10C
1-1/2"	<b>R119-12C</b>	R119G12C
<b>With Gauge 0-125 PSIG Reduced Pressure</b>		
3/4"	<b>R119-06CG</b>	—
1"	<b>R119-08CG</b>	—
1-1/4"	<b>R119-10CG</b>	—
1-1/2"	<b>R119-12CG</b>	—

R119 Regulator Dimensions					
A	B	C	D	E	N
<b>R119-06C, R119-08C</b>					
4.69 (119)	1.87 (47)	8.15 (207)	4.38 (111)	10.02 (255)	1.61 (41)
<b>R119-10C, R119-12C</b>					
4.94 (125)	1.81 (46)	8.53 (217)	4.94 (125)	10.34 (263)	1.99 (50.6)

inches  
(mm)

**Bold Items are Most Popular.**  
 For other models refer to ordering information below.

§ SCFM = Standard cubic feet per minute at 100 PSIG inlet, 75 PSIG no flow secondary setting, and 20 PSIG pressure drop.

**⚠ WARNING**  
 Do not connect regulator to bottled gas.  
 Do not exceed maximum primary pressure rating.  
 Product rupture can cause serious injury.

### Ordering Information

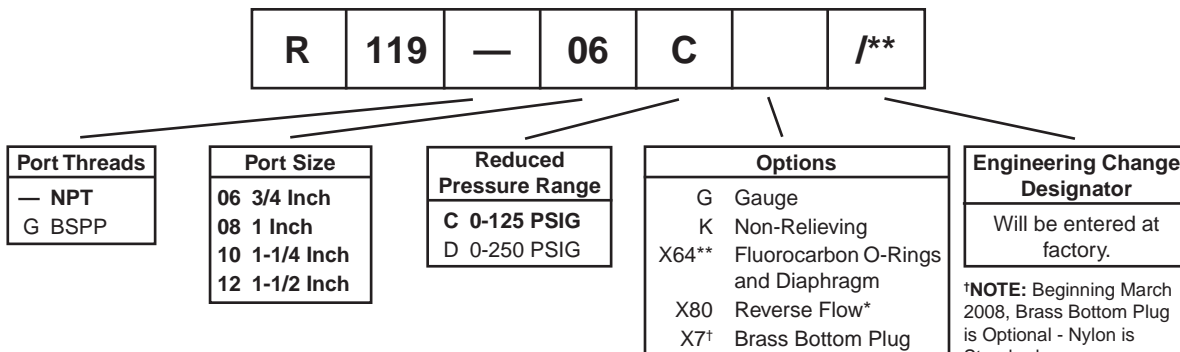

\* Reverse flow for use downstream of control valves.

**\*NOTE:** Beginning March 2008, Brass Bottom Plug is Optional - Nylon is Standard.

\*\* Brass Bottom Plug Standard with X64 Option.

**BOLD ITEMS ARE MOST POPULAR.**



**Technical Information**

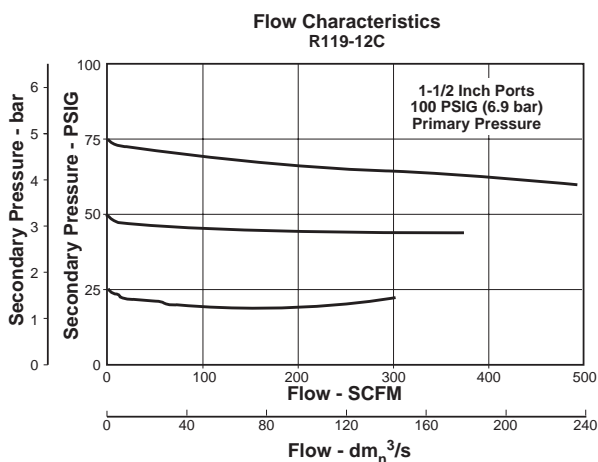
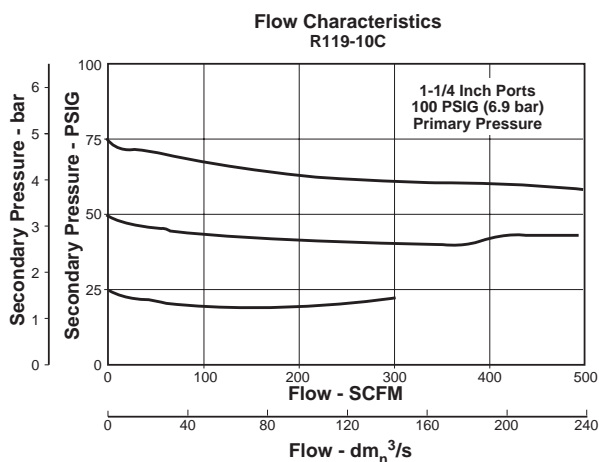
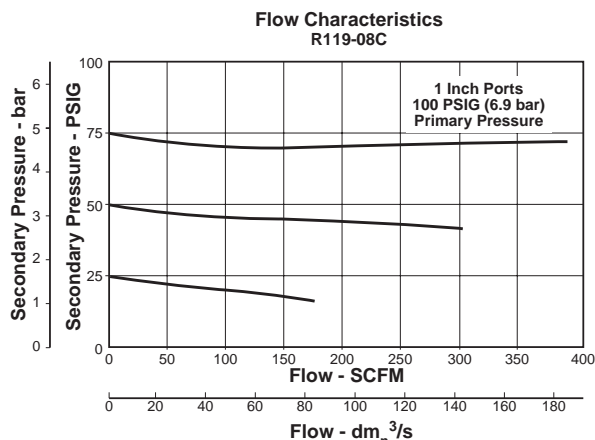
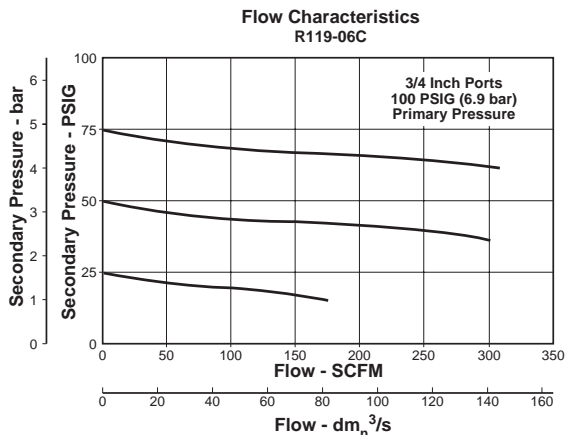

**CAUTION:**  
**REGULATOR PRESSURE ADJUSTMENT** – The working range of knob adjustment is designed to permit outlet pressures within their full range. Pressure adjustment beyond this range is also possible because the knob is not a limiting device. This is a common characteristic of most industrial regulators, and limiting devices may be obtained only by special design. For best performance, regulated pressure should always be set by increasing the pressure up to the desired setting.

**R119 Regulator Kits & Accessories**

- Gauges –**  
 2" Dial Size, 1/4" Back Connection  
 0 to 60 PSIG (0 to 400 kPa) ..... K4520N14060  
 2" Dial Size, 1/4" Back Connection  
 0 to 160 PSIG (0 to 1100 kPa) ..... K4520N14160  
 2" Dial Size, 1/4" Back Connection  
 0 to 300 PSIG (0 to 2068 kPa) ..... K4520N14300
- Mounting Bracket Kit** ..... 18B57
- Repair Kits –**  
 Non-Relieving Diaphragm,  
 Valve Assembly (3/4", 1") ..... RK118B  
 Non-Relieving Diaphragm,  
 Valve Assembly (1-1/4", 1-1/2") ..... RK118D  
 Relieving Diaphragm,  
 Valve Assembly (3/4", 1") ..... RK119B  
 Relieving Diaphragm,  
 Valve Assembly (1-1/4", 1-1/2") ..... RK119D

For Fluorocarbon Repair Kits, add X64 to Kit Number suffix.

**Specifications**

- Gauge Ports (2)** ..... 1/4 Inch  
**Port Threads** ..... 3/4, 1, 1-1/4, 1-1/2 Inch  
**Reduced Pressure Range** ..... 2 to 125 PSIG (0.15 to 8.5 bar)  
**Supply Pressure** ..... 300 PSIG Maximum (20.4 bar)  
**Temperature Rating** ..... 40°F to 125°F (4.4°C to 52°C)
- Weight –**  
 R119-06, R119-08 ..... 6.2 lb. (2.81 kg) / Unit  
 25 lb. (11.34 kg) / 4-Unit Master Pack  
 R119-10, R119-12 ..... 7.2 lb. (3.27 kg) / Unit  
 29 lb. (13.15 kg) / 4-Unit Master Pack

**Materials of Construction**

- Adjusting Screw, Springs** ..... Steel  
**Body, Spring Cage** ..... Zinc  
**Bottom Plug** ..... Nylon  
**Innervalve** ..... Brass  
**Seals** ..... Buna N



## R119 Pilot Operated Regulators

**B**

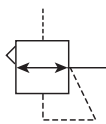

### Features

- Adapted for Control by a Remote or Distant Small Pilot Regulator. Ideal for Maximum Capacity Requirements in Applications where Units are Not Readily Accessible
- High Flow Performance Featuring Rugged Design for the Most Demanding Applications
- Ideal for Those Installations Calling for Constant Pressure with Wide Variation in Flow
- Diaphragm Operated Design with Balanced Poppet and Constant Bleed Pilot for Quick and Accurate Regulation.
- Secondary Aspiration Plus Balanced Poppet Provides Quick Response and Accurate Pressure Regulation
- Reverse Flow Available
- High Flow: 1/4" - 100 SCFM<sup>§</sup>  
 3/8" - 110 SCFM<sup>§</sup>  
 1/2" - 150 SCFM<sup>§</sup>

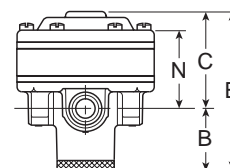
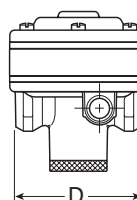
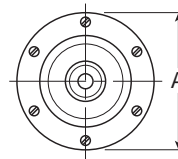

Port Size	NPT Relieving	BSPP Relieving
<b>Without Gauge 0-125 PSIG Reduced Pressure</b>		
1/4"	<b>R119-02J</b>	R119G02J
3/8"	<b>R119-03J</b>	R119G03J
1/2"	<b>R119-04J</b>	R119G04J

R119 Regulator Dimensions					
A	B	C	D	E	N
<b>R119-02J, R119-03J</b>					
3.00 (76)	1.38 (35)	2.10 (53)	2.74 (70)	3.48 (88)	1.69 (43)
<b>R119-04J</b>					
3.56 (90)	1.56 (40)	2.31 (59)	3.34 (85)	3.87 (98)	1.93 (49)

**Bold Items are Most Popular.**

For other models refer to ordering information below.

§ SCFM = Standard cubic feet per minute at 100 PSIG inlet, 75 PSIG no flow secondary setting, and 20 PSIG pressure drop.

inches  
(mm)

**⚠ WARNING**  
 Do not connect regulator to bottled gas.  
 Do not exceed maximum primary pressure rating.  
 Product rupture can cause serious injury.

### Ordering Information

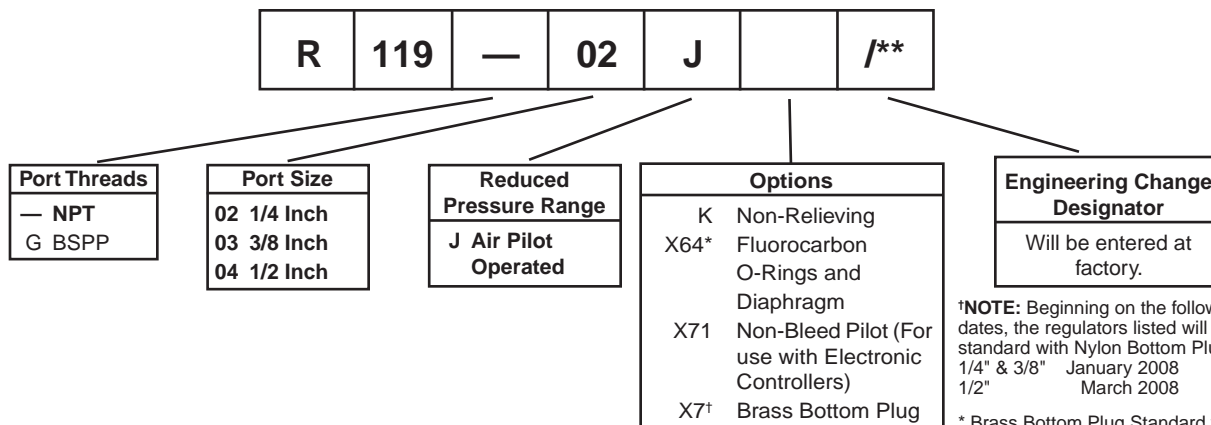

**BOLD ITEMS ARE MOST POPULAR.**

**Technical Information**

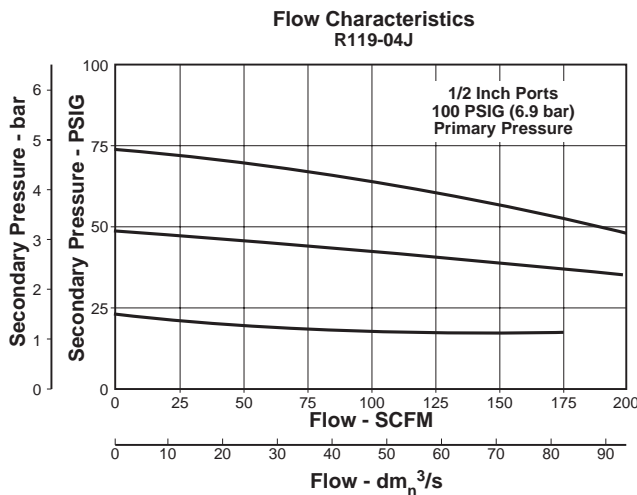
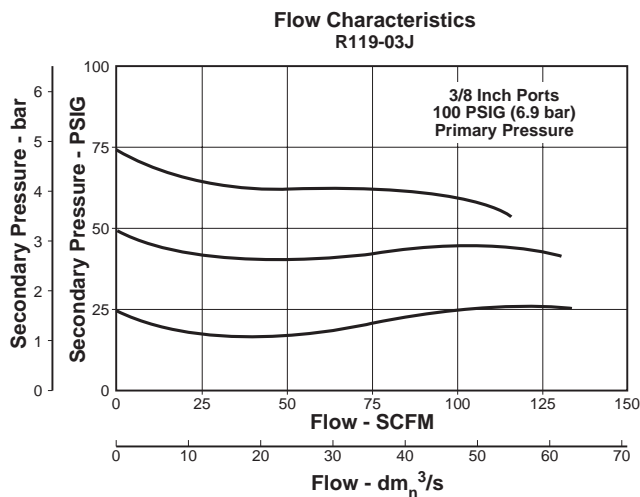
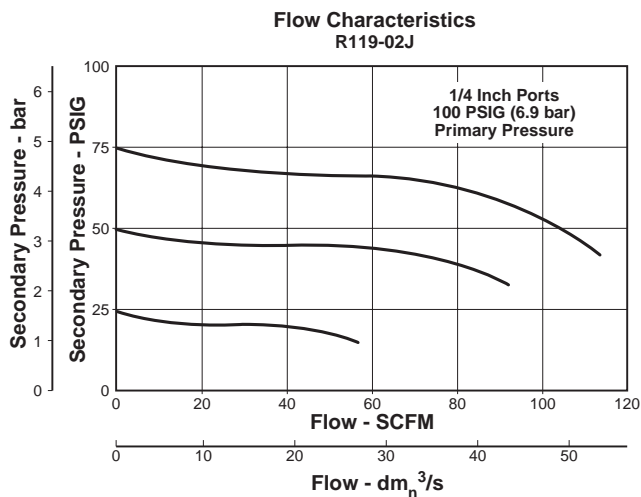

**R119 Regulator Kits & Accessories**

**Gauges –**

- 2" Dial Size, 1/4" Back Connection  
0 to 60 PSIG (0 to 400 kPa) ..... K4520N14060
- 2" Dial Size, 1/4" Back Connection  
0 to 160 PSIG (0 to 1100 kPa) ..... K4520N14160
- 2" Dial Size, 1/4" Back Connection  
0 to 300 PSIG (0 to 2068 kPa) ..... K4520N14300

**Repair Kits –**

- Non-Relieving Diaphragm,  
Valve Assembly (1/2") .....RK118X20A
- Non-Relieving Diaphragm,  
Valve Assembly (1/4", 3/8") .....RK118X20Y
- Relieving Diaphragm,  
Valve Assembly (1/2") .....RK119X20A
- Relieving Diaphragm,  
Valve Assembly (1/4", 3/8") .....RK119X20Y

For Fluorocarbon Repair Kits, add X64 to Kit Number suffix.

**Specifications**

- Gauge Ports (2)** ..... 1/4 Inch
- Port Threads** ..... 1/4, 3/8, 1/2 Inch
- Reduced Pressure Range –**  
Adjustable to within 5 to 7 PSIG of Supply Pressure
- Supply Pressure** ..... 300 PSIG Maximum (20.4 bar)
- Air Consumption –**  
Constant bleed from air pilot chamber: approx. 0.17 SCFM (10 SCFH)
- Temperature Rating** ..... 40°F to 125°F (4.4°C to 52°C)
- Weight –**  
R119-02J, R119-03J ..... 1.6 lb. (0.73 kg) / Unit  
19 lb. (8.62 kg) / 12-Unit Master Pack  
R119-04J ..... 2.6 lb. (1.18 kg) / Unit  
21 lb. (9.53 kg) / 8-Unit Master Pack

**Materials of Construction**

- Body, Ring, Top Plate** ..... Zinc
- Bottom Plug** ..... Nylon
- Innervalve** ..... Brass
- Seals** ..... Buna N



## R119 Pilot Operated Regulators

**B**

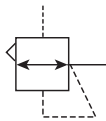

### Features

- Adapted for Control by a Remote or Distant Small Pilot Regulator. Ideal for Maximum Capacity Requirements in Applications where Units are Not Readily Accessible
- High Flow Performance Featuring Rugged Design for the Most Demanding Applications
- Ideal for Those Installations Calling for Constant Pressure with Wide Variation in Flow
- Diaphragm Operated Design with Balanced Poppet and Constant Bleed Pilot for Quick and Accurate Regulation.
- Secondary Aspiration Plus Balanced Poppet Provides Quick Response and Accurate Pressure Regulation
- Reverse Flow Version Available
- High Flow: 3/4", 1" - 300 SCFM<sup>§</sup>,  
 1-1/4" & 1-1/2" - 380+ SCFM<sup>§</sup>

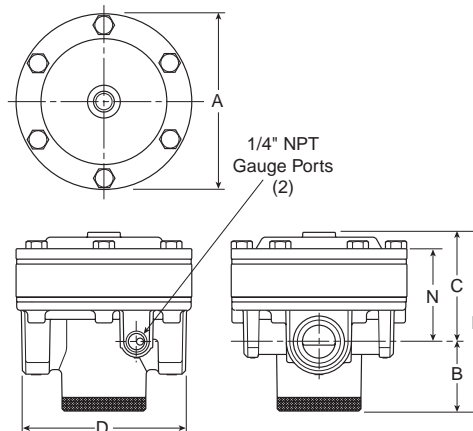

Port Size	NPT Relieving	BSPP Relieving
<b>Without Gauge 0-125 PSIG Reduced Pressure</b>		
3/4"	<b>R119-06J</b>	R119G06J
1"	<b>R119-08J</b>	R119G08J
1-1/4"	<b>R119-10J</b>	R119G10J
1-1/2"	<b>R119-12J</b>	R119G12J

R119 Regulator Dimensions					
A	B	C	D	E	N
<b>R119-06J, R119-08J</b>					
4.72 (120)	1.87 (47)	2.94 (75)	4.38 (111)	4.81 (122)	2.47 (63)
<b>R119-10J, R119-12J</b>					
4.94 (125)	1.81 (46)	3.32 (84)	4.94 (125)	5.13 (130)	2.88 (73)

inches  
(mm)

**Bold Items are Most Popular.**

For other models refer to ordering information below.

§ SCFM = Standard cubic feet per minute at 100 PSIG inlet, 75 PSIG no flow secondary setting, and 20 PSIG pressure drop.

**⚠ WARNING**  
 Do not connect regulator to bottled gas.  
 Do not exceed maximum primary pressure rating.  
 Product rupture can cause serious injury.

### Ordering Information

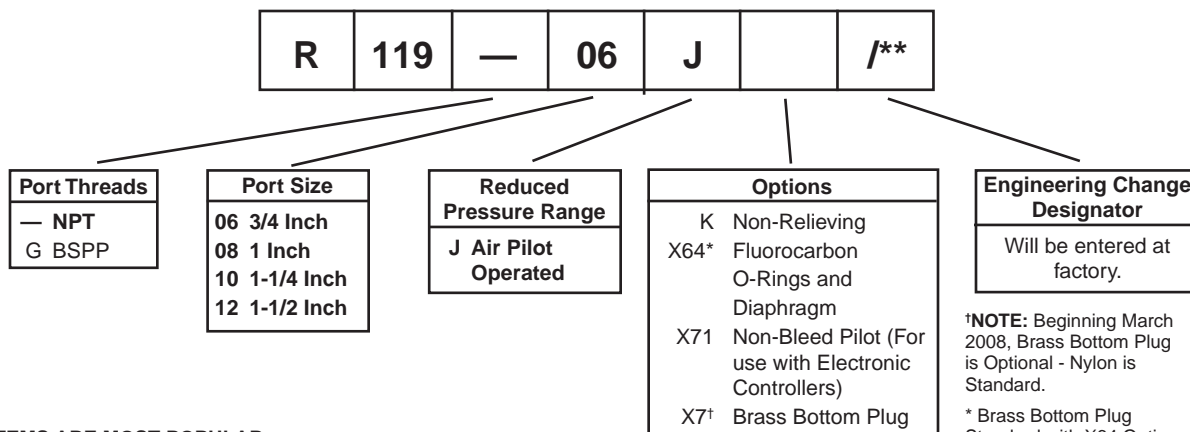

**BOLD ITEMS ARE MOST POPULAR.**

**Technical Information**

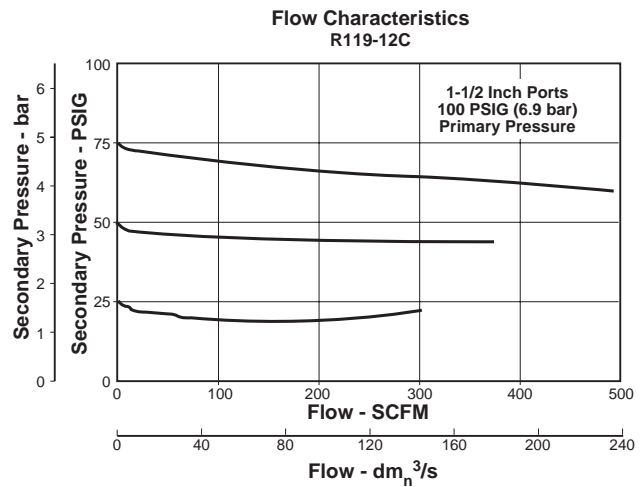
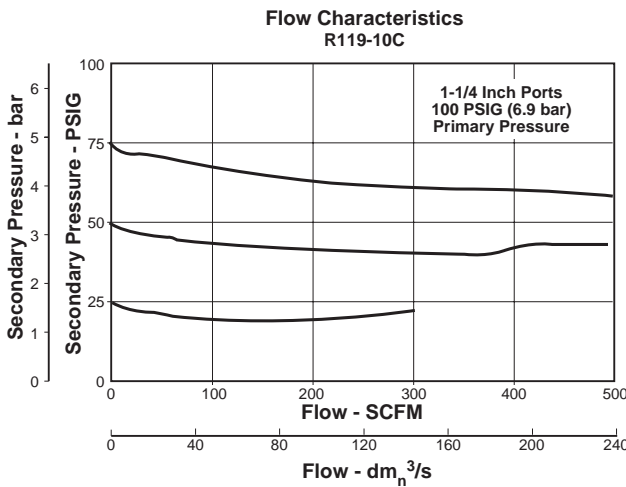
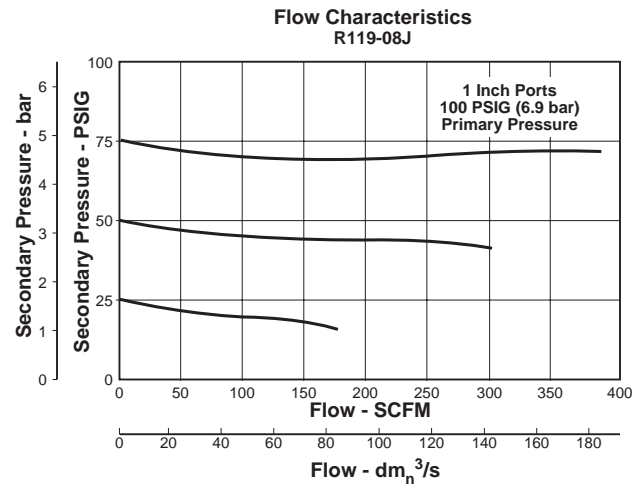
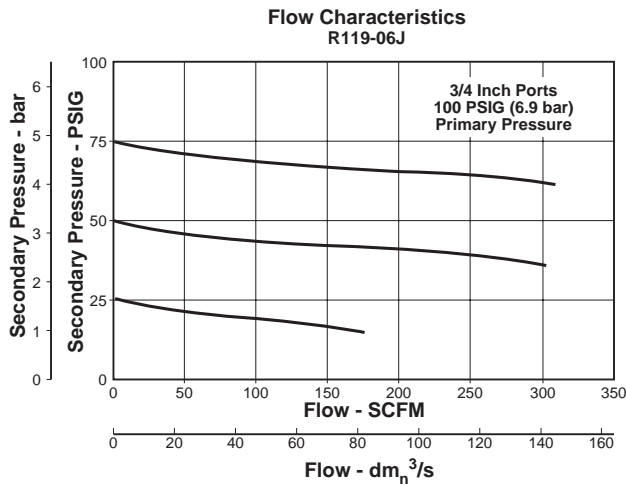

**R119 Regulator Kits & Accessories**

**Gauges –**

- 2" Dial Size, 1/4" Back Connection  
0 to 60 PSIG (0 to 400 kPa) ..... K4520N14060
- 2" Dial Size, 1/4" Back Connection  
0 to 160 PSIG (0 to 1100 kPa) ..... K4520N14160
- 2" Dial Size, 1/4" Back Connection  
0 to 300 PSIG (0 to 2068 kPa) ..... K4520N14300

**Repair Kits –**

- Non-Relieving Diaphragm,  
Valve Assembly (3/4", 1") .....RK118X20B
- Non-Relieving Diaphragm,  
Valve Assembly (1-1/4", 1-1/2") ..... RK118X20D
- Relieving Diaphragm,  
Valve Assembly (3/4", 1") .....RK119X20B
- Relieving Diaphragm,  
Valve Assembly (1-1/4", 1-1/2") ..... RK119X20D

For Fluorocarbon Repair Kits, add X64 to Kit Number suffix.

**Specifications**

- Gauge Ports (2)** .....1/4 Inch
- Port Threads** ..... 3/4, 1, 1-1/4, 1-1/2 Inch
- Reduced Pressure Range –**  
Adjustable to Within 5 to 7 PSIG of Supply Pressure
- Supply Pressure** .....300 PSIG Maximum (20.4 bar)
- Air Consumption –**  
Constant bleed from air pilot chamber: approx 0.17 SCFM (10 SCFH)
- Temperature Rating** .....40°F to 125°F (4.4°C to 52°C)
- Weight –**  
R119-06J, R119-08J ..... 5.2 lb. (2.36 kg) / Unit  
42 lb. (19.05 kg) / 8-Unit Master Pack  
R119-10J, R119-12J ..... 5.6 lb. (2.54 kg) / Unit  
46 lb. (20.87 kg) / 8-Unit Master Pack

**Materials of Construction**

- Body, Ring, Top Plate** .....Zinc
- Bottom Plug** ..... Nylon
- Innervalve** ..... Brass
- Seals** ..... Buna N





## R119 Pilot Operated Regulators

**B**

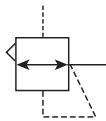

### Features

- Adapted for Control by a Remote or Distant Small Pilot Regulator. Ideal for Maximum Capacity Requirements in Applications where Units are Not Readily Accessible
- High Flow Performance Featuring Rugged Design for the Most Demanding Applications
- Ideal for Those Installations Calling for Constant Pressure with Wide Variation in Flow
- Piston Operated Design with Balanced Poppet and Dual Constant Bleed for Quick and Accurate Regulation
- High Flow: 2" & 2-1/2" - 1500+ SCFM<sup>§</sup>

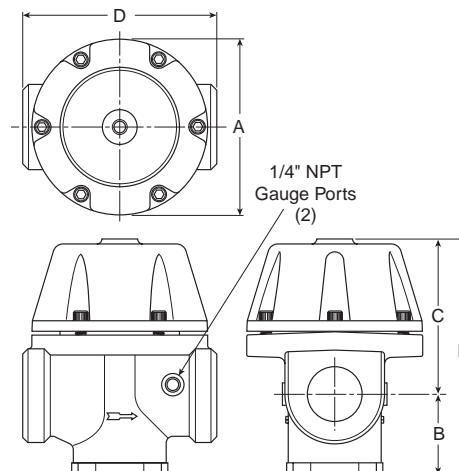

Port Size	NPT Relieving	BSPP Relieving
<b>Without Gauge 0-125 PSIG Reduced Pressure</b>		
2"	<b>R119-16J</b>	R119G16J
2-1/2"	<b>R119-20J</b>	R119G20J

R119 Regulator Dimensions				
A	B	C	D	E
<b>R119-16J, R119-20J</b>				
6.63 (168)	3.09 (79)	7.78 (147)	7.31 (185)	10.87 (276)

inches  
(mm)

**Bold Items are Most Popular.**

For other models refer to ordering information below.

§ SCFM = Standard cubic feet per minute at 100 PSIG inlet, 75 PSIG no flow secondary setting, and 20 PSIG pressure drop.

**⚠ WARNING**  
 Do not connect regulator to bottled gas.  
 Do not exceed maximum primary pressure rating.  
 Product rupture can cause serious injury.

### Ordering Information

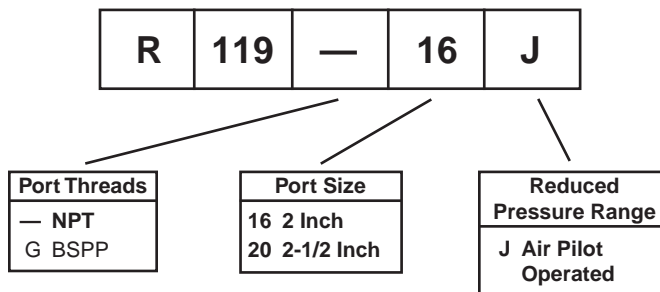

NOTE: Non-Relieving Not Available.

**BOLD ITEMS ARE MOST POPULAR.**

**Technical Information**

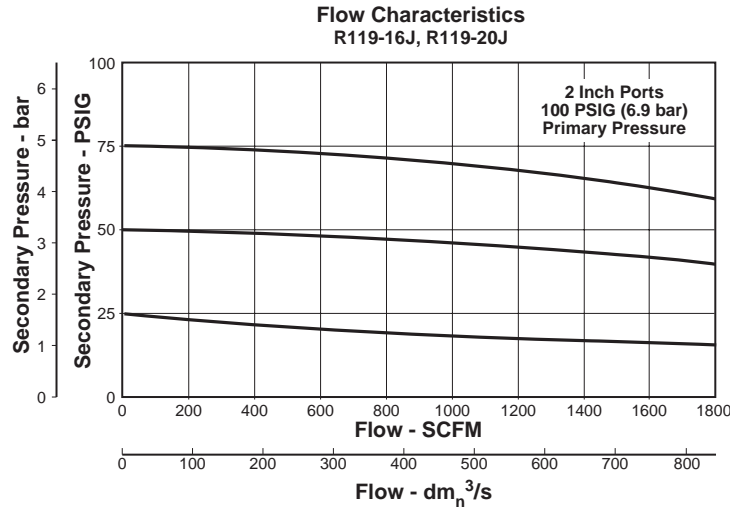

**R119 Regulator Kits & Accessories**

- Gauges –**  
2" Dial Size, 1/4" Back Connection  
0 to 60 PSIG (0 to 400 kPa) ..... K4520N14060  
2" Dial Size, 1/4" Back Connection  
0 to 160 PSIG (0 to 1100 kPa) ..... K4520N14160  
2" Dial Size, 1/4" Back Connection  
0 to 300 PSIG (0 to 2068 kPa) ..... K4520N14300
- Repair Kits –**  
Piston Type Regulation (2", 2-1/2") .....RK119G

**Specifications**

- Gauge Ports (2)** ..... 1/4 Inch  
(Can be used for Full Flow)  
High Pressure Outlet for Pilot (Not seen in photo) ..... 1/4 Inch
- Port Threads** ..... 2, 2-1/2 Inch
- Reduced Pressure Range –**  
Adjustable to Within 5 to 7 PSIG of Supply Pressure
- Supply Pressure** ..... 300 PSIG Maximum (20.4 bar)
- Air Consumption –**  
Constant Bleed from Air Pilot Chamber:  
Approx. 0.17 SCFM (10 SCFH)  
Constant Bleed from Reduced Pressure:  
Approx. 0.17 SCFM (10 SCFH)
- Temperature Rating** ..... 40°F to 125°F (4.4°C to 52°C)
- Weight –**  
R119-16J, R119-20J ..... 11 lb. (4.99 kg) / Unit  
12 lb. (5.44 kg) / 1-Unit Master Pack

**Materials of Construction**

- Body, Piston** ..... Aluminum  
**Seals** ..... Buna N  
**Innervalue** ..... Brass & Stainless