

21/29 Frame Replacement Motor 5.0" Diameter, Open Drip-Proof, Air Over



APPLICATIONS:

Designed to replace most original 21 and 29 frame GE® motors.

FEATURES:

- Four Motors Replace Most Original 21 Frame GE® Motors (see below)
- P in Catalog Number Indicates Permanent Split Capacitor, Capacitor Included
- Self Aligning Bearings
- Holes Provided for Attaching a BX Connector
- Resilient Hub Rings, 2 1/4" Diameter
- Rotation CCW Lead End Except 1468P
- 30" Leads
- Dual Voltage Easily Changed by Quick Connects
- Class B Insulation
- 3/8" Diameter Shafts with 1/2" Adapters
- Extended Thru-bolts
- Automatic Reset Thermal Overload Protector
- Mounting Bracket Provided at Shaft End
- Can be Moved on Extended-Thru Bolts to Fit Most Existing Bases
- Has Mounting Holes and Bolts to Match 21 Frame Bolt Circle for Stud Mounting
- Can be Resilient Mounted, Band Mounted or End Mounted

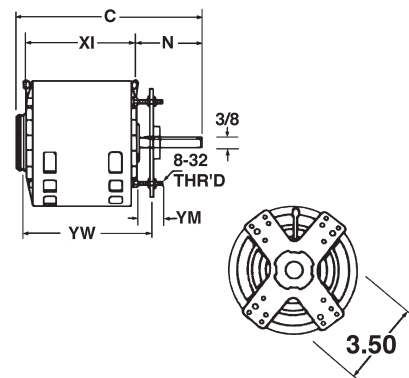

Hub Mount Bracket (2-1/4") Single Speed

HP	RPM	Voltage	Catalog Number	Bearings	Amps	Shaft N	Shaft Dia.	Shell XI	Total C	Stud YM	Max. Ext. YW	Ship Wt.	Notes
1/20	1550	115/208-230	1468P	SAB	1.1/0.5	3.3	0.375	3.3	7.1	1.5	5.6	7	H20
1/15	1550	115/208-230	1469P	SAB	1.3/0.7	3.5	0.375	3.3	7.4	1.5	5.8	7	
1/10	1550	115/208-230	1470P	SAB	1.7/0.9	3.5	0.375	3.6	7.6	1.5	6.1	7	
	1050	115/208-230	1471P	SAB	1.7/0.8	3.3	0.375	3.8	7.6	1.5	6.1	7	

Replacement Cross Reference

Catalog Number	GE Number
1468P	DG3001, DG3002, DG3003, DG3004, DG3021, DG3022, DG3023, DG3024
1469P	FG3101, FG3102, FG3103, FG3104, FG3121, FG3122, FG3123, FG3124
1470P	HG3201, HG3202, HG3203, HG3204, HG3221, HG3222, HG3223, HG3224
1471P	HG3253, HG3254, HG3275, HG3263, HG3264

FEATURES:

- P in Catalog Number Indicates Permanent Split Capacitor, Capacitor Included
- 36" Leads
- CWLE Rotation
- Bearings have All Angle Thrust System
- BX Connector
- Class B Insulation
- Continuous Duty, Air Over
- Automatic Reset Thermal Overload Protector
- Connection Instructions Included in Nameplate Data
- Green Ground Lead

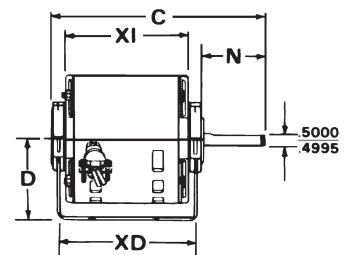

Resilient Base Single Speed

HP	RPM	Voltage	Catalog Number	Bearings	Frame	Amps	Shaft N	Shell XD	Shell XI	Total C	D	Ship Wt.	Notes
1/10	1550	115/230	721P	SAB	42Y	2.7/1.4	2.4	3.9	3.3	6.9	2.6	9	
1/6	1550	115/230	722P	SAB	42Z	2.4/1.2	2.4	4.4	3.8	7.4	2.6	11	

5.0" Diameter, Double Shaft

HP	RPM/Spds	Voltage	Catalog Number	Bearings	NEMA Frame	Cap. MFD	Amps	Shaft N	Shaft XN	Shell XI	Total C	Shaft Diameter	Ship Wt.	Notes
1/20	1075/4	115	1270*	BALL	42Y	5	0.9	10.1	10.1	4.3	25.6	0.500	8.0	
1/15	1050/3	208-230	1261*	SAB	42Y	3	0.5	8.3	8.3	4.6	22.2	0.500	7.8	
1/10	1050/5	115	2832*	SAB	42Y	5	2.5	10.0	10.0	4.3	24.3	0.500	7.1	
1/8	1550/4	115	1180	BALL	42Y	5	2.0	10.2	10.2	3.6	24.0	0.500	7.1	

* Includes Resilient Base and Mounted Capacitor

Note H20: Rotation CWLE

† All marks shown within this document are properties of their respective owners.

