

INTERMATIC®

MEETS NEC 2014 SECTION 408.9 (B1) REQUIREMENTS FOR
EXTRA DUTY AND WET LOCATIONS WHEN COVER IS CLOSED

Weatherproof Covers

Our durable line-up of Die-Cast and Plastic Weatherproof Covers offers long-lasting protection in all types of rugged applications: industrial, commercial, manufacturing, residential, and more! Time-saving features and resilient construction make these weatherproof covers the most versatile around.

Stay compliant 2014 NEC Article 406.9 (B)(1) Intermatic Extra-Duty Weatherproof Covers meet or exceed the latest NEC requirements for extra-duty applications and wet locations.

- For the 2014 NEC, all 15 and 20 A, 125 and 250 VAC receptacles installed in a wet location still must have enclosures and covers that are weatherproof, whether an attachment plug cap is inserted or not.
- A revision now requires all enclosures and covers installed in wet locations for 15 and 20 A, 125 and 250 VAC receptacles to be Listed, and of the "extra duty" type, not just boxes supported from grade.
- This requirement is enforced at dwelling units as well. The requirement for weather-resistant type receptacles in wet locations is still applicable in the 2014 NEC. This also applies to Article 590.4(D)(2) for extra-duty covers for all 15 and 20 A, 125 and 250 VAC receptacles installed in temporary installations in a wet location.
- Exceeds CEC Article 26-702.

Contents

| | |
|--|---------|
| Accessories and Outlet Post..... | 122 |
| Extra-Duty Die-Cast In-Use Covers..... | 123 |
| Extra-Duty Plastic In-Use Covers | 124-125 |
| Plastic In-Use Covers | 126-129 |

Weatherproof Covers

Accessories and Outlet Post

Weatherproof Covers

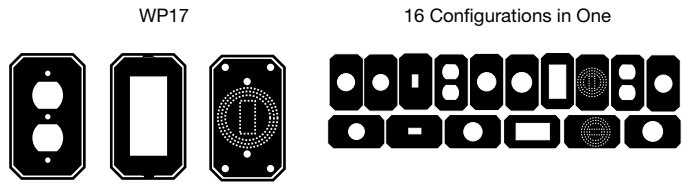

WP17

16 Configurations in One

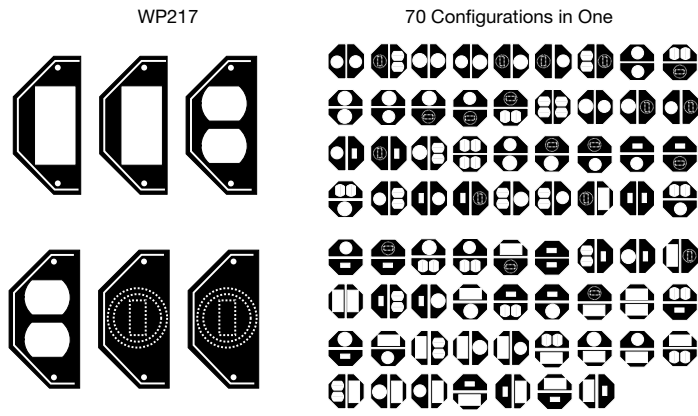

WP217

70 Configurations in One

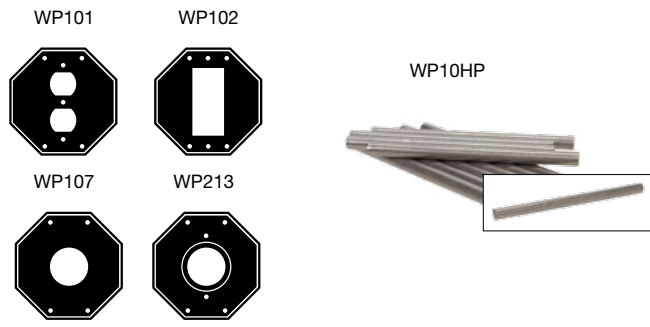

WP101

WP102

WP10HP

WP107

WP213

Single and Double-Gang Inserts

For Weatherproof Covers

These Flexi-Guard Inserts fit single-gang or double-gang models of all plastic, extra-duty plastic, and extra-duty die-cast models. Each insert package can be purchased separately. All weatherproof covers come with inserts, mounting screws, gasket, base, and cover assembly.

Applications

- Industrial • Commercial • Manufacturing • Residential
- Agricultural • Signage • Athletic fields

WP17 Single-Gang Insert Features

- Standard in all single-gang covers
- Three inserts - 16 possible configurations
- Converts to either toggle or round receptacle sizes: 1 3/8" (35 mm), 1 5/8" (41 mm), 1 7/8" (48 mm) or 2 1/8" (54 mm)

WP217 Double-Gang Insert Features

- Standard in all double-gang covers
- Six inserts - 70 possible configurations
- Converts to either toggle or round receptacle sizes: 1 3/8" (35 mm) or 1 5/8" (41 mm)



| Model # | Type | Description |
|---------|-------------|--|
| WP17 | Single-Gang | 16 Configurations in 1 |
| WP217 | Double-Gang | 70 Configurations in 1 |
| WP101 | Double-Gang | Duplex |
| WP102 | Double-Gang | GFCI |
| WP107 | Double-Gang | Round 1 3/8", 1 5/8", 1 3/4" (35 mm, 41 mm, 44 mm) |
| WP213 | Double-Gang | Round 2 1/8", 2 5/8" (55 mm, 67 mm) |
| WP10HP | — | Hinge Pin (10-pc) |

Single-Gang Outlet Post

The WP2000 Flexi-Guard Outlet post provides a solution for supplying power to gardens and other areas. Remote mounted energy saving photocontrols, timers, or photocontrol and timer combinations are also available to activate area lighting.

Applications

- Residential • Landscaping

Features

- Complies with 2014 NEC Article 314.15 for damp and wet locations
- Exceeds CEC Article 26-702
- UL Certified for Type 3R outdoor enclosures
- Meets requirements for cold impact testing: -60° F (-51° C)
- Heavy-duty UV stabilized polycarbonate cover, mounting base and inserts
- Lockable hasp: Accepts up to 1/4" (6 mm) dia shank
- Single-gang inserts provided for GFCI, duplex, toggle or round receptacles 1 3/8" (35 mm), 1 5/8" (41 mm), 1 7/8" (48 mm), or 2 1/8" (54 mm)
- Max cord size: (2) #12 AWG or higher
- Provisions for installing mechanical or digital timers (sold separately) to control area lighting:
 - PB913N84: 24-hour, 120 V mechanical timer – allows for 2 ON/OFF daily cycles
 - PB313EK: 24-hour, 120 V electronic timer – allows for 8 ON/OFF daily cycles
- Provisions for fixed-position, stem-mounting, and stem & swivel mounting photocontrols for area lighting
- All ports accept 1/2" (13 mm), 3/4" (19 mm), or 1" (25 mm) PVC conduit (adapters included)
- Base includes mounting holes and template for optional concrete/pavement mounting
- Warranty: 1-year limited



WP2000

Dimensions

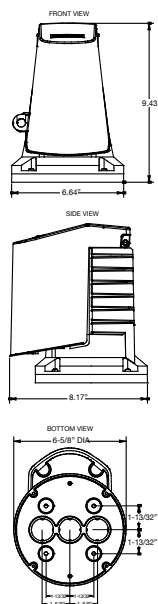

| Model # | Depth | Hinge | Flexi-Guard Inserts | Color |
|---------|----------------|----------|---------------------|-------|
| WP2000 | 2 1/2" (64 mm) | Vertical | WP17 | Green |

Extra-Duty Die-Cast In-Use Weatherproof Covers

Single and Double-Gang Models

Die-Cast In-Use Aluminum Weatherproof Covers are extra-duty rated and easy to install. Heavy-duty die-cast aluminum construction ensures long-lasting durability. Covers come with an adhered gasket, mounting screws, base, cover assembly, and inserts to meet the needs of a variety of applications.

Applications

- Industrial • Commercial • Manufacturing • Residential
- Agricultural • Signage • Athletic fields • Municipalities

Features

- Complies with 2014 NEC Article 406.9 (B)(1) for wet locations and extra-duty applications
- Exceeds CEC Article 26-702
- UL Certified for Type 3R outdoor enclosures
- Meets requirements for cold impact testing: -60° F (-51° C)
- Heavy-duty die-cast aluminum cover and mounting base with UV stabilized polycarbonate inserts
- 1/8" (3 mm) thick, pre-adhered neoprene gasket with slits for mounting screws
- Lockable hasp: All models accept up to 1/4" (6 mm) dia shank
- Impact rated: 12 lb. impact test to ensure cover remains intact
- Reinforced hinge pin designed to exceed 40 lb. hinge hang/stress test
- Warranty: 1-year limited

Single-Gang Models

- Three inserts provided with all models that allow each model to meet multiple installations (up to 16 configurations)
- Max cord size: #12 AWG or higher

Double-Gang Models

- Six inserts provided with all models that allow each model to meet multiple installations (up to 70 configurations)
- Max cord size: (2) #12 AWG or higher

Dimensions

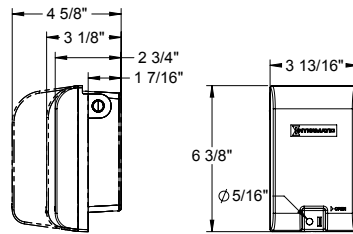

Single-Gang

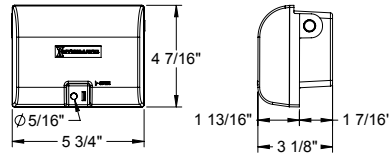

WP1010HMXD

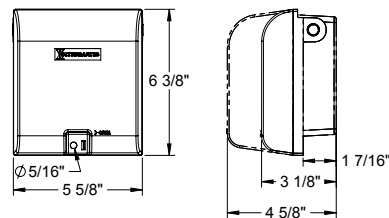

Double-Gang



WP3110MXD



WP1010MXD



WP1010HMXD



WP1250MVXD



WP1030MXD



WP1250MXD

Single-Gang



| Model # | Color | Depth | Flexi-Guard Inserts |
|-------------|-------|-----------------|---------------------|
| WP3110MXD | Gray | 2 3/4" (70 mm) | WP17 |
| WP1010MXD | Gray | 3 1/8" (79 mm) | WP17 |
| WP1010HMXD* | Gray | 3 1/8" (79 mm) | WP17 |
| WP1250MVXD | Gray | 4 5/8" (117 mm) | WP17 |

*Note: WP1010HMXD is a horizontal mount.

Double-Gang

| Model # | Color | Depth | Flexi-Guard Inserts |
|-----------|-------|-----------------|---------------------|
| WP1030MXD | Gray | 3 1/8" (79 mm) | WP217 |
| WP1250MXD | Gray | 4 5/8" (117 mm) | WP217 |

Accessories (detailed on pg 122)

| | |
|---------------------|-------|
| Single-Gang Inserts | WP17 |
| Double-Gang Inserts | WP217 |



WP5000G



Extra-Duty Plastic In-Use Weatherproof Covers

Single and Double-Gang Models

Plastic In-Use Weatherproof Covers are extra-duty rated and easy to install. Covers come with an adhered gasket, mounting screws, base, cover assembly, and inserts to meet the needs of a variety of applications.

Applications

- Industrial • Commercial • Manufacturing • Residential
- Agricultural • Signage • Athletic fields

Features

- Complies with 2014 NEC Article 406.9 (B)(1) for wet locations and extra-duty applications
- Exceeds CEC Article 26-702
- UL Certified for Type 3R outdoor enclosures
- Meets requirements for cold impact testing: -60° F (-51° C)
- Heavy-duty UV stabilized polycarbonate cover, mounting base, and inserts
- 1/8" (3 mm) thick, pre-adhered neoprene gasket with slits for mounting screws
- Lockable hasp: All models accept up to 1/4" (6 mm) dia shank
- Impact rated: 12-lb. impact test to ensure cover remains intact
- Reinforced hinge pin designed to exceed 40 lb. hinge hang/stress test
- Warranty: 1-year limited

Single-Gang Models

- Three inserts provided with all models that allow each model to meet multiple installations (up to 16 configurations)
- Max cord size: (2) #14 AWG or (1) #12 AWG

Double-Gang Models

- Six inserts provided with all models that allow each model to meet multiple installations (up to 70 configurations)
- Max cord size: (2) #12 AWG or (1) #10 AWG; 30/50 A (1) #6 AWG



WP5500C



WP5103C

Single-Gang - Vertical/Horizontal

| Clear/Gray | Gray | Black | Yellow | Orange | White | Green | Beige | Bronze | Red | Depth | Flexi-Guard Inserts |
|------------|---------|----------|---------|----------|---------|----------|---------|----------|---------|----------------|---------------------|
| WP5000C | WP5000G | WP5000BL | WP5000Y | WP5000OR | WP5000W | WP5000GN | WP5000B | WP5000BR | WP5000R | 2 1/4" (57 mm) | WP17 |
| WP5100C | WP5100G | WP5100BL | WP5100Y | WP5100OR | WP5100W | WP5100GN | WP5100B | WP5100BR | WP5100R | 2 3/4" (70 mm) | WP17 |
| WP5103C* | - | - | - | - | - | - | - | - | - | 2 3/4" (70 mm) | WP17 |
| WP5110C | WP5110G | WP5110BL | WP5110Y | WP5110OR | WP5110W | WP5110GN | WP5110B | WP5110BR | WP5110R | 3 5/8" (92 mm) | WP17 |

Double-Gang - Vertical

| Clear/Gray | Gray | Black | Yellow | Orange | White | Green | Beige | Bronze | Red | Depth | Flexi-Guard Inserts |
|------------|---------|----------|---------|----------|---------|----------|---------|----------|---------|----------------|---------------------|
| WP5220C | WP5220G | WP5220BL | WP5220Y | WP5220OR | WP5220W | WP5220GN | WP5220B | WP5220BR | WP5220R | 2 1/4" (57 mm) | WP217 |
| WP5221C | - | - | - | - | - | - | - | - | - | 2 1/4" (57 mm) | WP101, WP102 |
| WP5225C | WP5225G | WP5225BL | WP5225Y | WP5225OR | WP5225W | WP5225GN | WP5225B | WP5225BR | WP5225R | 2 3/4" (70 mm) | WP217 |
| WP5240C | WP5240G | WP5240BL | WP5240Y | WP5240OR | WP5240W | WP5240GN | WP5240B | WP5240BR | WP5240R | 3 5/8" (92 mm) | WP217 |
| WP5500C | WP5500G | - | WP5500Y | - | - | - | - | - | - | 30/50 A** | WP107, WP213 |

* Includes 3/0 adapter plate for 3" (76 mm) round box. **30/50 A = 4 3/4" (121 mm) depth.

Accessories (detailed on pg 122)

| | |
|---------------------|--------|
| Single-Gang Inserts | WP17 |
| Double-Gang Inserts | WP217 |
| Hinge Pin | WP10HP |

Single-Gang

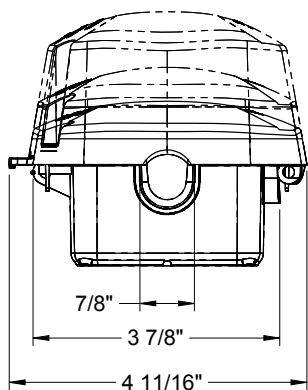
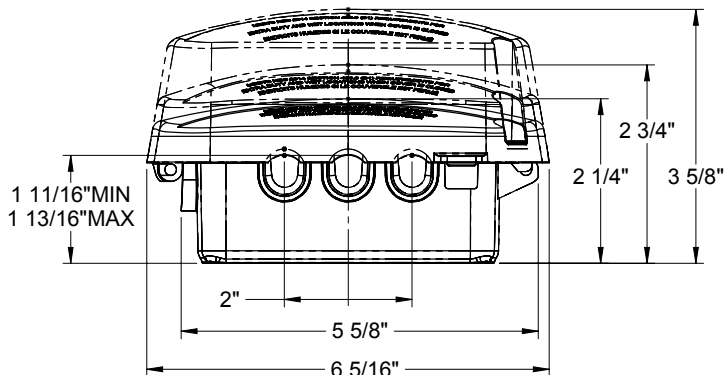

WP5103C

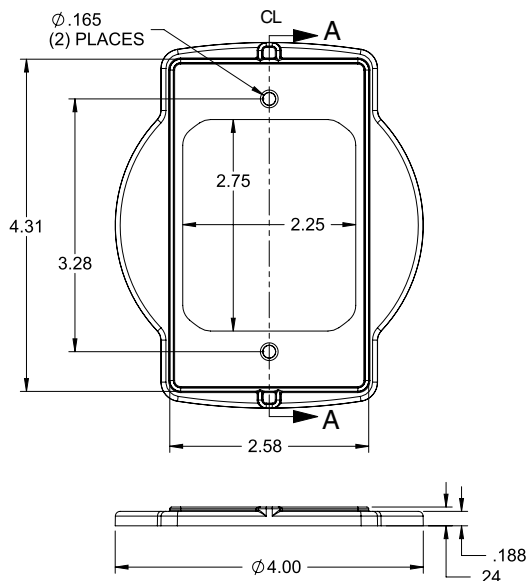

Double-Gang

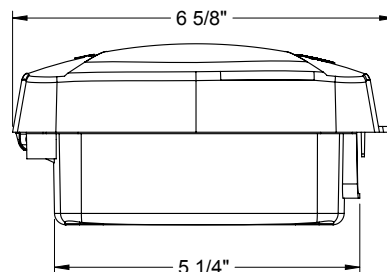
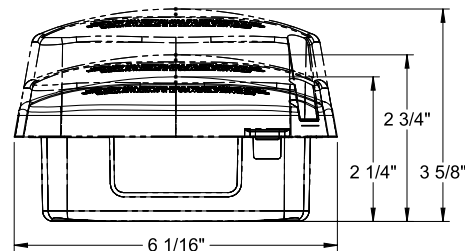

**Double-Gang
30/50 A**

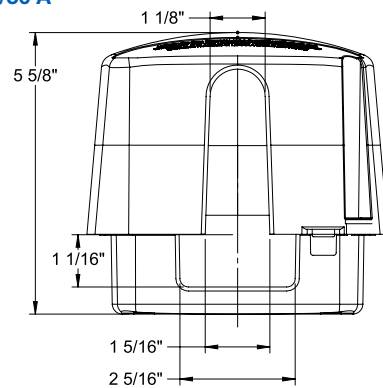

Weatherproof Covers

Plastic In-Use Covers



WP3100



WP3103C



WP1100C

Plastic In-Use Weatherproof Covers

Single-Gang Models

Plastic In-Use Weatherproof Covers are easy to install and include adhered gasket, mounting screws, base, cover assembly, and inserts to meet the needs of a variety of applications.

Applications

- Industrial • Commercial • Manufacturing • Residential
- Agricultural • Signage • Athletic fields

Features

- Complies with 2014 NEC Article 314.15 for damp and wet locations
- Exceeds CEC Article 26-702
- UL Certified for Type 3R outdoor enclosures
- Meets requirements for cold impact testing: -60° F (-51° C)
- Heavy-duty UV stabilized polycarbonate cover, mounting base and inserts
- 1/8" (3 mm) thick, pre-adhered neoprene gasket with slits for mounting screws
- Lockable hasp: All models accept up to 1/4" (6 mm) dia shank; Except WP3100C & WP3103C accept up to 1/8" (3 mm) dia shank
- Three inserts provided with all models that allow each model to meet multiple installations (up to 16 configurations)
- Max cord size: (2) #14 AWG or (1) #12 AWG
- Mounts vertically or horizontally
- Warranty: 1-year limited

Dimensions

WP3100

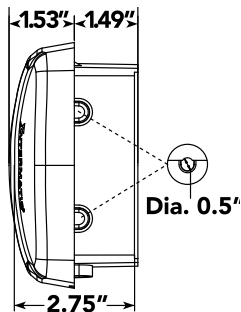
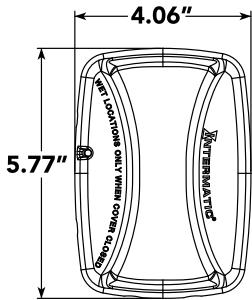

WP1100C, WP1110C

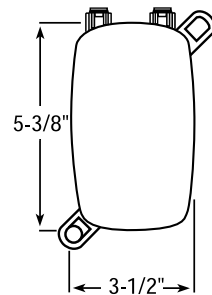
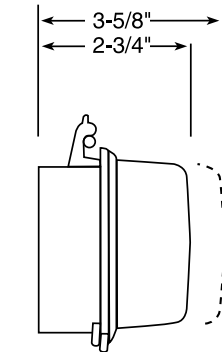

Single-Gang - Vertical/Horizontal Hinge



| Model # | Color | Depth | Flexi-Guard Inserts |
|-----------|-------|----------------|---------------------|
| WP3100C* | Clear | 2 3/4" (70 mm) | WP17 |
| WP3103C** | Clear | 2 3/4" (70 mm) | WP17 |
| WP1100C | Clear | 2 3/4" (70 mm) | WP17 |
| WP1100WC | White | 2 3/4" (70 mm) | WP17 |
| WP1110C | Clear | 3 5/8" (92 mm) | WP17 |
| WP1110GC | Gray | 3 5/8" (92 mm) | WP17 |
| WP1110WC | White | 3 5/8" (92 mm) | WP17 |

*Hidden Hinge.

**Includes 3/0 Adapter Plate for 3" (76 mm) Round Box.

Accessories (detailed on pg 122)

| | |
|---------------------|------|
| Single-Gang Inserts | WP17 |
|---------------------|------|

Plastic In-Use Weatherproof Covers

Single-Gang Models

Plastic In-Use Weatherproof Covers are easy to install. Covers come with an adhered gasket, mounting screws, base, cover assembly, and inserts to meet the needs of a variety of applications.

Applications

- Industrial • Commercial • Manufacturing • Residential
- Agricultural • Signage • Athletic fields

Features

- Complies with 2014 NEC Article 314.15 for damp and wet locations
- Exceeds CEC Rule 26-702
- UL Certified for Type 3R outdoor enclosures
- Meets requirements for cold impact testing: -60° F (-51° C)
- Heavy-duty UV stabilized polycarbonate cover, mounting base and inserts
- 1/8" (3 mm) thick, pre-adhered neoprene gasket with slits for mounting screws
- Three inserts provided with all models that allow each model to meet multiple installations (up to 8 configurations)
- Max cord size: (2) #14 AWG or (1) #12 AWG
- Warranty: 1-year limited



Single-Gang - Vertical Hinge

| Model # | Color | Depth | Flexi-Guard Inserts |
|----------|-------|-------------------|---------------------|
| WP1000C | Clear | 2 1/4" (57 mm) | WP17 |
| WP1000GC | Gray | 2 1/4" (57 mm) | WP17 |
| WP1000WC | White | 2 1/4" (57 mm) | WP17 |
| WP1010C | Clear | 3 1/8" (79 mm) | WP17 |

Single-Gang - Horizontal Hinge

| Model # | Color | Depth | Flexi-Guard Inserts |
|-----------|-------|--------------------|---------------------|
| WP1000HC | Clear | 2 1/4" (57 mm) | WP17 |
| WP1000HGC | Gray | 2 1/4" (57 mm) | WP17 |
| WP1010HC | Clear | 3 1/8" (79 mm) | WP17 |
| WP1150C | Clear | 4 3/4" (121 mm) | WP17 |

Accessories (detailed on pg 122)

| | |
|---------------------|------|
| Single-Gang Inserts | WP17 |
|---------------------|------|



WP1000C



WP1000HC

Dimensions

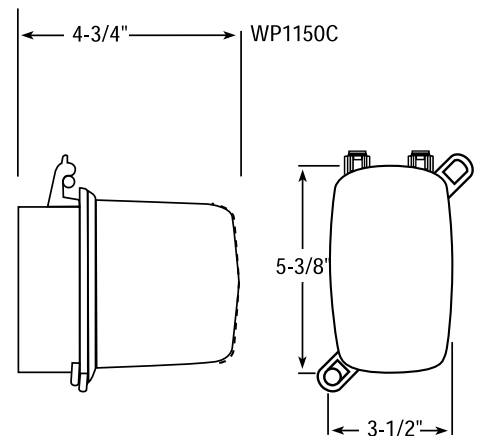
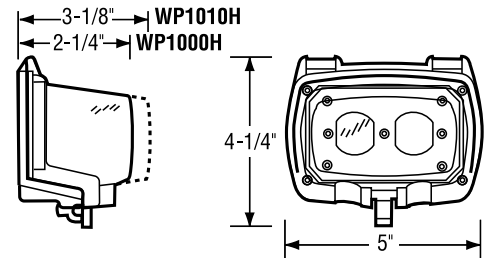
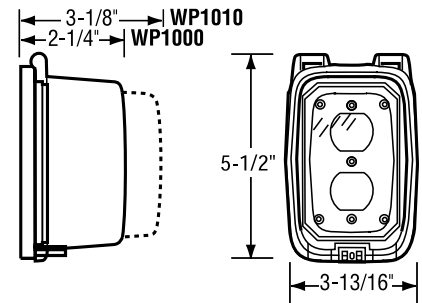



WP1020C

Dimensions

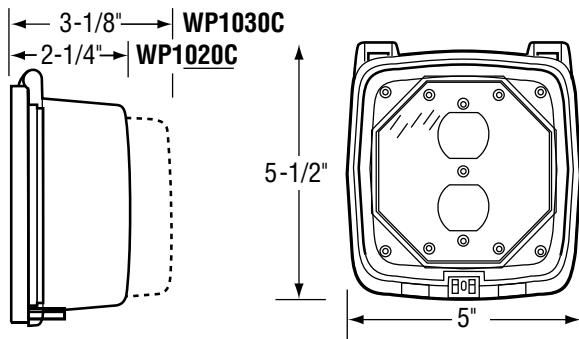

WP1050

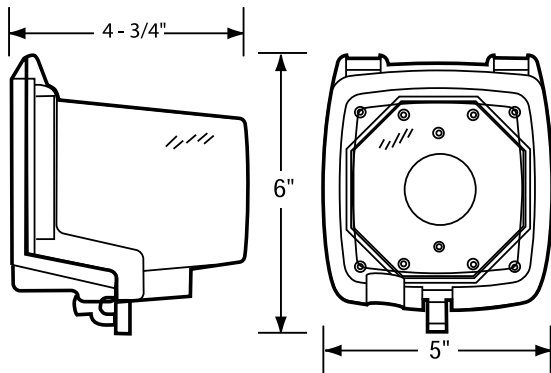

Plastic In-Use Weatherproof Covers

Double-Gang Models

Plastic In-Use Weatherproof Covers are easy to install and include a gasket, mounting screws, base, cover assembly, and inserts to meet the needs of a variety of applications.

Applications

- Industrial • Commercial • Manufacturing • Residential
- Agricultural • Signage • Athletic fields

Features

- Complies with 2014 NEC Article 314.15 for damp and wet locations
- Exceeds CEC Article 26-702
- UL Certified for Type 3R outdoor enclosures
- Meets requirements for cold impact testing: -60° F (-51° C)
- Heavy-duty UV stabilized polycarbonate cover, mounting base and inserts
- 1/8" (3 mm) thick neoprene gasket with slits for mounting screws
- Two inserts provided with all models for multiple installations
- Max cord size: (2) #14 AWG or (1) #12 AWG;
WP1050 (2) #14 AWG or (1) #10 AWG
- Warranty: 1-year limited



Double-Gang - Vertical Hinge

| Model # | Color | Depth | Flexi-Guard Inserts |
|----------|-------|-----------------|---------------------|
| WP1020C | Clear | 2 1/4" (57 mm) | WP101, WP102 |
| WP1020GC | Gray | 2 1/4" (57 mm) | WP101, WP102 |
| WP1020WC | White | 2 1/4" (57 mm) | WP101, WP102 |
| WP1030C | Clear | 3 1/8" (79 mm) | WP101, WP102 |
| WP1050 | Clear | 4 3/4" (121 mm) | WP102, WP107 |

Accessories (detailed on pg 122)

| | |
|--|-------|
| Double-Gang Duplex Insert | WP101 |
| Double-Gang GFCI Insert | WP102 |
| Double-Gang Insert - Round 1 3/8" (35 mm), 1 5/8" (41 mm), 1 3/4" (44 mm) | WP107 |
| Double-Gang Insert - Round 2 1/8" (55 mm), 2 5/8" (67 mm) | WP213 |

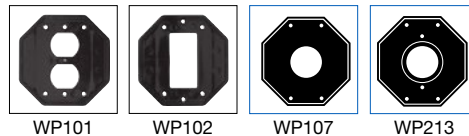

Plastic In-Use Weatherproof Covers

Double-Gang Models

Plastic In-Use Weatherproof Covers are easy to install and include a gasket, mounting screws, base, cover assembly, and inserts to meet the needs of a variety of applications.

Applications

- Industrial • Commercial • Manufacturing • Residential
- Agricultural • Signage • Athletic Fields

Features

- Complies with 2014 NEC Article 314.15 for damp and wet locations
- Exceeds CEC Article 26-702
- UL Certified for Type 3R outdoor enclosures
- Meets requirements for cold impact testing: -60° F (-51° C)
- Heavy-duty UV stabilized polycarbonate cover, mounting base and inserts
- 1/8" (3 mm) thick neoprene gasket with slits for mounting screws
- Six inserts provided with all models that allow each model to meet multiple installations (up to 70 configurations)
- Max cord size: (2) #14 AWG or (1) #12 AWG;
WP1250 (2) #14 AWG or (1) #10 AWG
- Warranty: 1-year limited



Double-Gang - Vertical Hinge

| Model # | Color | Depth | Flexi-Guard Inserts |
|----------|-------|-----------------|---------------------|
| WP1220C | Clear | 2 1/4" (57 mm) | WP217 |
| WP1220GC | Gray | 2 1/4" (57 mm) | WP217 |
| WP1220WC | White | 2 1/4" (57 mm) | WP217 |
| WP1230C | Clear | 3 1/8" (79 mm) | WP217 |
| WP1250C | Clear | 4 3/4" (121 mm) | WP217 |

Accessories (detailed on pg 122)

| | |
|--------------------|-------|
| Double-Gang Insert | WP217 |
|--------------------|-------|



WP1250

Dimensions

