



aerospace
climate control
electromechanical
filtration
fluid & gas handling
hydraulics
pneumatics
process control
sealing & shielding



Thermostatic and Automatic Expansion Valves

Catalog E-1, July 2012

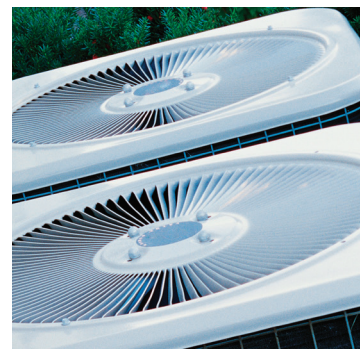

ENGINEERING YOUR SUCCESS.

Table of Contents

Thermostatic Expansion Valves (TEVs) and Constant Pressure (Automatic) Expansion Valves (AEVs)

Visual Table of Contents	2
Thermostatic Expansion Valves	
Model Number Selection Guide	3
N Series	4
C(E) Series	5
EC(E) Series	6
SC(E) Series	8
C Series Interchangeable Valve	9
H Series	12
HC Series	12
EBSE Series	14
OE Series	15
Capacity Tables	17
Constant Pressure (Automatic) Expansion Valves	
A Series Valves	22
Capacity Tables	24
Terms of Sale With Warranty Limitations	27

⚠ WARNING – USER RESPONSIBILITY

Failure or improper selection or improper use of the products described herein or related items can cause death, personal injury and property damage.

This document and other information from Parker Hannifin Corporation, its subsidiaries and authorized distributors provide product or system options for further investigation by users having technical expertise.

The user, through its own analysis and testing, is solely responsible for making the final selection of the system and components and assuring that all performance, endurance, maintenance, safety and warning requirements of the application are met. The user must analyze all aspects of the application, follow applicable industry standards, and follow the information concerning the product in the current product catalog and in any other materials provided from Parker or its subsidiaries or authorized distributors.

To the extent that Parker or its subsidiaries or authorized distributors provide component or system options based upon data or specifications provided by the user, the user is responsible for determining that such data and specifications are suitable and sufficient for all applications and reasonably foreseeable uses of the components or systems.

OFFER OF SALE

The items described in this document are hereby offered for sale by Parker Hannifin Corporation, its subsidiaries or its authorized distributors. This offer and its acceptance are governed by the provisions stated in the detailed "Offer of Sale" available at www.parker.com.

FOR USE ON REFRIGERATION and/or AIR CONDITIONING SYSTEMS ONLY

Catalog E-1, July 2012, supersedes Catalog E-1, October 2007 and all prior publications.

Visual Table of Contents



N Series TEV

page 4

Applications:
Low Profile Coolers,
Ice Machines,
Beverage Dispensers



C(E) Series TEV

page 5

Applications:
Rail and Transport
Refrigeration,
Supermarket Cases,
Walk-in Coolers



EC(E) Series TEV

page 6

Applications:
Supermarket Cases,
Transport Refrigeration,
Walk-in Coolers



SC(E) Series TEV

page 8

Applications:
Supermarket Cases,
Walk-in Freezers,
Ice Machines



C Series Interchangeable TEV

page 9

Applications:
Air Conditioning, Heat
Pumps, Supermarket
Cases, Walk-in Coolers



H Series TEV

page 12

Applications:
Air Conditioning,
Heat Pumps, Bi-flow
(Package Systems)



HC Series TEV

page 12

Applications:
Air Conditioning,
Heat Pumps



EBSE Series TEV

page 14

Applications:
Air Conditioning,
Industrial Chillers,
Commercial
Refrigeration



OE Series TEV

page 15

Applications:
Air Conditioning,
Industrial Chillers,
Commercial
Refrigeration



AT Series AEV

page 22

Applications:
Ice Cream/Slush
Machines,
Hot Gas Bypass,
Freeze Protection,
Refrigerant Reclaim,
PTAC/PTHP, High Cycle



A7 Series AEV

page 22

Applications:
Ice Cream/Slush
Machines,
Hot Gas Bypass,
Freeze Protection,
Refrigerant Reclaim,
PTAC/PTHP, High Cycle



AS Series AEV

page 22

Applications:
Ice Cream/Slush
Machines,
Hot Gas Bypass,
Freeze Protection,
Refrigerant Reclaim,
Vending, Ice Machines



A1 Series AEV

page 22

Applications:
Ice Cream/Slush
Machines,
Hot Gas Bypass,
Freeze Protection,
Refrigerant Reclaim,
Vending, Ice Machines



A2 Series AEV

page 23

Applications:
Ice Cream/Slush
Machines,
Hot Gas Bypass,
Freeze Protection,
Refrigerant Reclaim,
Vending, Ice Machines



A3 Series AEV

page 23

Applications:
Ice Cream/Slush
Machines,
Hot Gas Bypass,
Freeze Protection,
Refrigerant Reclaim,
Vending, Ice Machines



A4 Series AEV

page 23

Applications:
Ice Cream/Slush
Machines,
Hot Gas Bypass,
Freeze Protection,
Refrigerant Reclaim,
Vending, Ice Machines

TEV Model Number Selection Guide

Nomenclature (Example)

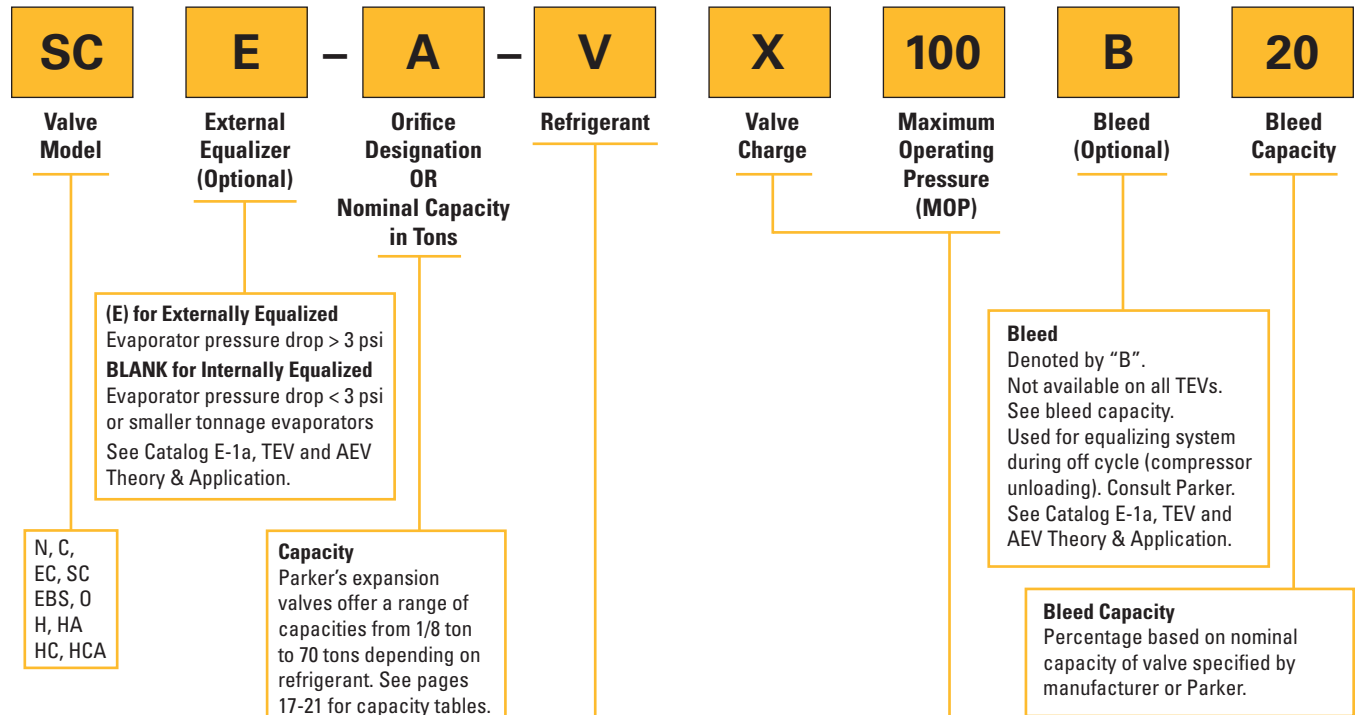

Rainbow Charge™ Refrigerant Designation

J	R-134a, R-401A (MP39), R-401B (MP66), R-12
V	R-407C (AC9000), R-22
S	R-125, R-404A (HP62), R-402A (HP80), R-402B (HP81), R-507 (AZ50)
Z	R-410A (AZ20)

Refrigerant Color Code

R-12 - yellow
 R-134a - light blue
 R-22 - green
 R-402A - light brown (sand)
 R-402B - olive
 R-404A - orange
 R-407C - medium brown
 R-410A - rose
 R-507 - teal

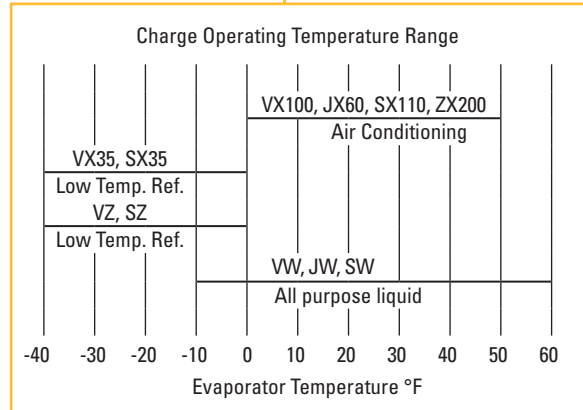

†Charge Type

"W" (all-purpose) liquid charge maintains nearly flat superheat control over a -10°F to +60°F (-23°C to +15°C) evaporator temperature range.

"Z" (low temperature) charge provides fast pulldown benefits like a gas charge with the non-migrating benefits of a liquid charge; usable over a -40°F to 0°F (-40°C to -18°C) evaporator temperature range.

"X" (damped response) gas charge provides a pressure limiting (MOP) charge with anti-hunt characteristics over a -40°F to +60°F (-40°C to +15°C) evaporator temperature range.

Notes: M.O.P. not available on "W" or "Z" charge.

1. Maximum operational pressure 500 psig (35 bar) high side and 275 psig (19 bar) low side.
2. Maximum storage temperature 130°F (55°C).
3. Consult Parker for pressure and temperature exceptions.
4. Do not use "W" or "Z" liquid charges in applications where bulb temperatures can exceed 130°F (55°C). For these applications use type "X" MOP gas charge **only**.

N Series

This small flare brass valve series is ideally suited where space is at a premium. Its stainless steel power element and compact body has always made it the first choice for installation in commercial refrigeration systems. External equalized models are provided with a 30" capillary and 1/4" SAE flare nut, eliminating the need to run a separate equalizer line. Medium, low & MOP "X" charges are available as noted below.

Applications

- Low Profile Coolers
- Beverage Dispensers
- Beverage Boxes
- Small Chillers
- Ice Machines
- Small Freezers

Features and Benefits

- Compact body
- Inlet strainer
- Factory set superheat
- Accurate and stable control
- Right angle configuration
- 30" capillary tube
- Weight: 5.0 oz. / .14 kg



Specifications

Refrigerant	Refrigerant Designation	Nominal Capacity (Tons)	Valve Description		Rainbow Charges™	Connection - (Inches)	
			Internally Equalized	Externally Equalized		Inlet	Outlet
R-12 R-134a R-401A R-401B	J	1/4	N-1/4-J	—	W X60	1/4 SAE	1/2 SAE
		1/2	N-1/2-J			3/8 SAE	
		2	N-2-J	NE-2-J			
R-402A R-402B R-404A R-502 R-507	S	1/2	N-1/2-S	—	W Z X110	1/4 or 3/8 SAE	1/2 SAE
		1/4	N-1/4-S			1/4 SAE	
		2	N-2-S	NE-2-S		3/8 SAE	
R-22 R-407C	V	1/4	N-1/4-V	—	W Z X100	1/4 SAE	1/2 SAE
		1/2	N-1/2-V			1/4 or 3/8 SAE	
		1	N-1-V				
		3	N-3-V	NE-3-V		3/8 SAE	

Dimensions

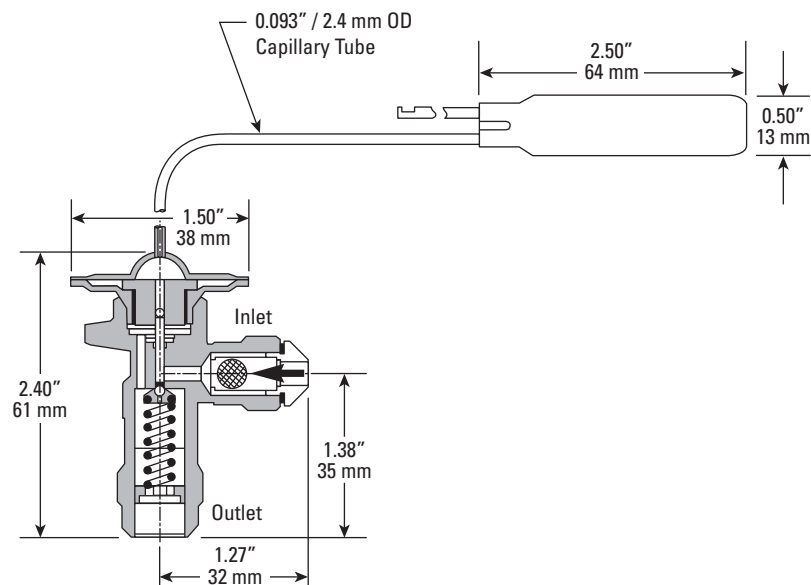

C(E) Series

The C(E) series incorporates a brass body with a 90° elbow inlet and SAE flare fittings using balanced port construction, allowing operation over varying load conditions. Designed for use on small refrigeration and or air conditioning systems, the external equalized models are provided with a 1/4" SAE male connection.

Applications

- Small Refrigeration Systems
- Slush Machines
- Air Conditioning Units
- Freezers
- Walk-in Coolers
- Refrigerated Cases
- Rail & Transport Refrigeration

Features and Benefits

- Balanced port design
- Removable power element
- Inlet strainer – 100 mesh
- 60" capillary tube
- Field adjustable superheat
- 1/4" SAE external equalizer
- Weight: 1.0 lbs / 0.45 kg



Specifications

Refrigerant	Refrigerant Designation	Orifice Designation	Nominal Capacity (Tons)	Capacity Range of Valve to be Replaced (Tons)	Valve Description		Rainbow Charges™	Connection - (Inches)		External Equalizer Connection (Inches)
					Internally Equalized	Externally Equalized		Inlet	Outlet	
R-12 R-134a R-401A R-401B	J	AA	1/4	1/6 to 1/4	C-AA-J	CE-AA-J	W X60	1/4 SAE	1/2 SAE	1/4 SAE
		A	1	1/2 to 1	C-A-J	CE-A-J		3/8 SAE		
		B	2	1 to 2	C-B-J	CE-B-J		5/8 SAE		
		C	3	2 to 3	C-C-J	CE-C-J				
		D	5	3 to 5	C-D-J	CE-D-J				
R-402A R-402B R-404A R-502	S	AA	1/4	1/6 to 1/4	C-AA-S	CE-AA-S	W Z X110 X35	1/4 SAE	1/2 SAE	1/4 SAE
		A	1	1/2 to 1	C-A-S	CE-A-S		3/8 SAE		
		B	2	1 to 2	C-B-S	CE-B-S		5/8 SAE		
		C	3-1/2	2 to 3-1/2	C-C-S	CE-C-S				
		D	6	3-1/2 to 6	C-D-S	CE-D-S				
R-22 R-407C R-422D	V	AA	1/2	1/3 to 1/2	C-AA-V	CE-AA-V	W Z X100 X35	1/4 SAE	1/2 SAE	1/4 SAE
		A	1-1/2	3/4 to 1-1/2	C-A-V	CE-A-V		3/8 SAE		
		B	3	1-1/2 to 3	C-B-V	CE-B-V		5/8 SAE		
		C	5	3 to 5	C-C-V	CE-C-V				
		D	8	5 to 8	C-D-V	CE-D-V				

Dimensions

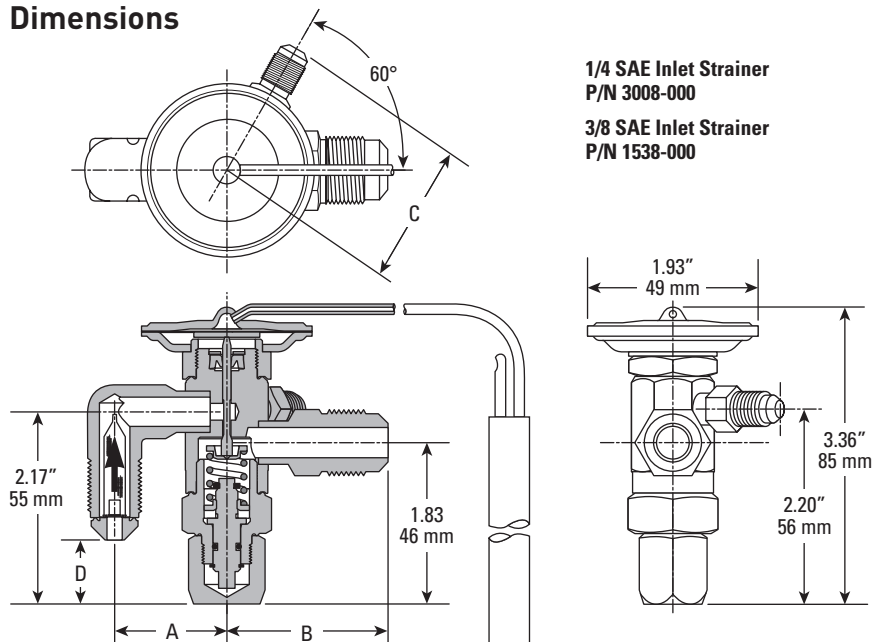

1/4 SAE Inlet Strainer
P/N 3008-000

3/8 SAE Inlet Strainer
P/N 1538-000

Fitting Size	A	B	C	D
1/4 SAE	1.11" 28 mm	—	1.54" 39 mm	1.15" 29 mm
3/8 SAE	1.27" 32 mm	—	—	0.75" 19 mm
1/2 SAE	—	1.82" 46 mm	—	—
5/8 SAE	—	1.98" 50 mm	—	—

Replacement Elements

Refrigerant Designation	Element
V	KT-46-VW KT-46-VX100
J	KT-46-JW KT-46-JX60
S	KT-46-SZ KT-46-SW KT-46-SX35

EC(E) Series

The EC(E) series features extended ODF solder connections, brass body and balanced port design. It is suited for both refrigeration and air conditioning applications.

Applications

- Small Chillers
- Air Conditioning Units
- Freezers
- Walk-in Boxes
- Refrigerated Cases
- Mobile Refrigeration

Features and Benefits

- Extended ODF connections
- Balanced port design
- 60" capillary tube
- Removable power element
- Field adjustable superheat
- 1/4" ODF external equalizer
- Weight: 1.0 lbs / 0.45 kg



Specifications

Refrigerant	Refrigerant Designation	Orifice Designation	Nominal Capacity (Tons)	Capacity Range of Valve to be Replaced (Tons)	Valve Description		Rainbow Charges™	Connection - (Inches) Bold figures are standard		External Equalizer Connection (Inches)
					Internally Equalized	Externally Equalized		Inlet	Outlet	
R-12 R-134a R-401A R-401B	J	AA	1/4	1/6 to 1/4	EC-AA-J	ECE-AA-J	W X60	1/4 ODF	1/2 ODF	1/4 ODF
		A	1	1/2 to 1	EC-A-J	ECE-A-J		3/8 ODF	1/2 ODF	
		B	2	1 to 2	EC-B-J	ECE-B-J		3/8 ODF 1/2 ODF	1/2 ODF 5/8 ODF	
		C	3	2 to 3	EC-C-J	ECE-C-J		3/8 ODF 1/2 ODF 5/8 ODF	1/2 ODF 5/8 ODF 7/8 ODF	
		D	5	3 to 5	N/A	ECE-D-J		1/2 ODF 5/8 ODF	7/8 ODF	
R-402A R-402B R-404A R-502 R-507	S	AA	1/4	1/6 to 1/4	EC-AA-S	ECE-AA-S	W Z X110 X35	1/4 ODF	1/2 ODF	1/4 ODF
		A	1	1/2 to 1	EC-A-S	ECE-A-S		3/8 ODF	1/2 ODF	
		B	2	1 to 2	EC-B-S	ECE-B-S		3/8 ODF 1/2 ODF	1/2 ODF 5/8 ODF	
		C	3-1/2	2 to 3-1/2	EC-C-S	ECE-C-S		3/8 ODF 1/2 ODF 5/8 ODF	1/2 ODF 5/8 ODF 7/8 ODF	
		D	6	3-1/2 to 6	N/A	ECE-D-S		1/2 ODF 5/8 ODF	7/8 ODF	
R-22 R-407C R-422D	V	AA	1/2	1/3 to 1/2	EC-AA-V	ECE-AA-V	W Z X100 X35	1/4 ODF	1/2 ODF	1/4 ODF
		A	1-1/2	3/4 to 1-1/2	EC-A-V	ECE-A-V		3/8 ODF	1/2 ODF	
		B	3	1-1/2 to 3	EC-B-V	ECE-B-V		3/8 ODF 1/2 ODF	1/2 ODF 5/8 ODF	
		C	5	3 to 5	EC-C-V	ECE-C-V		3/8 ODF 1/2 ODF 5/8 ODF	1/2 ODF 5/8 ODF 7/8 ODF	
		D	8	5 to 8	N/A	ECE-D-V		1/2 ODF 5/8 ODF	7/8 ODF	
R-410A	Z	AA	1/2	1/3 to 1/2	EC-AA-Z	ECE-AA-Z	X200	1/4 ODF	1/2 ODF	1/4 ODF
		A	1-1/2	3/4 to 1-1/2	EC-A-Z	ECE-A-Z		3/8 ODF	1/2 ODF	
		B	3	1-1/2 to 3	EC-B-Z	ECE-B-Z		3/8 ODF 1/2 ODF	1/2 ODF 5/8 ODF	
		C	5	3 to 5	EC-C-Z	ECE-C-Z		3/8 ODF 1/2 ODF 5/8 ODF	1/2 ODF 5/8 ODF 7/8 ODF	
		D	8	5 to 8	N/A	ECE-D-Z		1/2 ODF 5/8 ODF	7/8 ODF	
		N/A	12-1/2	8 to 12-1/2	N/A	ECE-12-1/2-Z		5/8 ODF	7/8 ODF	
		N/A	15	12-1/2 to 15	N/A	ECE-15-Z		5/8 ODF	7/8 ODF 1-1/8 ODF	

EC(E) Series

Dimensions

ECE-AA, -A, -B, -C, -D

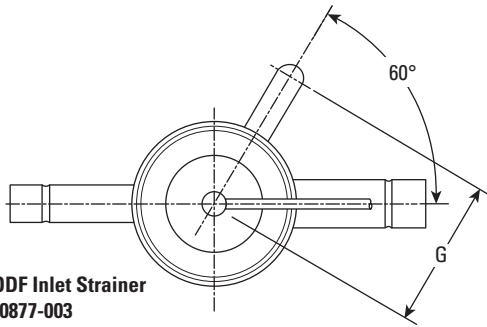

3/8 ODF Inlet Strainer
P/N 0877-003

1/2 ODF Inlet Strainer
P/N 0877-004

5/8 ODF Inlet Strainer
P/N 0877-005

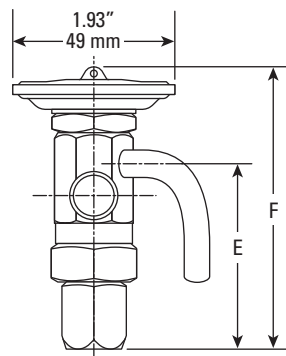
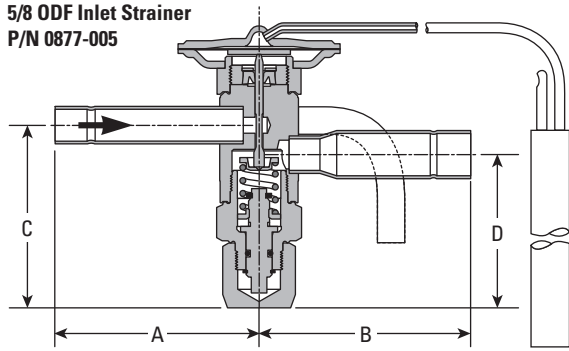

Replacement Elements

Refrigerant Designation	Element
V	KT-46-VW KT-46-VX100
J	KT-46-JW
S	KT-46-SZ KT-46-SW KT-46-SX35
Z	KT-46-ZX200

ECE-12-1/2-Z and ECE-15-Z Only

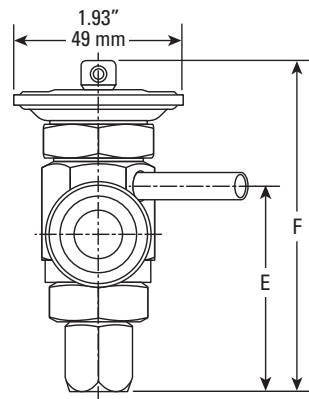
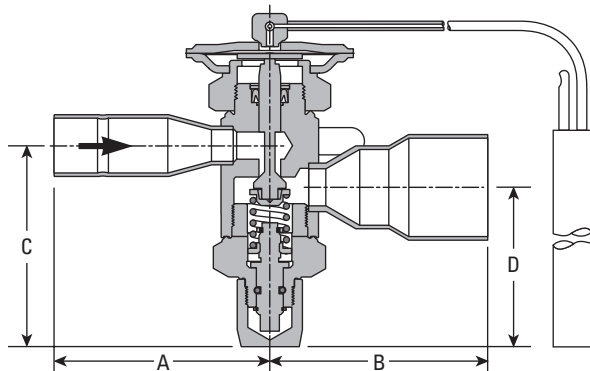
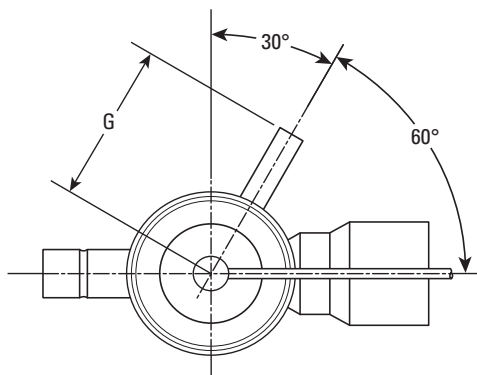

Replacement Elements

Refrigerant Designation	Element
Z	KT-46-5-ZX200*

* For ECE-12-1/2-Z and ECE-15-Z only.

Fitting Size	A	B	C	D	E	F	G
1/4	—	—	—	—	2.36" 60 mm	3.79" 96 mm	1.90" 48 mm
5/8	2.48" 63 mm	—	2.30" 58 mm	—	—	3.79" 96 mm	—
7/8	—	2.51" 64 mm	—	1.83" 46 mm	—	3.79" 96 mm	—
1-1/8	—	2.51" 64 mm	—	1.83" 46 mm	—	3.79" 96 mm	—

SC(E) Series

The SC(E) series brass body expansion valve incorporates a 90° elbow inlet with a removable strainer that may be replaced or cleaned without removing the valve from the system, and is an ideal choice for commercial refrigeration and supermarket applications.

Applications

- Supermarket Cases
- Self-contained Cases
- Walk-in Coolers/Freezers
- Ice Machines
- Salad Bars
- Transport Refrigeration

Features and Benefits

- Balanced port design
- Removable power element
- 60" capillary tube
- Removable inlet strainer – 100 mesh
- Field adjustable superheat
- 1/4" ODF external equalizer
- "W", "Z" or MOP "X" charges available
- Weight: 1.0 lbs / 0.45 kg



Specifications

Refrigerant	Refrigerant Designation	Orifice Designation	Nominal Capacity (Tons)	Capacity Range of Valve to be Replaced (Tons)	Valve Description		Rainbow Charges™	Connection - (Inches)		External Equalizer Connection (Inches)
					Internally Equalized	Externally Equalized		Inlet	Outlet	
R-12 R-134a R-401A R-401B	J	AA	1/4	1/6 to 1/4	N/A	SCE-AA-J	W X60	3/8 ODF	1/2 ODF	1/4 ODF
		A	1	1/2 to 1		SCE-A-J				
		B	2	1 to 2		SCE-B-J				
		C	3	2 to 3		SCE-C-J				
		D	5	3 to 5		SCE-D-J				
R-402A R-402B R-404A R-502 R-507	S	AAA	1/6	1/8 to 1/6	N/A	SCE-AAA-S	W Z X110 X35	3/8 ODF	1/2 ODF	1/4 ODF
		AA	1/4	1/6 to 1/4		SCE-AA-S				
		A	1	1/2 to 1		SCE-A-S				
		B	2	1 to 2		SCE-B-S				
		C	3-1/2	2 to 3-1/2		SCE-C-S				
		D	6	3-1/2 to 6		SCE-D-S				
R-22 R-407C R-422D	V	AAA	1/3	1/6 to 1/3	N/A	SCE-AAA-V	W Z X110 X35	3/8 ODF	1/2 ODF	1/4 ODF
		AA	1/2	1/3 to 1/2		SCE-AA-V				
		A	1-1/2	3/4 to 1-1/2		SCE-A-V				
		B	3	1-1/2 to 3		SCE-B-V				
		C	5	3 to 5		SCE-C-V				
D	8	5 to 8	SCE-D-V							

Dimensions

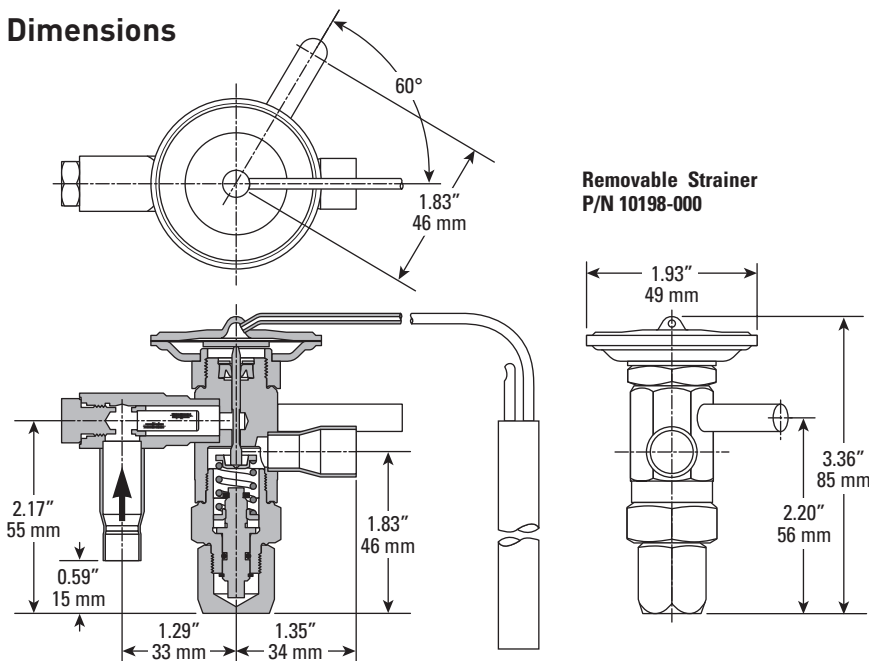

Replacement Elements

Refrigerant Designation	Element
V	KT-46-VW KT-46-VX100
J	KT-46-JW
S	KT-46-SZ KT-46-SW KT-46-SX35

C Series Interchangeable Valve

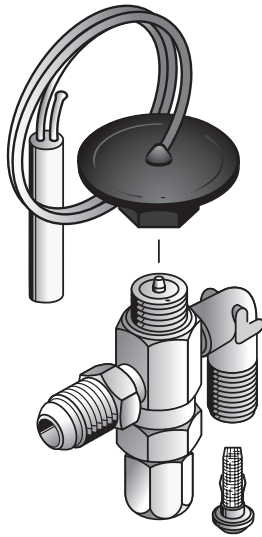

The C series replaceable element style valves are designed for small refrigeration systems, such as refrigerated cases, coolers, and freezers. The externally equalized versions of these valves are ideal for air conditioning and refrigeration systems. C valves are balanced ported, engineered specifically for systems with a wide range of operating conditions and may be applied on bi-directional applications.

C valves are supplied as 2 individual component parts: the **thermostatic element**, and the **valve body**. The interchangeable nature of the C family makes it ideal for reducing inventory, while increasing valve options — so, the right valve is always on hand.

Body Features

C brass body type valves feature traditional knife edge, metal-to-metal thermostatic element to valve body construction, which ensures a leak-proof joint.

Selective Charges

The selective thermostatic charges are specifically designed for low temperature, medium temperature, and air conditioning applications. The elements are manufactured with a large flat diaphragm to reduce diaphragm stresses and provide precise control. And, because C valve bodies and thermostatic elements are supplied as independent components, the installer is able to select the best possible thermostatic charge for the application.

Internal Port Design

Refrigerant flow through the valve port opposes the pin movement in all type C valves. This provides improved stability at light loads, when the pin modulates to a position close to the port. Additionally, charge migration, is reduced or eliminated by the C valve design. By engineering the liquid flow to enter through the top of the valve body, the liquid refrigerant warms the thermostatic element and minimizes the potential for charge migration.

Applications

- Small Refrigeration Systems
- Air Conditioning Systems
- Heat Pump Systems
- Freezers
- Walk-in Coolers
- Refrigerated Cases

Features and Benefits

- Balanced port design
- Removable power element
- Inlet strainer – 100 mesh
- 60" capillary tube
- Field adjustable superheat
- 1/4" SAE external equalizer
- Weight: 1.0 lbs / 0.45 kg



C Series Interchangeable Valve

Selecting Components

■ Body

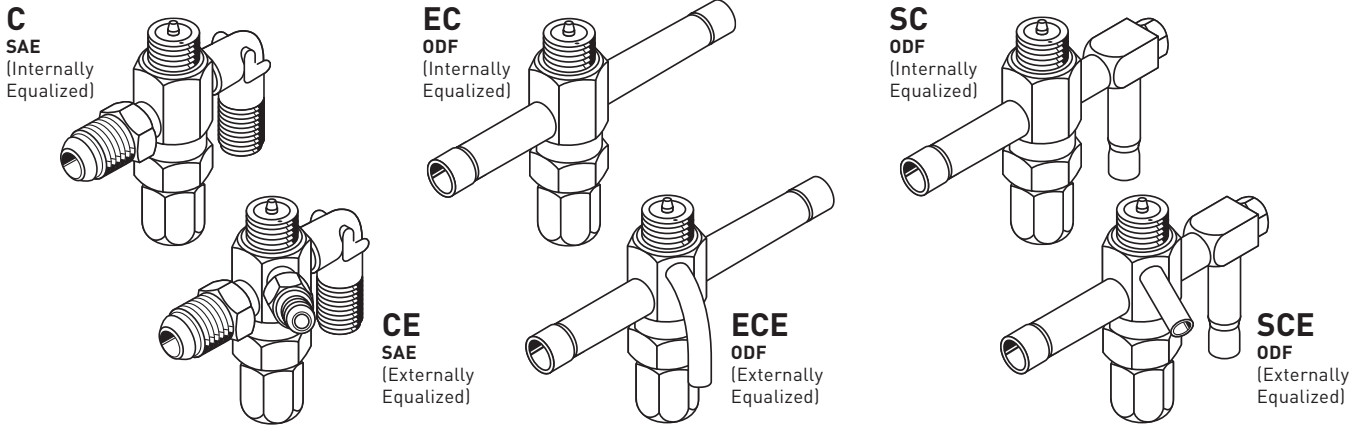

Capacities

Nominal Capacity - Tons (Capacity Range of Valve to be Replaced - Tons)									Orifice Designation Letter Code	Available Valve Body Configurations*
R-12	R-22 R-407C R-422D	R-134a	R-401A R-401B	R-402A R-402B	R-404A	R-410A	R-502	R-507		
1/4 (1/6 to 1/4)	1/2 (1/3 to 1/2)	1/4 (1/6 to 1/4)	1/4 (1/6 to 1/4)	1/4 (1/6 to 1/4)	1/4 (1/6 to 1/4)	1/2 (1/3 to 1/2)	1/4 (1/6 to 1/4)	1/4 (1/6 to 1/4)	AA	C - AA - 1/4 X 1/2 SAE CE - AA - 1/4 X 1/2 X 1/4 SAE EC - AA - 3/8 X 1/2 ODF ECE - AA - 3/8 X 1/2 X 1/4 ODF SC - AA - 3/8 X 1/2 ODF SCE - AA - 3/8 X 1/2 X 1/4 ODF
1 (1/2 to 1)	1-1/2 (3/4 to 1-1/2)	1 (1/2 to 1)	1 (1/2 to 1)	1 (1/2 to 1)	1 (1/2 to 1)	1-1/2 (3/4 to 1-1/2)	1 (1/2 to 1)	1 (1/2 to 1)	A	C - A - 1/4 X 1/2 SAE CE - A - 1/4 X 1/2 X 1/4 SAE EC - A - 3/8 X 1/2 ODF ECE - A - 3/8 X 1/2 X 1/4 ODF SC - A - 3/8 X 1/2 ODF SCE - A - 3/8 X 1/2 X 1/4 ODF
2 (1 to 2)	3 (1-1/2 to 3)	2 (1 to 2)	2 (1 to 2)	2 (1 to 2)	2 (1 to 2)	3 (1-1/2 to 3)	2 (1 to 2)	2 (1 to 2)	B	CE - B - 1/4 X 1/2 X 1/4 SAE ECE - B - 3/8 X 1/2 X 1/4 ODF SCE - B - 3/8 X 1/2 X 1/4 ODF
3 (2 to 3)	5 (3 to 5)	3 (2 to 3)	3 (2 to 3)	3-1/2 (2 to 3-1/2)	3-1/2 (2 to 3-1/2)	5 (3 to 5)	3-1/2 (2 to 3-1/2)	3-1/2 (2 to 3-1/2)	C	CE - C - 1/4 X 1/2 X 1/4 SAE ECE - C - 3/8 X 1/2 X 1/4 ODF SCE - C - 3/8 X 1/2 X 1/4 ODF
5 (3 to 5)	8 (5 to 8)	5 (3 to 5)	5 (3 to 5)	6 (3-1/2 to 6)	6 (3-1/2 to 6)	8 (5 to 8)	6 (3-1/2 to 6)	6 (3-1/2 to 6)	D	ECE - D - 3/8 X 1/2 X 1/4 ODF

*See Pages 5 through 8 for Valve Assembly Dimensions.

Body Nomenclature (Example)

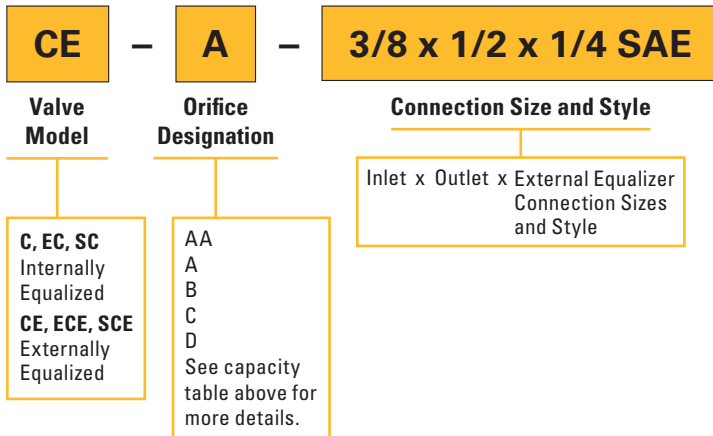

C Series Interchangeable Valve

■ Element

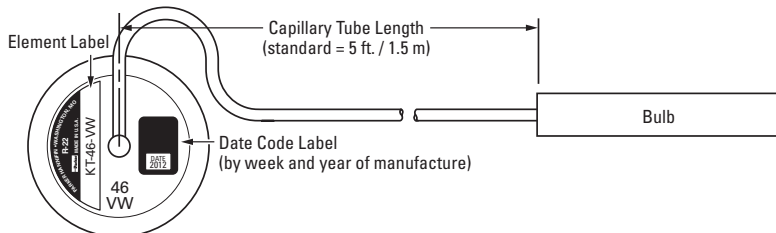

Element Nomenclature (Example)

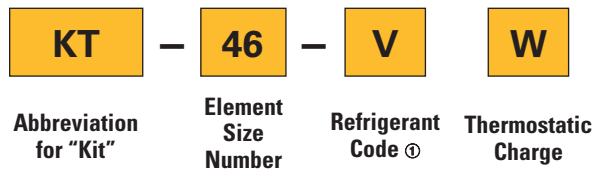

① While many new refrigerants and refrigerant blends have a unique letter code, many use the same thermostatic element as the traditional refrigerant they replace. Refer to the table below to select the correct thermostatic element.

Recommended Thermostatic Valve Charges**

Application	Applicable Evaporator Temperature Range	Refrigerants			
		22 407C	12 134a	502 404A	410A
Low Temperature Refrigeration	-40°F to 0°F	VZ	–	SZ	–
Commercial Refrigeration	-30°F to +60°F	VW	JW	SW	–
Low Temperature Pressure Limiting	-40°F to +0°F	VX35	–	SX35	–
Commercial Pressure Limiting	-10°F to +60°F	VX100	JX60	–	ZX200
Air Conditioning	+30°F to +60°F	VX100	JX60	–	ZX200

Rainbow Charge Refrigerant Designation

J	R-134a, R-401A (MP39), R-401B (MP66), R-12
V	R-407C (AC9000), R-22
S	R-125, R-404A (HP62), R-402A (HP80), R-402B (HP81), R-507 (AZ50)
Z	R-410A (AZ20)

Refrigerant Color Code

- R-12 - yellow
- R-134a - light blue
- R-22 - green
- R-402A - light brown (sand)
- R-402B - olive
- R-404A - orange
- R-407C - medium brown
- R-410A - rose
- R-502 - purple
- R-507 - teal

**Application Factors:

1. The Type "X" thermostatic charges have essentially the same characteristics as the conventional Z cross charges with one exception: they produce a pressure limit or MOP. The "X" charges are not intended as replacements for the Z charges - they should only be used where a definite pressure limit is required to prevent motor overloading.
2. All air conditioning and heat pump charges are intended for use with externally equalized valves.
3. For dual temperature applications, use the "W" charge.
4. The "W" charge may be used on applications down to -30°F (-34°C) on R-22, R-404A and R-507.
5. R-410A elements for use with ECE only.

†Charge Type

"W" (all-purpose) liquid charge maintains nearly flat superheat control over a -10°F to +60°F (-23°C to +15°C) evaporator temperature range.

"Z" (low temperature) charge provides fast pulldown benefits like a gas charge with the non-migrating benefits of a liquid charge; usable over a -40°F to 0°F (-40°C to -18°C) evaporator temperature range.

"X" (damped response) gas charge provides a pressure limiting (MOP) charge with anti-hunt characteristics over a -40°F to +60°F (-40°C to +15°C) evaporator temperature range.

Notes: M.O.P. not available on "W" or "Z" charge.

1. Maximum operational pressure 500 psig (35 bar) high side and 275 psig (19 bar) low side.
 2. Maximum storage temperature 130°F (55°C).
 3. Consult Parker for pressure and temperature exceptions.
 4. Do not use "W" or "Z" liquid charges in applications where bulb temperatures can exceed 130°F (55°C).
- For these applications use type "X" MOP gas charge **only**.

H Series and HC Series

The H series balanced port valve is designed specifically for air conditioning and heat pumps used in both air or water source systems. It offers features such as bleed ports and a variety of connection styles for the inlet, outlet and external equalizer.

The HC series adds a built-in 5 ton check valve for R-22, R-407C and R-410A heat pump applications with either factory set or field adjustable superheat.

Applications

- Air Conditioning Systems
- Heat Pump Systems
- Bi-flow (package) Heat Pump Systems

Features and Benefits

- Stainless steel power element
- Bleed ports available
- Bi-directional metering available
- Weight: 10.7 oz. (.30 kg)
- Factory set or field adjustable
- Low pressure drop internal check valve



Specifications

Refrigerant	Refrigerant Designation	Nominal Capacity (Tons)	Valve Description		Rainbow Charges™	Bleed Port for Off Cycle Operation (Optional)	Connections - (Inches)			
			Internally Equalized	Externally Equalized			Inlet	Outlet		
R-22 R-407C	V	1-1/2	HA 1-1/2V	HAE 1-1/2V	X100	B	1/4, 3/8, 1/2 & 5/8 ODF flo-rater	3/8, 1/2, 5/8 & 7/8 ODF flo-rater		
		3	HA 3V	HAE 3V						
		5	HA 5V	HAE 5V						
		models with internal check valves - "C" designation								
		1-1/2	HCA 1-1/2V	HCAE 1-1/2V	X100	B	1/4, 3/8, 1/2 & 5/8 ODF flo-rater	3/8, 1/2, 5/8 & 7/8 ODF flo-rater		
		3	HCA 3V	HCAE 3V						
5	HCA 5V	HCAE 5V								
R-410A	Z	1-1/2	HA 1-1/2Z	HAE 1-1/2Z	X200	B	1/4, 3/8, 1/2 & 5/8 ODF flo-rater	3/8, 1/2, 5/8 & 7/8 ODF flo-rater		
		3	HA 3Z	HAE 3Z						
		5	HA 5Z	HAE 5Z						
		specific models with internal check valves - "C" designation								
		1-1/2	HCA 1-1/2Z	HCAE 1-1/2Z	X200	B	1/4, 3/8, 1/2 & 5/8 ODF flo-rater	3/8, 1/2, 5/8 & 7/8 ODF flo-rater		
		2	HCA 2Z	HCAE 2Z						
3	HCA 3Z	HCAE 3Z								
5	HCA 5Z	HCAE 5Z								

H Series and HC Series

Dimensions

Connections ODF

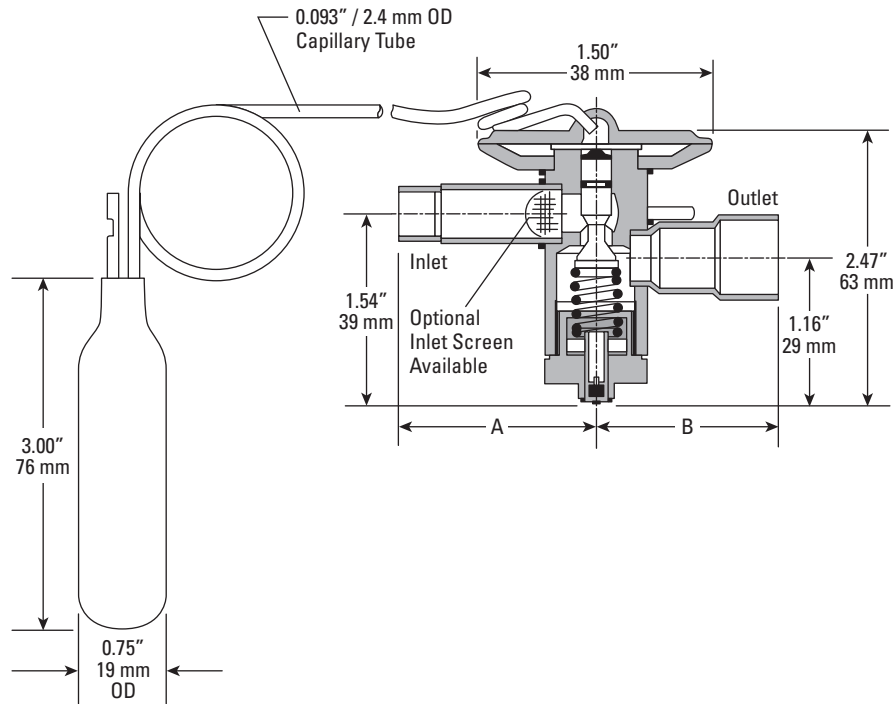

Fitting Size Inlet/Outlet	A	B
1/4	1.46" 37 mm	1.46" 37 mm
3/8	1.69" 43 mm	1.69" 43 mm
1/2	1.46 37 mm	1.46 37 mm
5/8	1.57" 40 mm	1.57" 40 mm
7/8	—	2.07" 53 mm

Dimensions

Connections – flo-rater

Inlet 3/4" – 20

Outlet 3/4" – 20

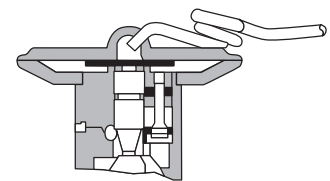
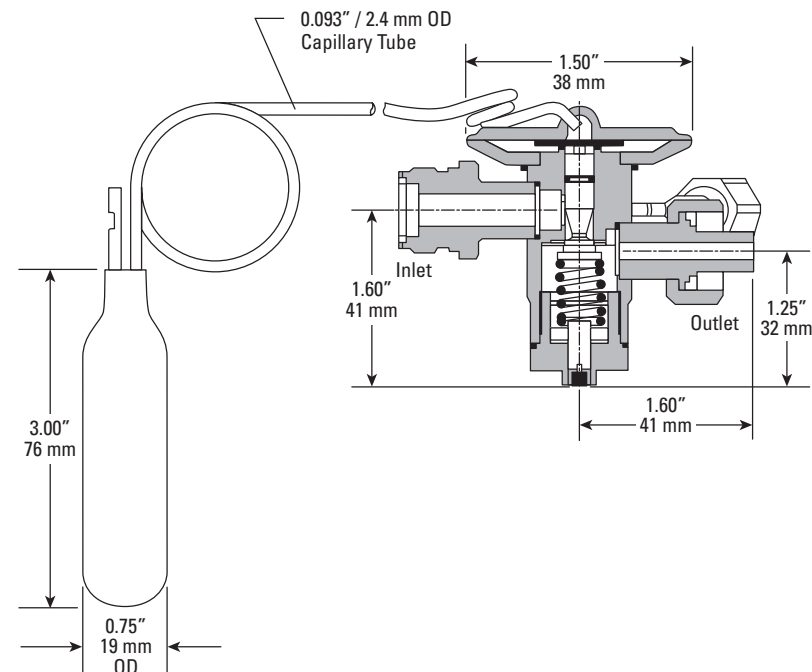

Check Valve Section
Allows reverse flow in heating mode.

EBSE Series

The EBSE series valve is a brass bar body valve and features a balanced port construction and extended ODF connections. The thermostatic element is replaceable. The balanced port construction makes this valve ideally suited for air conditioning and commercial refrigeration applications which operate over widely varying conditions.

Applications

- Air Conditioning
- Commercial Refrigeration

Features and Benefits

- Balanced port design
- Removable power element
- Field adjustable superheat
- 1/4" sweat external equalizer



Specifications

Refrigerant	Refrigerant Designation	Nominal Capacity (Tons)	Valve Description	Rainbow Charges™	Standard Tubing Length Feet (m)	Connection - (Inches)		External Equalizer Connection (Inches)
						Inlet	Outlet	
R-12	J	5	EBSE-5-J	W	5 (1.5)	5/8 ODF	7/8 ODF	1/4 ODF
R-134a		7	EBSE-7-J			7/8 ODF	1-1/8 ODF	
R-401A		9	EBSE-9-J				1-3/8 ODF	
R-401B		12	EBSE-12-J					
R-402A	S	6	EBSE-6-S	W Z X35	5 (1.5)	5/8 ODF	7/8 ODF	1/4 ODF
R-402B		7-1/2	EBSE-7-1/2-S			7/8 ODF	1-1/8 ODF	
R-404A		10	EBSE-10-S				1-3/8 ODF	
R-502		13	EBSE-13-S					
R-507								
R-22	V	8	EBSE-8-V	W X100	5 (1.5)	5/8 ODF	7/8 ODF	1/4 ODF
R-407C		11	EBSE-11-V			7/8 ODF	1-1/8 ODF	
R-422D		15	EBSE-15-V				1-3/8 ODF	
		20	EBSE-20-V					

Dimensions

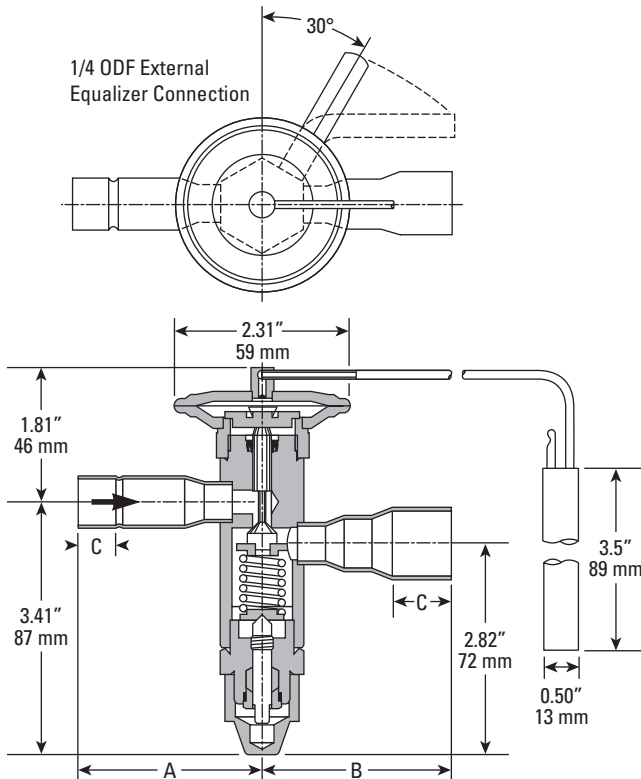

Fitting Size	A	B	C
5/8	2.46" / 62 mm	—	.50" / 13 mm
7/8	2.46" / 62 mm	2.53" / 64 mm	.75" / 19 mm
1-1/8	—	2.53" / 64 mm	.81" / 21 mm
1-3/8	—	3.04" / 77 mm	.97" / 25 mm

Replacement Elements

Refrigerant Designation	Element
V	KT-83-VW KT-83-VX100
J	KT-83-JW
S	KT-83-SW KT-83-SZ KT-83-SX35

OE Series

The OE series valve utilizes balanced port construction to provide optimum operation on medium to large tonnage air conditioning and refrigeration systems. Two brass body styles with copper ODF connections and a removable thermostatic power element provide the stability and control required in a variety of applications, especially where there are wide changes in load conditions. Body Style 1 has an R-22 nominal capacity up to 30 tons, while Body Style 2 extends the capacity range to 70 tons.



Applications

- Air Conditioning
- Process Chillers
- Commercial Refrigeration

Features and Benefits

- Balanced port design
- Removable power element
- Field adjustable superheat
- 1/4" sweat external equalizer
- 60" capillary tube

Specifications

Refrigerant	Refrigerant Designation	Nominal Capacity (Tons)	Valve Description	Rainbow Charges™	Standard Tubing Length Feet (m)	Connection - (Inches)		External Equalizer Connection (Inches)
						Inlet	Outlet	
R-12 R-134a R-401A R-401B	J	9	OE-9-J	W	5 (1.5)	7/8 ODF	1-1/8 ODF	1/4 ODF
		12	OE-12-J				1-1/8 ODF	
		16	OE-16-J					
		23	OE-23-J					
		32	OE-32-J					
40	OE-40-J							
R-402A R-402B R-404A R-502 R-507	S	9	OE-9-S	W Z X35	5 (1.5)	7/8 ODF	1-1/8 ODF	1/4 ODF
		12	OE-12-S				1-1/8 ODF	
		21	OE-21-S					
		30	OE-30-S					
		35	OE-35-S					
45	OE-45-S							
R-22 R-407C R-422D	V	15	OE-15-V	W X110	5 (1.5)	7/8 ODF	1-1/8 ODF	1/4 ODF
		20	OE-20-V				1-1/8 ODF	
		30	OE-30-V					
		40	OE-40-V					
		55	OE-55-V					
70	OE-70-V							
R-410A	Z	20	OE-20-Z	X200	5 (1.5)	7/8 ODF	1-3/8 ODF	1/4 ODF
		25	OE-25-Z					
		35	OE-35-Z					
		50	OE-50-Z					
60	OE-60-Z							

OE Series

Dimensions – Inches

Type OE with Number 83 & 85 Element

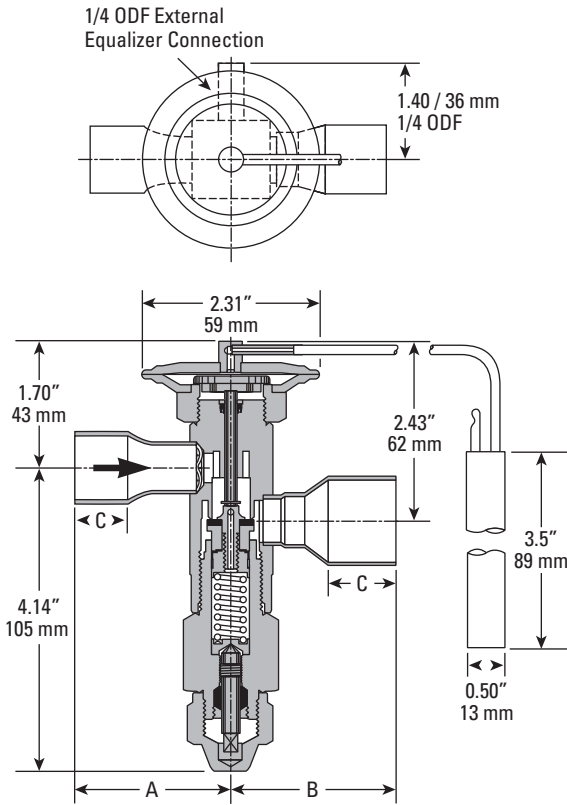

Fitting Size Straight Thru ODF Solder	A	B	C
7/8	2.09" 53 mm	—	0.75" 19 mm
1-1/8	2.21" 56 mm	2.23" 57 mm	0.91" 23 mm
1-3/8	—	2.39" 61 mm	0.97" 25 mm

Type OE with Number 33 & 85-3 Element

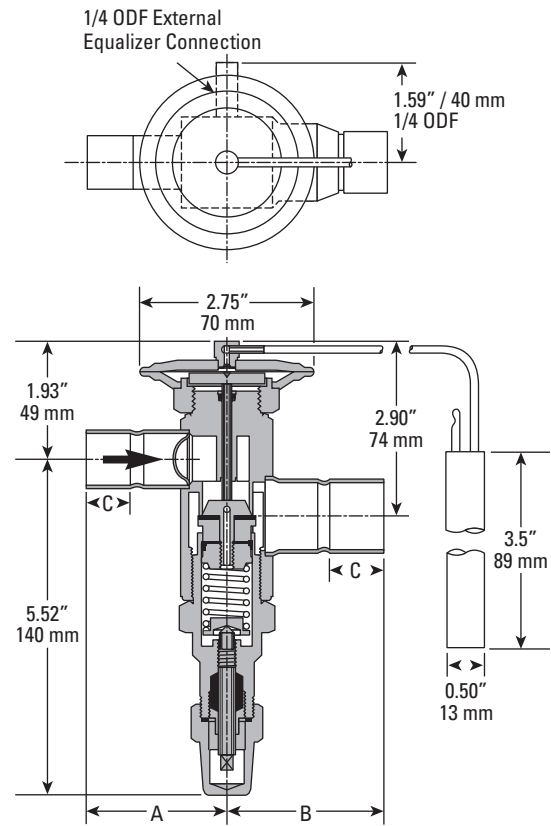

Fitting Size Straight Thru ODF Solder	A	B	C
7/8	2.09" 53 mm	—	0.78" 20 mm
1-1/8	2.69" 68 mm	—	0.91" 23 mm
1-3/8	—	2.84" 72 mm	0.97" 25 mm
1-5/8	—	3.12" 79 mm	1.09" 28 mm

Replacement Elements

Refrigerant Designation	Element	
V	KT-83-VW KT-83-VX100	KT-33-VW KT-33-VX100
Z	KT-85-ZX200	KT-85-3-ZX200
S	KT-83-SW KT-83-SZ KT-83-SX35	KT-33-SW KT-33-SZ KT-33-SX35
J	KT-83-JW	KT-33-JW

Capacity Tables

R-22 Capacities in Tons (R-407C Refrigerant & Liquid Temperature Correction Factor below)

Valve Type	Nominal Capacity (Tons) or Orifice Designation	Evaporator Temperature °F																							
		40°F								20°F								0°F							
		Pressure Drop (PSI)																							
		75	100	125	150	175	200	225	250	75	100	125	150	175	200	225	250	75	100	125	150	175	200	225	250
N	1	0.87	1.0	1.1	1.2	1.3	1.4	1.5	1.6	0.85	0.98	1.1	1.2	1.3	1.4	1.5	1.5	0.75	0.87	0.97	1.1	1.2	1.2	1.3	1.4
N	3	2.6	3.0	3.4	3.7	4.0	4.3	4.5	4.7	2.5	2.9	3.3	3.6	3.9	4.1	4.4	4.6	2.3	2.6	2.9	3.2	3.5	3.7	3.9	4.1
H(E), HC(E)	1-1/2	1.3	1.5	1.7	1.8	2.0	2.1	2.3	2.4	1.3	1.5	1.6	1.8	1.9	2.1	2.2	2.3	1.1	1.3	1.5	1.6	1.8	1.9	2.0	2.1
H(E), HC(E)	3	2.6	3.0	3.4	3.7	4.0	4.2	4.4	4.5	2.6	2.9	3.3	3.6	3.9	4.2	4.3	4.4	2.3	2.6	3.0	3.2	3.5	3.7	3.8	3.9
H(E), HC(E)	5	4.3	5.0	5.6	6.1	6.6	7.1	7.2	7.3	4.2	4.9	5.5	6.0	6.5	6.9	7.0	7.1	3.8	4.4	4.9	5.4	5.8	6.2	6.3	6.4
SCE	AAA	0.30	0.35	0.39	0.43	0.46	0.50	0.53	0.55	0.30	0.34	0.38	0.42	0.45	0.48	0.51	0.54	0.26	0.30	0.33	0.37	0.40	0.42	0.45	0.47
C(E), EC(E), SCE	AA	0.52	0.60	0.67	0.73	0.79	0.85	0.90	0.95	0.51	0.58	0.65	0.72	0.77	0.83	0.88	0.92	0.44	0.51	0.57	0.63	0.68	0.72	0.77	0.81
C(E), EC(E), SCE	A	1.5	1.8	2.0	2.1	2.3	2.5	2.6	2.8	1.5	1.7	1.9	2.1	2.3	2.4	2.6	2.7	1.3	1.5	1.7	1.9	2.0	2.2	2.3	2.4
C(E), EC(E), SCE	B	2.8	3.2	3.6	3.9	4.2	4.5	4.8	5.1	2.7	3.1	3.5	3.8	4.1	4.4	4.7	4.9	2.4	2.8	3.1	3.4	3.7	3.9	4.2	4.4
C(E), EC(E), SCE	C	4.3	5.0	5.6	6.1	6.6	7.1	7.5	7.9	4.2	4.9	5.5	6.0	6.5	6.9	7.3	7.7	3.8	4.4	4.9	5.3	5.8	6.2	6.5	6.9
C(E), EC(E), SCE	D	6.9	8.0	9.0	9.8	10.6	11.3	12.0	12.7	6.8	7.8	8.7	9.6	10.3	11.0	11.7	12.3	6.0	7.0	7.8	8.5	9.2	9.9	10.5	11.0
EBSE	8	7.4	8.5	9.5	10.4	11.2	12.0	12.8	13.4	6.8	7.9	8.8	9.6	10.4	11.1	11.8	12.4	5.7	6.5	7.3	8.0	8.6	9.2	9.8	10.3
EBSE	11	10.0	11.5	12.9	14.1	15.2	16.3	17.3	18.2	9.2	10.7	11.9	13.0	14.1	15.1	16.0	16.8	7.6	8.8	9.9	10.8	11.7	12.5	13.2	14.0
EBSE	15	13.4	15.5	17.3	18.9	20.5	21.9	23.2	24.4	12.6	14.6	16.3	17.8	19.3	20.6	21.9	23.0	9.4	10.9	12.2	13.3	14.4	15.4	16.3	17.2
EBSE	20	19.3	22.3	25.0	27.4	29.5	31.6	33.5	35.3	17.7	20.4	22.8	25.0	27.0	28.9	30.6	32.3	13.1	15.1	16.9	18.5	20.0	21.4	22.7	23.9
OE	15	13.0	15.0	16.8	18.4	19.8	21.2	22.5	23.7	12.0	13.9	15.5	17.0	18.4	19.6	20.8	22.0	10.1	11.7	13.0	14.3	15.4	16.5	17.5	18.4
OE	20	19.2	22.2	24.8	27.2	29.4	31.4	33.3	35.1	17.8	20.6	23.0	25.2	27.2	29.1	30.8	32.5	14.9	17.2	19.3	21.1	22.8	24.4	25.9	27.3
OE	30	26.4	30.5	34.1	37.4	40.4	43.1	45.8	48.2	24.5	28.2	31.6	34.6	37.4	39.9	42.4	44.7	20.5	23.7	26.5	29.0	31.3	33.5	35.5	37.5
OE	40	34.9	40.3	45.1	49.4	53.3	57.0	60.5	63.7	33.7	38.9	43.5	47.6	51.5	55.0	58.3	61.5	24.8	28.6	32.0	35.1	37.9	40.5	42.9	45.3
OE	55	47.6	55.0	61.5	67.4	72.8	77.8	82.5	87.0	46.0	53.1	59.3	65.0	70.2	75.1	79.6	83.9	33.8	39.1	43.7	47.9	51.7	55.3	58.6	61.8
OE	70	63.2	73.0	81.6	89.4	96.6	103	110	115	61.0	70.5	78.8	86.3	93.2	99.6	106	111	44.9	51.9	58.0	63.5	68.6	73.3	77.8	82.0

These ratings are based on vapor free 100°F liquid refrigerant entering the expansion valve, and a maximum of 7°F change in superheat.

Refrigerant	Liquid Temperature Entering TEV							
	0°F	20°F	40°F	60°F	80°F	100°F	120°F	140°F
	Correction Factor							
R-22	1.57	1.45	1.34	1.23	1.12	1.00	0.88	0.76
R-407C	1.58	1.45	1.32	1.18	1.04	0.89	0.74	0.57

These factors include corrections for liquid refrigerant density and net refrigerating effect, and are based on an evaporator temperature of 0°F. However, they may be used for any evaporator temperature from 0°F to 40°F since the variation in the actual factors across this range is insignificant.

TEV Capacity = TEV Rating x CF Liquid Temperature – Example: Actual capacity of an SCE-B using R-407C at a 40°F evaporator, 125 psi pressure drop across the TEV, and a 80°F liquid temperature entering the TEV = 3.58 (from rating chart) x 1.04 (CF liquid temperature) = 3.72 tons

R-22 Capacities in Kilowatts (R-407C Refrigerant & Liquid Temperature Correction Factor below)

Valve Type	Nominal Capacity (kW) or Orifice Designation	Evaporator Temperature °C																							
		5°C						-5°C						-15°C											
		Pressure Drop (BAR)																							
		4	6	8	10	12	14	16	18	4	6	8	10	12	14	16	18	4	6	8	10	12	14	16	18
N	4	2.6	3.2	3.7	4.2	4.5	4.9	5.3	5.6	2.6	3.1	3.6	4.1	4.4	4.8	5.1	5.4	2.4	2.9	3.3	3.7	4.1	4.4	4.7	5.0
N	11	7.9	9.7	11.2	12.5	13.6	14.7	15.8	16.7	7.7	9.4	10.9	12.2	13.3	14.3	15.4	16.3	7.0	8.6	9.9	11.2	12.2	13.1	14.1	14.9
H(E), HC(E)	5	4.0	4.9	5.7	6.4	7.0	7.5	8.0	8.5	3.9	4.8	5.6	6.2	6.8	7.4	7.9	8.3	3.6	4.4	5.0	5.6	6.2	6.7	7.1	7.6
H(E), HC(E)	11	8.0	9.8	11.4	12.7	13.9	15.0	16.1	17.0	7.9	9.6	11.1	12.4	13.6	14.7	15.7	16.7	7.1	8.7	10.1	11.3	12.3	13.3	14.3	15.1
H(E), HC(E)	18	13.4	16.4	18.9	21.2	23.2	25.1	26.8	28.4	13.1	16.1	18.5	20.7	22.7	24.5	26.2	27.7	11.9	14.6	16.8	18.8	20.6	22.2	23.8	25.2
SCE	AAA	0.92	1.1	1.3	1.5	1.6	1.7	1.8	2.0	0.90	1.1	1.3	1.4	1.6	1.7	1.8	1.9	0.81	0.99	1.1	1.3	1.4	1.5	1.6	1.7
C(E), EC(E), SCE	AA	1.6	1.9	2.2	2.5	2.7	2.9	3.1	3.3	1.5	1.9	2.2	2.4	2.7	2.9	3.1	3.3	1.4	1.7	2.0	2.2	2.4	2.6	2.8	2.9
C(E), EC(E), SCE	A	4.6	5.6	6.5	7.3	8.0	8.6	9.2	9.7	4.5	5.5	6.3	7.1	7.8	8.4	9.0	9.5	4.1	5.0	5.8	6.5	7.1	7.7	8.2	8.7
C(E), EC(E), SCE	B	8.4	10.3	11.9	13.3	14.5	15.7	16.8	17.8	8.2	10.0	11.6	13.0	14.2	15.3	16.4	17.4	7.5	9.2	10.6	11.9	13.0	14.0	15.0	15.9
C(E), EC(E), SCE	C	13.1	16.1	18.5	20.7	22.7	24.5	26.2	27.8	12.8	15.7	18.1	20.3	22.2	24.0	25.6	27.2	11.7	14.4	16.6	18.6	20.3	22.0	23.5	24.9
C(E), EC(E), SCE	D	21.0	25.7	29.7	33.2	36.3	39.2	42.0	44.5	20.5	25.1	29.0	32.4	35.5	38.3	41.0	43.5	18.8	23.0	26.5	29.7	32.5	35.1	37.5	39.8
EBSE	28	22.4	27.4	31.6	35.4	38.7	41.8	44.7	47.4	20.9	25.5	29.5	33.0	36.1	39.0	41.7	44.2	17.9	22.0	25.3	28.3	31.0	33.5	35.8	38.0
EBSE	39	30.3	37.0	42.8	47.8	52.4	56.6	60.5	64.2	28.2	34.6	39.9	44.6	48.9	52.8	56.4	59.9	24.3	29.7	34.3	38.3	42.0	45.4	48.5	51.4
EBSE	53	40.6	49.8	57.5	64.2	70.4	76.0	81.3	86.2	38.5	47.1	54.4	60.9	66.7	72.0	77.0	81.6	30.9	37.8	43.6	48.8	53.5	57.7	61.7	65.5
EBSE	70	58.8	72.0	83.1	92.9	102	110	118	125	54.2	66.4	76.7	85.7	93.9	101	108	115	43.0	52.6	60.8	67.9	74.4	80.4	85.9	91.2
OE	53	39.5	48.3	55.8	62.4	68.3	73.8	78.9	83.7	36.8	45.1	52.0	58.2	63.7	68.9	73.6	78.1	31.9	39.1	45.1	50.5	55.3	59.7	63.8	67.7
OE	70	58.4	71.5	82.6	92.3	101	109	117	124	54.5	66.7	77.0	86.1	94.3	102	109	116	47.2	57.8	66.8	74.7	81.8	88.4	94.5	100
OE	105	80.2	98.3	113	127	139	150	160	170	74.8	91.6	106	118	130	140	150	159	64.9	79.5	91.8	103	112	121	130	138
OE	141	106	130	150	167	183	198	212	224	102	125	145	162	177	192	205	217	81.5	99.8	115	129	141	152	163	173
OE	193	144	177	204	228	250	270	289	306	140	171	198	221	242	261	279	296	111	136	157	176	193	208	222	236
OE	246	192	235	271	303	332	359	383	407	185	227	262	293	321	347	371	393	148	181	209	233	256	276	295	313

These ratings are based on vapor free 40°C liquid refrigerant entering the expansion valve, and a maximum of 4°C change in superheat.

Refrigerant	Liquid Temperature Entering TEV							
	-10°C	0°C	10°C	20°C	30°C	40°C	50°C	60°C
	Correction Factor							
R-22	1.52	1.42	1.32	1.21	1.11	1.00	0.89	0.78
R-407C	1.53	1.41	1.28	1.15	1.02	0.88	0.74	0.59

These factors include corrections for liquid refrigerant density and net refrigerating effect, and are based on an evaporator temperature of -15°C. However, they may be used for any evaporator temperature from -15°C to 5°C since the variation in the actual factors across this range is insignificant.

TEV Capacity = TEV Rating x CF Liquid Temperature – Example: Actual capacity of an SCE-B using R-407C at a 5°C evaporator, 8 bar pressure drop across the TEV, and a 30°C liquid temperature entering the TEV = 12.1 (from rating chart) x 1.02 (CF liquid temperature) = 12.3 kW

Capacity Tables

R-134a Capacities in Tons (R-401A, R-409A Refrigerant & Liquid Temperature Correction Factor below)

Valve Type	Nominal Capacity (Tons) or Orifice Designation	Evaporator Temperature °F																							
		40°F						20°F						0°F											
		Pressure Drop (PSI)																							
		40	60	80	100	120	140	160	180	40	60	80	100	120	140	160	180	40	60	80	100	120	140	160	180
N	1/2	0.59	0.72	0.83	0.93	1.0	1.1	1.2	1.3	0.56	0.69	0.79	0.89	0.98	1.1	1.1	1.2	0.49	0.61	0.70	0.78	0.85	0.92	0.99	1.1
N	2	1.8	2.2	2.5	2.8	3.1	3.3	3.5	3.8	1.7	2.1	2.4	2.7	2.9	3.1	3.4	3.6	1.5	1.8	2.1	2.3	2.6	2.8	3.0	3.1
C(E), EC(E), SCE	AA	0.35	0.43	0.50	0.56	0.61	0.66	0.70	0.74	0.34	0.41	0.47	0.53	0.58	0.63	0.67	0.71	0.32	0.39	0.45	0.50	0.55	0.60	0.64	0.68
C(E), EC(E), SCE	A	1.0	1.3	1.5	1.6	1.8	1.9	2.1	2.2	0.99	1.2	1.4	1.6	1.7	1.8	2.0	2.1	0.86	1.1	1.2	1.4	1.5	1.6	1.7	1.8
C(E), EC(E), SCE	B	1.9	2.3	2.7	3.0	3.3	3.5	3.8	4.0	1.8	2.2	2.6	2.9	3.1	3.4	3.6	3.8	1.6	1.9	2.2	2.5	2.7	3.0	3.2	3.4
C(E), EC(E), SCE	C	3.0	3.6	4.2	4.7	5.1	5.5	5.9	6.3	2.8	3.5	4.0	4.5	4.9	5.3	5.6	6.0	2.5	3.0	3.5	3.9	4.3	4.6	4.9	5.2
C(E), EC(E), SCE	D	4.7	5.8	6.7	7.5	8.2	8.8	9.4	10.0	4.5	5.5	6.4	7.1	7.8	8.4	9.0	9.6	3.9	4.8	5.6	6.2	6.8	7.4	7.9	8.4
EBSE	5	5.0	6.1	7.1	7.9	8.7	9.4	10.0	10.6	4.0	4.9	5.6	6.3	6.9	7.4	7.9	9.4	3.4	4.2	4.8	5.4	5.9	6.4	6.8	7.2
EBSE	7	6.9	8.4	9.7	10.9	11.9	12.9	13.8	14.6	5.5	6.7	7.7	8.6	9.5	10.2	10.9	11.6	4.7	5.8	6.6	7.4	8.1	8.8	9.4	10.0
EBSE	9	9.1	11.2	12.9	14.4	15.8	17.1	18.2	19.4	6.9	8.4	9.7	10.9	11.9	12.9	13.7	14.6	5.5	6.8	7.8	8.7	9.6	10.3	11.0	11.7
EBSE	12	13.1	16.0	18.5	20.7	22.6	24.4	26.1	27.7	9.9	12.1	14.0	15.6	17.1	18.5	19.7	20.9	7.7	9.5	10.9	12.2	13.4	14.5	15.4	16.4
OE	9	8.9	10.8	12.5	14.0	15.3	16.6	17.7	18.8	7.6	9.3	10.8	12.0	13.2	14.2	15.2	16.1	6.6	8.1	9.3	10.4	11.4	12.6	13.2	14.0
OE	12	11.5	14.1	16.3	18.2	19.9	21.5	23.0	24.4	9.9	12.1	14.0	15.6	17.1	18.5	19.8	21.0	8.6	10.5	12.1	13.6	14.9	16.0	17.1	18.2
OE	16	15.2	18.7	21.6	24.1	26.4	28.5	30.5	32.3	13.1	16.0	18.5	20.7	22.7	24.5	26.2	27.8	11.4	13.9	16.1	18.0	19.7	21.3	22.7	24.1
OE	23	22.6	27.7	32.0	35.8	39.2	42.3	45.2	48.0	21.2	25.9	29.9	33.5	36.7	39.6	42.3	44.9	17.5	21.4	24.7	27.6	30.3	32.7	34.9	37.1
OE	32	31.5	38.6	44.5	49.8	54.5	58.9	63.0	66.8	29.5	36.1	41.7	46.6	51.0	55.1	58.9	62.5	24.3	29.8	34.4	38.4	42.1	45.5	48.6	51.6
OE	40	39.3	48.2	55.6	62.2	68.1	73.6	78.7	83.5	36.8	45.1	52.1	58.2	63.8	68.9	73.6	78.1	30.4	37.2	43.0	48.0	52.6	56.9	60.8	64.5

These ratings are based on vapor free 100°F liquid refrigerant entering the expansion valve, and a maximum of 7°F change in superheat.

Refrigerant	Liquid Temperature Entering TEV							
	0°F	20°F	40°F	60°F	80°F	100°F	120°F	140°F
	Correction Factor							
R-134a	1.69	1.56	1.42	1.29	1.14	1.00	0.85	0.71
R-401A	1.75	1.62	1.49	1.36	1.23	1.09	0.95	0.81
R-409A	1.65	1.54	1.42	1.31	1.19	1.06	0.94	0.81

These factors include corrections for liquid refrigerant density and net refrigerating effect, and are based on an evaporator temperature of 0°F. However, they may be used for any evaporator temperature from 0°F to 40°F since the variation in the actual factors across this range is insignificant.

TEV Capacity = TEV Rating x CF Liquid Temperature – Example: Actual capacity of an SCE-B using R-409A at a 20°F evaporator, 120 psi pressure drop across the TEV, and a 80°F liquid temperature entering the TEV = 3.12 (from rating chart) x 1.19 (CF liquid temperature) = 3.72 tons

R-134a Capacities in Kilowatts (R-401A, R-409A Refrigerant & Liquid Temperature Correction Factor below)

Valve Type	Nominal Capacity (kW) or Orifice Designation	Evaporator Temperature °C																							
		5°C						-5°C						-15°C											
		Pressure Drop (BAR)																							
		2.5	4.0	5.5	7.0	8.5	10.0	11.5	13.0	2.5	4.0	5.5	7.0	8.5	10.0	11.5	13.0	2.5	4.0	5.5	7.0	8.5	10.0	11.5	13.0
N	3	1.9	2.4	2.9	3.2	3.6	3.9	4.1	4.4	1.9	2.3	2.7	3.1	3.4	3.7	4.0	4.2	1.7	2.1	2.5	2.8	3.1	3.3	3.6	3.8
N	7	5.8	7.3	8.6	9.7	10.7	11.5	12.4	13.2	5.5	7.0	8.2	9.3	10.2	11.1	11.9	12.7	5.0	6.3	7.4	8.3	9.2	9.9	10.7	11.3
C(E), EC(E), SCE	AA	1.2	1.5	1.7	1.9	2.1	2.3	2.5	2.6	1.1	1.4	1.6	1.8	2.0	2.2	2.4	2.5	1.1	1.3	1.6	1.8	1.9	2.1	2.3	2.4
C(E), EC(E), SCE	A	3.4	4.3	5.0	5.6	6.2	6.7	7.2	7.7	3.2	4.1	4.8	5.4	6.0	6.5	6.9	7.4	2.9	3.7	4.3	4.9	5.4	5.8	6.2	6.6
C(E), EC(E), SCE	B	6.2	7.8	9.2	10.3	11.4	12.3	13.2	14.1	5.9	7.5	8.8	9.9	10.9	11.8	12.7	13.5	5.3	6.7	7.9	8.9	9.8	10.6	11.4	12.1
C(E), EC(E), SCE	C	9.6	12.2	14.3	16.1	17.8	19.3	20.7	22.0	9.2	11.7	13.7	15.5	17.0	18.5	19.8	21.1	8.3	10.5	12.3	13.9	15.3	16.6	17.8	18.9
C(E), EC(E), SCE	D	15.4	19.5	22.9	25.8	28.4	30.8	33.1	35.2	14.8	18.7	21.9	24.7	27.3	29.6	31.7	33.7	13.3	16.8	19.7	22.2	24.5	26.5	28.5	30.3
EBSE	18	16.5	20.8	24.4	27.6	30.4	33.0	35.3	37.6	13.4	17.0	19.9	22.5	24.7	26.8	28.8	30.6	11.6	14.6	17.1	19.3	21.3	23.1	24.8	26.3
EBSE	25	22.7	28.7	33.7	38.0	41.9	45.4	48.7	51.8	18.5	23.4	27.4	30.9	34.1	37.0	39.7	42.2	15.9	20.1	23.6	26.6	29.4	31.9	34.2	36.3
EBSE	32	30.2	38.2	44.7	50.5	55.6	60.3	64.7	68.8	23.5	29.7	34.9	39.3	43.3	47.0	50.4	53.6	19.1	24.1	28.3	31.9	35.2	38.2	40.9	43.5
EBSE	42	43.2	54.6	64.1	72.3	79.6	86.4	92.6	98.5	33.7	42.7	50.0	56.4	62.2	67.4	72.3	76.9	26.9	34.0	39.9	45.0	49.6	53.8	57.7	61.4
OE	32	29.1	36.8	43.2	48.7	53.7	58.2	62.4	66.4	25.4	32.2	37.7	42.6	46.9	50.9	54.6	58.0	22.3	28.3	33.1	37.4	41.2	44.7	47.9	50.9
OE	42	37.8	47.9	56.1	63.3	69.8	75.7	81.2	86.3	33.1	41.8	49.0	55.3	61.0	66.1	70.9	75.4	29.0	36.7	43.1	48.6	53.5	58.1	62.3	66.2
OE	56	50.1	63.4	74.4	83.9	92.4	100	108	114	43.8	55.4	65.0	73.3	80.8	87.6	93.9	100	38.5	48.7	57.1	64.4	70.9	76.9	82.5	87.7
OE	81	74.1	93.7	110	124	137	148	159	169	69.8	88.3	104	117	129	140	150	159	60.0	75.9	89.0	100	111	120	129	137
OE	110	103	130	153	172	190	206	221	235	97.2	123	144	163	179	194	208	222	83.4	106	124	140	154	167	179	190
OE	140	129	163	191	216	238	258	276	294	121	154	180	203	224	243	260	277	104	132	155	175	192	209	224	238

These ratings are based on vapor free 40°C liquid refrigerant entering the expansion valve, and a maximum of 4°C change in superheat.

Refrigerant	Liquid Temperature Entering TEV							
	-10°C	0°C	10°C	20°C	30°C	40°C	50°C	60°C
	Correction Factor							
R-134a	1.64	1.52	1.39	1.26	1.13	1.00	0.87	0.73
R-401A	1.70	1.59	1.46	1.34	1.22	1.09	0.96	0.83
R-409A	1.61	1.50	1.40	1.29	1.18	1.07	0.95	0.83

These factors include corrections for liquid refrigerant density and net refrigerating effect, and are based on an evaporator temperature of -15°C. However, they may be used for any evaporator temperature from -15°C to 5°C since the variation in the actual factors across this range is insignificant.

TEV Capacity = TEV Rating x CF Liquid Temperature – Example: Actual capacity of an SCE-B using R-409A at a -5°C evaporator, 8.5 bar pressure drop across the TEV, and a 30°C liquid temperature entering the TEV = 11.2 (from rating chart) x 1.18 (CF liquid temperature) = 13.2 kW

Capacity Tables

R-404A Capacities in Tons (R-507 Refrigerant & Liquid Temperature Correction Factor below)

Valve Type	Nominal Capacity (Tons) or Orifice Designation	Evaporator Temperature °F															
		40°F							20°F								
		Pressure Drop (PSI)															
		75	100	125	150	175	200	225	250	75	100	125	150	175	200	225	250
N	1/2	0.57	0.66	0.74	0.81	0.87	0.94	1.0	1.1	0.54	0.63	0.70	0.77	0.83	0.89	0.94	1.0
N	2	1.7	2.0	2.2	2.4	2.6	2.8	3.0	3.1	1.6	1.9	2.1	2.3	2.5	2.7	2.8	3.0
SCE	AAA	0.20	0.23	0.26	0.28	0.30	0.33	0.34	0.36	0.19	0.22	0.24	0.27	0.29	0.31	0.33	0.34
C(E), EC(E), SCE	AA	0.34	0.39	0.44	0.48	0.52	0.56	0.59	0.62	0.32	0.37	0.42	0.46	0.49	0.53	0.56	0.59
C(E), EC(E), SCE	A	1.0	1.2	1.3	1.4	1.5	1.6	1.7	1.8	0.95	1.1	1.2	1.3	1.5	1.6	1.7	1.7
C(E), EC(E), SCE	B	1.8	2.1	2.4	2.6	2.8	3.0	3.2	3.3	1.7	2.0	2.2	2.5	2.7	2.8	3.0	3.2
C(E), EC(E), SCE	C	2.9	3.3	3.7	4.1	4.4	4.7	5.0	5.2	2.7	3.1	3.5	3.8	4.2	4.4	4.7	5.0
C(E), EC(E), SCE	D	4.6	5.3	5.9	6.5	7.0	7.5	7.9	8.4	4.3	5.0	5.6	6.1	6.6	7.1	7.5	7.9
EBSE	6	4.9	5.7	6.4	7.0	7.6	8.1	8.6	9.0	4.4	5.0	5.6	6.2	6.7	7.1	7.5	8.0
EBSE	7-1/2	6.7	7.7	8.7	9.5	10.2	11.0	11.6	12.2	5.9	6.8	7.6	8.4	9.0	9.7	10.2	10.8
EBSE	10	8.3	9.5	10.7	11.7	12.6	13.5	14.3	15.1	7.5	8.6	9.6	10.5	11.4	12.2	12.9	13.6
EBSE	13	11.8	13.6	15.2	16.7	18.0	19.3	20.5	21.6	10.8	12.5	14.0	15.3	16.5	17.7	18.7	19.8
OE	9	8.4	9.7	10.8	11.9	12.8	13.7	14.5	15.3	7.2	8.3	9.2	10.1	10.9	11.7	12.4	13.1
OE	12	11.5	13.2	14.8	16.2	17.5	18.7	19.9	20.9	9.8	11.3	12.6	13.8	14.9	16.0	16.9	17.9
OE	21	18.5	21.4	23.9	26.2	28.3	30.3	32.1	33.8	15.8	18.3	20.4	22.4	24.1	25.8	27.4	28.9
OE	30	26.6	30.8	34.4	37.7	40.7	43.5	46.2	48.7	25.0	28.9	32.3	35.4	38.2	40.8	43.3	45.7
OE	35	30.9	35.7	39.9	43.7	47.2	50.4	53.5	56.4	29.0	33.5	37.4	41.0	44.3	47.3	50.2	52.9
OE	45	39.7	45.9	51.3	56.2	60.7	65	69	73	37.3	43.0	48.1	52.7	56.9	60.8	65	68

Valve Type	Nominal Capacity (Tons) or Orifice Designation	Evaporator Temperature °F															
		0°F							-10°F								
		Pressure Drop (PSI)															
		75	100	125	150	175	200	225	250	75	100	125	150	175	200	225	250
N	1/2	0.47	0.54	0.61	0.66	0.72	0.77	0.81	0.86	0.30	0.35	0.39	0.43	0.46	0.49	0.52	0.55
N	2	1.4	1.6	1.8	2.0	2.2	2.3	2.4	2.6	0.93	1.1	1.2	1.3	1.4	1.5	1.6	1.7
SCE	AAA	0.18	0.21	0.23	0.25	0.27	0.29	0.31	0.32	0.17	0.20	0.22	0.24	0.26	0.28	0.30	0.31
C(E), EC(E), SCE	AA	0.30	0.35	0.39	0.43	0.46	0.50	0.53	0.56	0.28	0.32	0.36	0.39	0.42	0.45	0.48	0.51
C(E), EC(E), SCE	A	0.8	1.0	1.1	1.2	1.3	1.3	1.4	1.5	0.53	0.61	0.68	0.75	0.81	0.86	0.91	0.96
C(E), EC(E), SCE	B	1.5	1.7	1.9	2.1	2.3	2.5	2.6	2.7	0.99	1.2	1.3	1.4	1.5	1.6	1.7	1.8
C(E), EC(E), SCE	C	2.4	2.7	3.0	3.3	3.6	3.8	4.1	4.3	1.5	1.7	1.9	2.1	2.3	2.4	2.6	2.7
C(E), EC(E), SCE	D	3.8	4.3	4.9	5.3	5.7	6.1	6.5	6.9	1.9	2.2	2.5	2.7	2.9	3.1	3.3	3.5
EBSE	6	3.6	4.1	4.6	5.1	5.5	5.8	6.2	6.5	2.9	3.4	3.8	4.1	4.5	4.8	5.1	5.4
EBSE	7-1/2	4.8	5.6	6.3	6.9	7.4	7.9	8.4	8.8	3.7	4.3	4.8	5.3	5.7	6.1	6.5	6.8
EBSE	10	5.6	6.5	7.3	7.9	8.6	9.2	9.7	10.3	4.8	5.5	6.1	6.7	7.3	7.8	8.2	8.7
EBSE	13	7.9	9.1	10.2	11.2	12.1	12.9	13.7	14.4	6.8	7.8	8.7	9.5	10.3	11.0	11.7	12.3
OE	9	5.6	6.5	7.2	7.9	8.6	9.2	9.7	10.2	4.3	5.0	5.6	6.1	6.6	7.1	7.5	7.9
OE	12	7.7	8.9	9.9	10.8	11.7	12.5	13.3	14.0	6.9	7.9	8.9	9.7	10.5	11.2	11.9	12.6
OE	21	11.1	12.8	14.3	15.7	16.9	18.1	19.2	20.2	8.2	9.5	10.6	11.7	12.6	13.5	14.3	15.1
OE	30	17.8	20.6	23.0	25.2	27.2	29.1	30.9	32.5	12.3	14.3	15.9	17.5	18.9	20.2	21.4	22.5
OE	35	20.7	23.8	26.7	29.2	31.5	33.7	35.8	37.7	13.4	15.5	17.3	19.0	20.5	21.9	23.2	24.5
OE	45	26.6	30.7	34.3	37.6	40.6	43.4	46	49	15.4	17.8	19.9	21.8	23.6	25.2	26.8	28.2

These ratings are based on vapor free 100°F liquid refrigerant entering the expansion valve, and a maximum of 7°F change in superheat.

Refrigerant	Liquid Temperature Entering TEV							
	0°F	20°F	40°F	60°F	80°F	100°F	120°F	140°F
Correction Factor								
R-404A	2.04	1.84	1.64	1.43	1.22	1.00	0.77	0.53
R-507	1.95	1.76	1.56	1.37	1.18	0.98	0.76	0.50

These factors include corrections for liquid refrigerant density and net refrigerating effect, and are based on an evaporator temperature of 0°F. However, they may be used for any evaporator temperature from -10°F to 40°F since the variation in the actual factors across this range is insignificant.

TEV Capacity = TEV Rating x CF Liquid Temperature – Example: Actual capacity of an SCE-B using R-507 at a 20°F evaporator, 175 psi pressure drop across the TEV, and a 80°F liquid temperature entering the TEV = 1.91 (from rating chart) x 1.18 (CF liquid temperature) = 2.25 tons

Capacity Tables

R-404A Capacities in Kilowatts (R-507 Refrigerant & Liquid Temperature Correction Factor below)

Valve Type	Nominal Capacity (kW) or Orifice Designation	Evaporator Temperature °C															
		5°C								-5°C							
		Pressure Drop (BAR)															
		4	6	8	10	12	14	16	18	4	6	8	10	12	14	16	18
N	3	1.7	2.1	2.4	2.7	3.0	3.2	3.4	3.6	1.6	2.0	2.3	2.6	2.8	3.0	3.3	3.4
N	7	5.1	6.2	7.2	8.1	8.8	9.6	10.2	10.8	4.9	5.9	6.9	7.7	8.4	9.1	9.7	10.3
SCE	AAA	0.59	0.72	0.84	0.93	1.0	1.1	1.2	1.3	0.56	0.69	0.80	0.89	0.97	1.1	1.1	1.2
C(E), EC(E), SCE	AA	1.0	1.2	1.4	1.6	1.8	1.9	2.0	2.2	0.97	1.2	1.4	1.5	1.7	1.8	1.9	2.1
C(E), EC(E), SCE	A	3.0	3.7	4.2	4.7	5.2	5.6	6.0	6.3	2.8	3.5	4.0	4.5	4.9	5.3	5.7	6.0
C(E), EC(E), SCE	B	5.4	6.7	7.7	8.6	9.4	10.2	10.9	11.5	5.2	6.3	7.3	8.2	9.0	9.7	10.3	11.0
C(E), EC(E), SCE	C	8.5	10.4	12.0	13.5	14.8	15.9	17.0	18.1	8.1	9.9	11.5	12.8	14.0	15.2	16.2	17.2
C(E), EC(E), SCE	D	13.6	16.7	19.3	21.5	23.6	25.5	27.3	28.9	13.0	15.9	18.3	20.5	22.5	24.3	25.9	27.5
EBSE	21	14.4	17.7	20.4	22.8	25.0	27.0	28.9	30.6	12.9	15.8	18.3	20.4	22.4	24.1	25.8	27.4
EBSE	26	19.6	24.0	27.7	31.0	33.9	36.7	39.2	41.6	17.5	21.5	24.8	27.7	30.3	32.8	35.0	37.2
EBSE	35	24.1	29.5	34.1	38.1	41.8	45.1	48.2	51.2	22.0	27.0	31.1	34.8	38.1	41.2	44.0	46.7
EBSE	46	34.4	42.2	48.7	54.4	59.6	64.4	68.9	73.0	31.9	39.0	45.1	50.4	55.2	59.6	63.7	67.6
OE	32	24.5	30.0	34.7	38.8	42.5	45.9	49.1	52.0	21.3	26.1	30.1	33.7	36.9	39.9	42.6	45.2
OE	42	33.6	41.1	47.5	53.1	58.1	62.8	67.1	71.2	29.2	35.7	41.2	46.1	50.5	54.5	58.3	61.8
OE	74	54.2	66.4	76.7	85.7	93.9	101	108	115	47.1	57.7	66.6	74.5	81.6	88.1	94.2	99.9
OE	110	77.6	95.1	110	123	134	145	155	165	73.4	89.9	104	116	127	137	147	156
OE	120	90.0	110	127	142	156	168	180	191	85.1	104	120	134	147	159	170	180
OE	160	116	142	164	183	200	216	231	245	109	134	155	173	189	205	219	232

Valve Type	Nominal Capacity (kW) or Orifice Designation	Evaporator Temperature °C															
		-15°C								-25°C							
		Pressure Drop (BAR)															
		4	6	8	10	12	14	16	18	4	6	8	10	12	14	16	18
N	3	1.4	1.8	2.0	2.3	2.5	2.7	2.9	3.1	0.86	1.1	1.2	1.4	1.5	1.6	1.7	1.8
N	7	4.3	5.3	6.1	6.8	7.5	8.1	8.6	9.2	2.6	3.2	3.7	4.2	4.6	5.0	5.3	5.6
SCE	AAA	0.53	0.65	0.75	0.84	0.92	1.0	1.1	1.1	0.48	0.59	0.68	0.77	0.84	0.91	1.0	1.0
C(E), EC(E), SCE	AA	0.91	1.1	1.3	1.4	1.6	1.7	1.8	1.9	0.79	1.0	1.1	1.2	1.4	1.5	1.6	1.7
C(E), EC(E), SCE	A	2.5	3.1	3.6	4.0	4.4	4.7	5.1	5.4	1.5	1.8	2.1	2.4	2.6	2.8	3.0	3.2
C(E), EC(E), SCE	B	4.6	5.6	6.5	7.3	8.0	8.6	9.2	9.8	2.8	3.5	4.0	4.5	4.9	5.3	5.6	6.0
C(E), EC(E), SCE	C	7.2	8.8	10.2	11.4	12.5	13.5	14.4	15.3	4.2	5.2	6.0	6.7	7.3	7.9	8.4	8.9
C(E), EC(E), SCE	D	11.5	14.1	16.3	18.2	20.0	21.6	23.1	24.5	5.3	6.5	7.5	8.4	9.2	9.9	10.6	11.3
EBSE	21	10.9	13.4	15.5	17.3	18.9	20.5	21.9	23.2	8.0	9.8	11.3	12.6	13.8	14.9	16.0	16.9
EBSE	26	14.8	18.2	21.0	23.5	25.7	27.8	29.7	31.5	10.2	12.4	14.4	16.1	17.6	19.0	20.3	21.6
EBSE	35	17.6	21.6	24.9	27.9	30.5	33.0	35.2	37.4	13.1	16.0	18.5	20.7	22.7	24.5	26.2	27.8
EBSE	46	25.0	30.6	35.4	39.5	43.3	46.8	50.0	53.0	18.6	22.8	26.4	29.5	32.2	34.9	37.3	39.6
OE	32	17.4	21.3	24.6	27.5	30.1	32.5	34.8	36.9	12.1	14.8	17.0	19.1	20.9	22.5	24.1	25.6
OE	42	23.8	29.1	33.6	37.6	41.2	44.5	47.6	50.5	19.2	23.5	27.2	30.4	33.3	35.9	38.4	40.7
OE	74	35.5	43.5	50.2	56.1	61.5	66.4	71.0	75.3	23.0	28.2	32.5	36.4	39.9	43.1	46.0	48.8
OE	110	56.8	69.6	80.4	89.9	98.5	106	114	121	34.5	42.2	48.7	54.5	59.7	64.5	68.9	73.1
OE	120	65.9	80.7	93.2	104	114	123	132	140	37.4	45.8	52.9	59.2	64.8	70.0	74.8	79.4
OE	160	84.7	104	120	134	147	158	169	180	43.1	52.8	61.0	68.2	74.7	80.7	86.3	91.5

These ratings are based on vapor free 40°C liquid refrigerant entering the expansion valve, and a maximum of 4°C change in superheat.

Refrigerant	Liquid Temperature Entering TEV							
	-10°C	0°C	10°C	20°C	30°C	40°C	50°C	60°C
	Correction Factor							
R-404A	1.98	1.79	1.60	1.41	1.21	1.00	0.79	0.56
R-507	1.89	1.71	1.53	1.35	1.17	0.98	0.78	0.53

These factors include corrections for liquid refrigerant density and net refrigerating effect, and are based on an evaporator temperature of -15°C. However, they may be used for any evaporator temperature from -25°C to 5°C since the variation in the actual factors across this range is insignificant.

TEV Capacity = TEV Rating x CF Liquid Temperature – Example: Actual capacity of an SCE-B using R-507 at a -5°C evaporator, 12 bar pressure drop across the TEV, and a 30°C liquid temperature entering the TEV = 6.72 (from rating chart) x 1.17 (CF liquid temperature) = 7.86 kW

Capacity Tables

R-410A Capacities in Tons

Valve Type	Nominal Capacity (Tons) or Orifice Designation	Evaporator Temperature °F																	
		40°F						20°F						0°F					
		Pressure Drop (PSI)																	
		120	160	200	240	280	320	120	160	200	240	280	320	120	160	200	240	280	320
H(E), HC(E)	1-1/2	1.3	1.5	1.7	1.8	2.0	2.1	1.3	1.5	1.6	1.8	1.9	2.1	1.2	1.4	1.6	1.7	1.9	2.0
H(E), HC(E)	3	2.6	3.0	3.4	3.7	4.0	4.2	2.6	2.9	3.3	3.6	3.9	4.2	2.4	2.8	3.2	3.5	3.7	4.0
H(E), HC(E)	5	4.3	5.0	5.6	6.1	6.6	7.1	4.4	4.9	5.5	6.0	6.5	6.9	4.1	4.7	5.3	5.8	6.2	6.7
ECE	AA	0.62	0.72	0.80	0.88	0.95	1.0	0.61	0.70	0.78	0.86	0.93	0.99	0.53	0.61	0.69	0.75	0.81	0.87
ECE	A	1.8	2.1	2.3	2.6	2.8	3.0	1.8	2.1	2.3	2.5	2.7	2.9	1.6	1.8	2.0	2.2	2.4	2.6
ECE	B	3.3	3.8	4.3	4.7	5.1	5.4	3.2	3.7	4.2	4.6	5.0	5.3	2.9	3.3	3.7	4.1	4.4	4.7
ECE	C	5.2	6.0	6.7	7.3	7.9	8.5	5.1	5.9	6.5	7.2	7.7	8.3	4.5	5.2	5.8	6.4	6.9	7.4
ECE	D	8.3	9.6	10.7	11.7	12.7	13.6	8.1	9.4	10.5	11.5	12.4	13.2	7.2	8.4	9.3	10.2	11.1	11.8
ECE	12-1/2	10.8	12.5	14.0	15.3	16.5	17.7	10.6	12.2	13.6	14.9	16.1	17.2	9.4	10.9	12.2	13.3	14.4	15.4
ECE	15	12.6	14.5	16.2	17.8	19.2	20.5	12.3	14.1	15.8	17.3	18.7	20.0	10.9	12.6	14.1	15.5	16.7	17.9
OE	20	17.3	20.0	22.4	24.5	26.5	28.3	16.9	19.5	21.8	23.9	25.8	27.6	15.9	18.4	20.6	22.5	24.3	26.0
OE	25	20.8	24.0	26.8	29.4	31.7	33.9	20.3	23.4	26.2	28.7	31.0	33.1	19.1	22.1	24.7	27.0	29.2	31.2
OE	35	28.6	33.0	36.9	40.4	43.7	46.7	27.9	32.2	36.0	39.4	42.6	45.5	26.3	30.3	33.9	37.2	40.1	42.9
OE	50	43.3	50.0	55.9	61.2	66.1	70.7	42.2	48.8	54.5	59.7	64.5	69.0	39.8	46.0	51.4	56.3	60.8	65.0
OE	60	52.0	60.0	67.1	73.5	79.4	84.8	50.7	58.5	65.4	71.7	77.4	82.8	47.8	55.2	61.7	67.5	73.0	78.0

These ratings are based on vapor free 100°F liquid refrigerant entering the expansion valve, and a maximum of 7°F change in superheat.

Refrigerant	Liquid Temperature Entering TEV							
	0°F	20°F	40°F	60°F	80°F	100°F	120°F	140°F
	Correction Factor, CF Liquid Temperature							
R-410A	1.79	1.63	1.47	1.32	1.16	1.00	0.83	0.62

These factors include corrections for liquid refrigerant density and net refrigerating effect, and are based on an evaporator temperature of 0°F. However, they may be used for any evaporator temperature from 0°F to 40°F since the variation in the actual factors across this range is insignificant.

TEV Capacity = TEV Rating x CF Liquid Temperature – Example: Actual capacity of an HCE-3 using R-410A at a 40°F evaporator, 160 psi pressure drop across the TEV, and a 80°F liquid temperature entering the TEV = 3.00 (from rating chart) x 1.16 (CF liquid temperature) = 3.48 tons

R-410A Capacities in Kilowatts

Valve Type	Nominal Capacity (kW) or Orifice Designation	Evaporator Temperature °C																	
		5°C						-5°C						-15°C					
		Pressure Drop (BAR)																	
		8	11	14	17	20	23	8	11	14	17	20	23	8	11	14	17	20	23
H(E), HC(E)	5	4.5	5.3	5.9	6.6	7.1	7.6	4.4	5.2	5.8	6.4	6.9	7.5	4.3	5.0	5.7	6.3	6.7	7.3
H(E), HC(E)	11	9.0	10.5	11.9	13.1	14.2	15.2	8.8	10.3	11.6	12.8	13.9	14.9	8.6	10.0	11.3	12.5	13.3	14.5
H(E), HC(E)	18	15.0	17.6	19.8	21.8	23.7	25.4	14.7	17.2	19.4	21.4	23.2	24.9	14.3	16.7	18.9	20.8	22.3	24.2
ECE	AA	2.1	2.5	2.8	3.0	3.3	3.5	2.0	2.4	2.7	3.0	3.2	3.5	1.8	2.2	2.4	2.7	2.9	3.1
ECE	A	6.1	7.1	8.1	8.9	9.6	10.3	6.0	7.0	7.9	8.7	9.4	10.1	5.5	6.4	7.2	8.0	8.6	9.3
ECE	B	11.1	13.1	14.7	16.2	17.6	18.9	10.9	12.8	14.4	15.9	17.2	18.5	10.0	11.7	13.2	14.5	15.8	16.9
ECE	C	17.4	20.4	23.0	25.4	27.5	29.5	17.0	19.9	22.5	24.8	26.9	28.8	15.6	18.3	20.6	22.7	24.6	26.4
ECE	D	27.8	32.6	36.8	40.6	44.0	47.2	27.2	31.9	36.0	39.7	43.0	46.2	24.9	29.2	33.0	36.3	39.4	42.3
ECE	44	36.3	42.5	48.0	52.9	57.4	61.5	35.5	41.6	46.9	51.7	56.1	60.2	32.5	38.1	43.0	47.4	51.4	55.1
ECE	53	42.1	49.5	55.7	61.4	66.5	71.4	41.2	48.3	54.4	60.0	65.1	69.8	37.7	44.2	49.9	54.9	59.6	63.9
OE	70	57.3	67.1	75.8	83.5	90.5	97.1	56.2	65.9	74.3	81.9	88.8	95.2	53.7	62.9	70.9	78.1	84.7	90.9
OE	88	68.7	80.6	90.9	100	109	117	67.4	79.0	89.2	98.2	107	114	64.3	75.4	85.1	93.8	102	109
OE	123	94.5	111	125	138	149	160	92.7	109	123	135	147	157	88.4	104	117	129	140	150
OE	176	143	168	189	209	226	243	140	165	186	205	222	238	134	157	177	195	212	227
OE	211	172	201	227	250	272	291	168	198	223	246	266	286	161	189	213	234	254	273

These ratings are based on vapor free 40°C liquid refrigerant entering the expansion valve, and a maximum of 4°C change in superheat.

Refrigerant	Liquid Temperature Entering TEV							
	-10°C	0°C	10°C	20°C	30°C	40°C	50°C	60°C
	Correction Factor, CF Liquid Temperature							
R-410A	1.73	1.59	1.44	1.30	1.15	1.00	0.84	0.65

These factors include corrections for liquid refrigerant density and net refrigerating effect, and are based on an evaporator temperature of -15°C. However, they may be used for any evaporator temperature from -15°C to 5°C since the variation in the actual factors across this range is insignificant.

TEV Capacity = TEV Rating x CF Liquid Temperature – Example: Actual capacity of an HCE-3 using R-410A at a 5°C evaporator, 11 bar pressure drop across the TEV, and a 30°C liquid temperature entering the TEV = 10.5 (from rating chart) x 1.15 (CF liquid temperature) = 12.1 kW

A Series Constant Pressure (Automatic) Valves

Specifications

- 0-90 psig adjustment range
- Bypass bleeds available
- Construction: Brass, copper and stainless steel
- Internally equalized
- U.L. recognized for maximum operating pressure of 500 psig high side, 400 psig low side

Model No.	Equalizer	Connections (Inches)	
		Inlet	Outlet
AS	Internal	1/4 ODF	3/8 ODF
A1	Internal	1/4 ODF	1/4 NPTF
A1	Internal	1/4 SAE	1/4 NPTF
A2*	Internal	1/4 SAE	1/2 SAE
A3	Internal	3/8 SAE	1/2 SAE
A4	Internal	1/4 SAE	1/2 SAE
A4	Internal	3/8 SAE	1/2 SAE
A7	Internal	1/4 ODF	1/4 ODF
A7	Internal	1/4 ODF	3/8 ODF
A7	Internal	3/8 ODF	3/8 ODF
A7	Internal	3/8 SAE	3/8 SAE
AT	Internal	1/4 SAE	1/4 NPTF
AT	Internal	1/4 ODF	1/4 NPTF

*1/2" x 3/8" SAE flare adaptor available.

Model A7

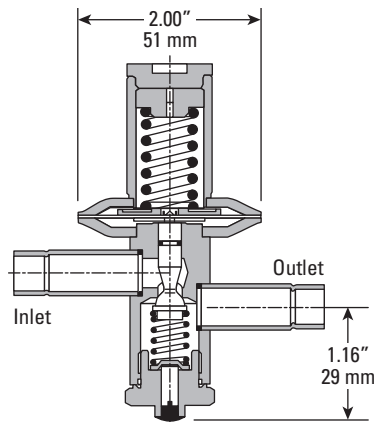

Model AS

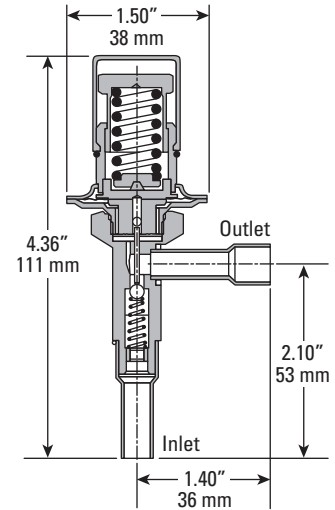

Model AT

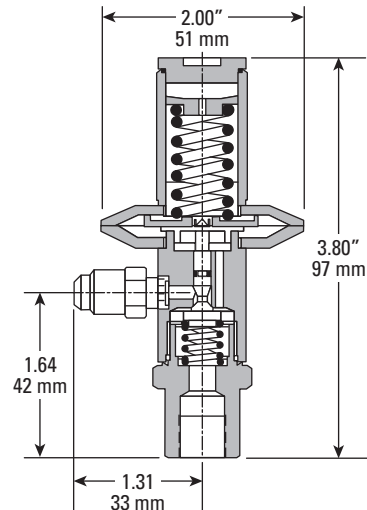

Model A1

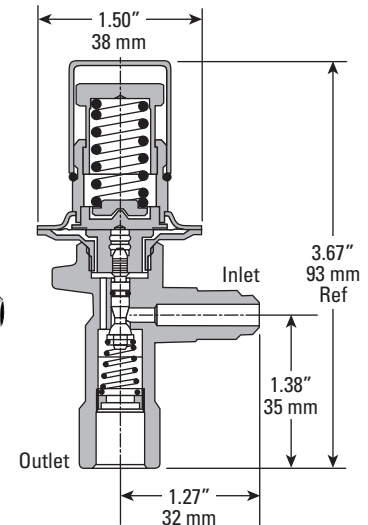
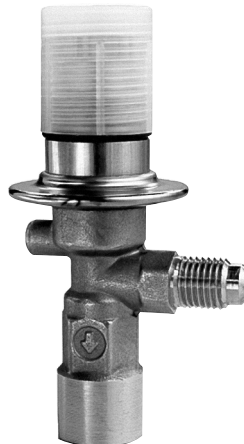

A Series Constant Pressure (Automatic) Valves

Model A2

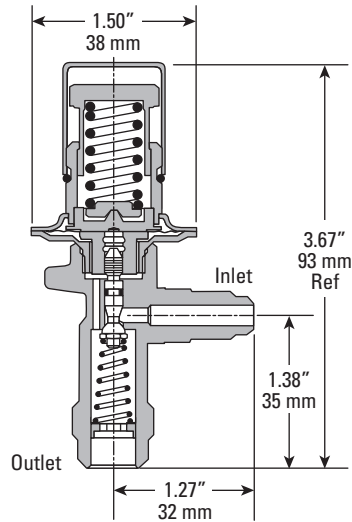
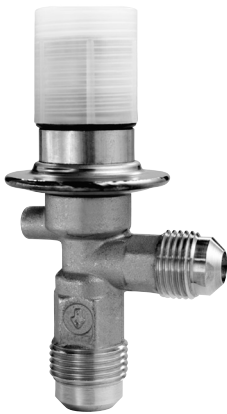

Model A3

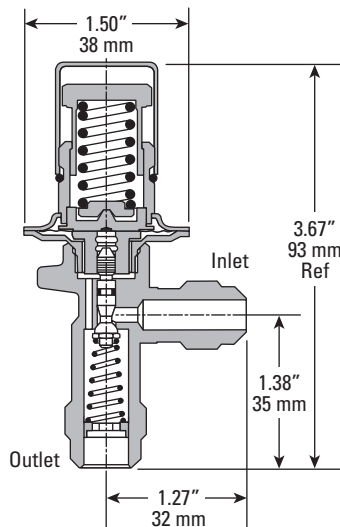

Model A4

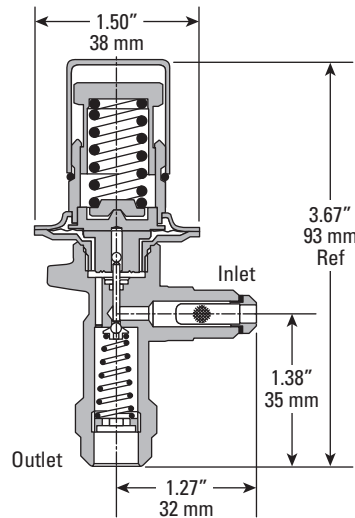

Capacity Tables

R-134a Capacities in Tons (R-401A, R-409A Refrigerant & Liquid Temperature Correction Factor below)

Valve Type	Orifice	Nominal Capacity (Tons)	Capacity Range (Tons)	Evaporator Temperature °F																	
				40°F						20°F						0°F					
				Pressure Drop (PSI)																	
				40	60	80	100	120	140	60	80	100	120	140	160	60	80	100	120	140	160
A1, A2, AT	B	2	1 to 2	1.63	2.00	2.31	2.58	2.83	3.06	1.90	2.19	2.45	2.69	2.90	3.10	1.70	1.96	2.19	2.40	2.60	2.78
A4	—	1/2	1/4 to 3/4	0.61	0.75	0.87	0.97	1.06	1.15	0.71	0.82	0.92	1.01	1.09	1.16	0.64	0.74	0.82	0.90	0.97	1.04
A7-AA	AA	1/2	1/8 to 1/2	0.41	0.50	0.58	0.65	0.71	0.76	0.48	0.55	0.61	0.67	0.73	0.78	0.43	0.49	0.55	0.60	0.65	0.69
A7-A	A	1	1/4 to 1	0.82	1.00	1.15	1.29	1.41	1.53	0.95	1.10	1.23	1.34	1.45	1.55	0.85	0.98	1.10	1.20	1.30	1.39
A7-B	B	2	1 to 2	1.63	2.00	2.31	2.58	2.83	3.06	1.90	2.19	2.45	2.69	2.90	3.10	1.70	1.96	2.19	2.40	2.60	2.78
A7-C	C	3	1-1/2 to 3	2.45	3.00	3.46	3.87	4.24	4.58	2.85	3.29	3.68	4.03	4.35	4.65	2.55	2.94	3.29	3.61	3.90	4.16
AS, ASB20	—	1	1/4 to 1	0.82	1.00	1.15	1.29	1.41	1.53	0.95	1.10	1.23	1.34	1.45	1.55	0.85	0.98	1.10	1.20	1.30	1.39

Valve Type	Orifice	Nominal Capacity (Tons)	Capacity Range (Tons)	Evaporator Temperature °F																	
				-10°F						-20°F						-40°F					
				Pressure Drop (PSI)																	
				80	100	120	140	160	180	80	100	120	140	160	180	80	100	120	140	160	180
A1, A2, AT	B	2	1 to 2	1.64	1.83	2.01	2.17	2.32	2.46	1.34	1.50	1.64	1.77	1.89	2.01	0.88	0.98	1.07	1.16	1.24	1.32
A4	—	1/2	1/4 to 3/4	0.61	0.69	0.75	0.81	0.87	0.92	0.50	0.56	0.62	0.66	0.71	0.75	0.33	0.37	0.40	0.44	0.47	0.49
A7-AA	AA	1/2	1/8 to 1/2	0.41	0.46	0.50	0.54	0.58	0.61	0.33	0.37	0.41	0.44	0.47	0.50	0.22	0.25	0.27	0.29	0.31	0.33
A7-A	A	1	1/4 to 1	0.82	0.92	1.00	1.08	1.16	1.23	0.67	0.75	0.82	0.89	0.95	1.00	0.44	0.49	0.54	0.58	0.62	0.66
A7-B	B	2	1 to 2	1.64	1.83	2.01	2.17	2.32	2.46	1.34	1.50	1.64	1.77	1.89	2.01	0.88	0.98	1.07	1.16	1.24	1.32
A7-C	C	3	1-1/2 to 3	2.46	2.75	3.01	3.25	3.48	3.69	2.01	2.25	2.46	2.66	2.84	3.01	1.32	1.47	1.61	1.74	1.86	1.97
AS, ASB20	—	1	1/4 to 1	0.82	0.92	1.00	1.08	1.16	1.23	0.67	0.75	0.82	0.89	0.95	1.00	0.44	0.49	0.54	0.58	0.62	0.66

■ Gold areas are standard conditions.

Refrigerant	Liquid Temperature Entering AEV							
	0°F	20°F	40°F	60°F	80°F	100°F	120°F	140°F
	Correction Factor							
R-134a	1.69	1.56	1.42	1.29	1.14	1.00	0.85	0.71
R-401A	1.75	1.62	1.49	1.36	1.23	1.09	0.95	0.81
R-409A	1.65	1.54	1.42	1.31	1.19	1.06	0.94	0.81

These factors include corrections for liquid refrigerant density and net refrigerating effect, and are based on an evaporator temperature of 0°F. However, they may be used for any evaporator temperature from -40°F to 40°F since the variation in the actual factors across this range is insignificant.

AEV Capacity = AEV Rating x CF Liquid Temperature – Example: Actual capacity of an A7-B using R-409A at a 20°F evaporator, 120 psi pressure drop across the AEV, and a 80°F liquid temperature entering the AEV = 2.69 (from rating chart) x 1.19 (CF liquid temperature) = 3.20 tons

R-134a Capacities in Kilowatts (R-401A, R-409A Refrigerant & Liquid Temperature Correction Factor below)

Valve Type	Orifice	Nominal Capacity (kW)	Capacity Range (kW)	Evaporator Temperature °C																	
				10°C						0°C						-10°C					
				Pressure Drop (BAR)																	
				3	4	6	7	8	10	4	6	7	8	10	11	4	6	7	8	10	11
A1, A2, AT	B	7	4 to 7	6.21	7.17	8.79	9.49	10.1	11.3	6.89	8.44	9.11	9.74	10.9	11.4	6.46	7.91	8.54	9.13	10.2	10.7
A4	—	3	1 to 3	2.33	2.69	3.30	3.56	3.80	4.25	2.58	3.16	3.42	3.65	4.08	4.28	2.42	2.97	3.20	3.42	3.83	4.02
A7-AA	AA	2	1/2 to 2	1.55	1.79	2.20	2.37	2.54	2.84	1.72	2.11	2.28	2.44	2.72	2.86	1.61	1.98	2.14	2.28	2.55	2.68
A7-A	A	4	1 to 4	3.11	3.59	4.39	4.75	5.07	5.67	3.44	4.22	4.56	4.87	5.45	5.71	3.23	3.95	4.27	4.57	5.10	5.35
A7-B	B	7	4 to 7	6.21	7.17	8.79	9.49	10.1	11.3	6.89	8.44	9.11	9.74	10.9	11.4	6.46	7.91	8.54	9.13	10.2	10.7
A7-C	C	11	5 to 11	9.32	10.8	13.2	14.2	15.2	17.0	10.3	12.7	13.7	14.6	16.3	17.1	9.69	11.9	12.8	13.7	15.3	16.1
AS, ASB20	—	4	1 to 4	3.11	3.59	4.39	4.75	5.07	5.67	3.44	4.22	4.56	4.87	5.45	5.71	3.23	3.95	4.27	4.57	5.10	5.35

Valve Type	Orifice	Nominal Capacity (kW)	Capacity Range (kW)	Evaporator Temperature °C																	
				-20°C						-30°C						-40°C					
				Pressure Drop (BAR)																	
				6	7	8	10	11	12	6	7	8	10	11	12	6	7	8	10	11	12
A1, A2, AT	B	7	4 to 7	6.77	7.31	7.81	8.74	9.16	9.57	5.01	5.41	5.78	6.47	6.78	7.08	3.25	3.51	3.75	4.20	4.40	4.60
A4	—	3	1 to 3	2.54	2.74	2.93	3.28	3.44	3.59	1.88	2.03	2.17	2.42	2.54	2.66	1.22	1.32	1.41	1.57	1.65	1.72
A7-AA	AA	2	1/2 to 2	1.69	1.83	1.95	2.18	2.29	2.39	1.25	1.35	1.45	1.62	1.70	1.77	0.81	0.88	0.94	1.05	1.10	1.15
A7-A	A	4	1 to 4	3.38	3.65	3.91	4.37	4.58	4.78	2.50	2.70	2.89	3.23	3.39	3.54	1.63	1.76	1.88	2.10	2.20	2.30
A7-B	B	7	4 to 7	6.77	7.31	7.81	8.74	9.16	9.57	5.01	5.41	5.78	6.47	6.78	7.08	3.25	3.51	3.75	4.20	4.40	4.60
A7-C	C	11	5 to 11	10.1	11.0	11.7	13.1	13.7	14.4	7.51	8.11	8.68	9.70	10.2	10.6	4.88	5.27	5.63	6.30	6.60	6.90
AS, ASB20	—	4	1 to 4	3.38	3.65	3.91	4.37	4.58	4.78	2.50	2.70	2.89	3.23	3.39	3.54	1.63	1.76	1.88	2.10	2.20	2.30

■ Gold areas are standard conditions.

Refrigerant	Liquid Temperature Entering AEV							
	-10°C	0°C	10°C	20°C	30°C	40°C	50°C	60°C
	Correction Factor							
R-134a	1.64	1.52	1.39	1.26	1.13	1.00	0.87	0.73
R-401A	1.70	1.59	1.46	1.34	1.22	1.09	0.96	0.83
R-409A	1.61	1.50	1.40	1.29	1.18	1.07	0.95	0.83

These factors include corrections for liquid refrigerant density and net refrigerating effect, and are based on an evaporator temperature of -15°C. However, they may be used for any evaporator temperature from -40°C to 10°C since the variation in the actual factors across this range is insignificant.

AEV Capacity = AEV Rating x CF Liquid Temperature – Example: Actual capacity of an A7-B using R-409A at a 0°C evaporator, 8 bar pressure drop across the AEV, and a 30°C liquid temperature entering the AEV = 9.74 (from rating chart) x 1.18 (CF liquid temperature) = 11.5 kW

Capacity Tables

R-22 Capacities in Tons (R-407C Refrigerant & Liquid Temperature Correction Factor below)

Valve Type	Orifice	Nominal Capacity (Tons)	Capacity Range (Tons)	Evaporator Temperature °F																	
				40°F				20°F				0°F									
				Pressure Drop (PSI)																	
				75	100	125	150	175	200	75	100	125	150	175	200	75	100	125	150	175	200
A1, A2, AT	B	3	1-1/2 to 3	2.60	3.00	3.35	3.67	3.97	4.24	2.55	2.94	3.29	3.60	3.89	4.16	2.29	2.64	2.95	3.23	3.49	3.73
A4	—	1	1/2 to 1	0.87	1.00	1.12	1.22	1.32	1.41	0.85	0.98	1.10	1.20	1.30	1.39	0.76	0.88	0.98	1.08	1.16	1.24
A7-AA	AA	3/4	1/5 to 3/4	0.65	0.75	0.84	0.92	0.99	1.06	0.64	0.74	0.82	0.90	0.97	1.04	0.57	0.66	0.74	0.81	0.87	0.93
A7-A	A	1-1/2	1/2 to 1-1/2	1.30	1.50	1.68	1.84	1.98	2.12	1.27	1.47	1.64	1.80	1.94	2.08	1.14	1.32	1.48	1.62	1.75	1.87
A7-B	B	3	1-1/2 to 3	2.60	3.00	3.35	3.67	3.97	4.24	2.55	2.94	3.29	3.60	3.89	4.16	2.29	2.64	2.95	3.23	3.49	3.73
A7-C	C	5	3-1/2 to 5	4.33	5.00	5.59	6.12	6.61	7.07	4.24	4.90	5.48	6.00	6.48	6.93	3.81	4.40	4.92	5.39	5.82	6.22
AS, ASB20	—	1-1/2	1/2 to 1-1/2	1.30	1.50	1.68	1.84	1.98	2.12	1.27	1.47	1.64	1.80	1.94	2.08	1.14	1.32	1.48	1.62	1.75	1.87

Valve Type	Orifice	Nominal Capacity (Tons)	Capacity Range (Tons)	Evaporator Temperature °F																	
				-10°F				-20°F				-40°F									
				Pressure Drop (PSI)																	
				100	125	150	175	200	225	125	150	175	200	225	250	125	150	175	200	225	250
A1, A2, AT	B	3	1-1/2 to 3	2.22	2.48	2.72	2.94	3.14	3.33	2.05	2.24	2.42	2.59	2.75	2.89	1.38	1.51	1.63	1.74	1.85	1.94
A4	—	1	1/2 to 1	0.74	0.83	0.91	0.98	1.05	1.11	0.68	0.75	0.81	0.86	0.92	0.96	0.46	0.50	0.54	0.58	0.62	0.65
A7-AA	AA	3/4	1/5 to 3/4	0.56	0.62	0.68	0.73	0.78	0.83	0.51	0.56	0.61	0.65	0.69	0.72	0.34	0.38	0.41	0.43	0.46	0.49
A7-A	A	1-1/2	1/2 to 1-1/2	1.11	1.24	1.36	1.47	1.57	1.67	1.02	1.12	1.21	1.29	1.37	1.45	0.69	0.75	0.81	0.87	0.92	0.97
A7-B	B	3	1-1/2 to 3	2.22	2.48	2.72	2.94	3.14	3.33	2.05	2.24	2.42	2.59	2.75	2.89	1.38	1.51	1.63	1.74	1.85	1.94
A7-C	C	5	3-1/2 to 5	3.70	4.14	4.53	4.89	5.23	5.55	3.41	3.74	4.03	4.31	4.58	4.82	2.29	2.51	2.71	2.90	3.08	3.24
AS, ASB20	—	1-1/2	1/2 to 1-1/2	1.11	1.24	1.36	1.47	1.57	1.67	1.02	1.12	1.21	1.29	1.37	1.45	0.69	0.75	0.81	0.87	0.92	0.97

■ Gold areas are standard conditions.

Refrigerant	Liquid Temperature Entering AEV							
	0°F	20°F	40°F	60°F	80°F	100°F	120°F	140°F
	Correction Factor							
R-22	1.57	1.45	1.34	1.23	1.12	1.00	0.88	0.76
R-407C	1.58	1.45	1.32	1.18	1.04	0.89	0.74	0.57

These factors include corrections for liquid refrigerant density and net refrigerating effect, and are based on an evaporator temperature of 0°F. However, they may be used for any evaporator temperature from -40°F to 40°F since the variation in the actual factors across this range is insignificant.

AEV Capacity = AEV Rating x CF Liquid Temperature – Example: Actual capacity of an A7-B using R-407C at a 40°F evaporator, 125 psi pressure drop across the AEV, and a 80°F liquid temperature entering the AEV = 3.35 (from rating chart) x 1.04 (CF liquid temperature) = 3.48 tons

R-22 Capacities in Kilowatts (R-407C Refrigerant & Liquid Temperature Correction Factor below)

Valve Type	Orifice	Nominal Capacity (kW)	Capacity Range (kW)	Evaporator Temperature °C																	
				10°C				0°C				-10°C									
				Pressure Drop (BAR)																	
				5	7	9	10	12	14	5	7	9	10	12	14	7	9	10	12	14	16
A1, A2, AT	B	11	5 to 11	9.01	10.7	12.1	12.7	14.0	15.1	8.83	10.4	11.8	12.5	13.7	14.8	10.1	11.5	12.1	13.3	14.3	15.3
A4	—	4	2 to 4	3.00	3.55	4.03	4.25	4.65	5.02	2.94	3.48	3.95	4.16	4.56	4.92	3.37	3.83	4.03	4.42	4.77	5.10
A7-AA	AA	3	3/4 to 3	2.25	2.66	3.02	3.18	3.49	3.77	2.21	2.61	2.96	3.12	3.42	3.69	2.53	2.87	3.03	3.31	3.58	3.83
A7-A	A	5	2 to 5	4.50	5.33	6.04	6.37	6.98	7.54	4.41	5.22	5.92	6.24	6.84	7.38	5.06	5.74	6.05	6.63	7.16	7.65
A7-B	B	11	5 to 11	9.01	10.7	12.1	12.7	14.0	15.1	8.83	10.4	11.8	12.5	13.7	14.8	10.1	11.5	12.1	13.3	14.3	15.3
A7-C	C	18	12 to 18	15.0	17.8	20.1	21.2	23.3	25.1	14.7	17.4	19.7	20.8	22.8	24.6	16.9	19.1	20.2	22.1	23.9	25.5
AS, ASB20	—	5	2 to 5	4.50	5.33	6.04	6.37	6.98	7.54	4.41	5.22	5.92	6.24	6.84	7.38	5.06	5.74	6.05	6.63	7.16	7.65

Valve Type	Orifice	Nominal Capacity (kW)	Capacity Range (kW)	Evaporator Temperature °C																	
				-20°C				-30°C				-40°C									
				Pressure Drop (BAR)																	
				9	10	12	14	16	17	9	10	12	14	16	17	9	10	12	14	16	17
A1, A2, AT	B	11	5 to 11	9.79	10.3	11.3	12.2	13.1	13.5	7.25	7.64	8.37	9.04	9.67	9.96	4.83	5.09	5.58	6.03	6.44	6.64
A4	—	4	2 to 4	3.26	3.44	3.77	4.07	4.35	4.48	2.42	2.55	2.79	3.01	3.22	3.32	1.61	1.70	1.86	2.01	2.15	2.21
A7-AA	AA	3	3/4 to 3	2.45	2.58	2.83	3.05	3.26	3.36	1.81	1.91	2.09	2.26	2.42	2.49	1.21	1.27	1.40	1.51	1.61	1.66
A7-A	A	5	2 to 5	4.89	5.16	5.65	6.10	6.53	6.73	3.63	3.82	4.19	4.52	4.83	4.98	2.42	2.55	2.79	3.01	3.22	3.32
A7-B	B	11	5 to 11	9.79	10.3	11.3	12.2	13.1	13.5	7.25	7.64	8.37	9.04	9.67	9.96	4.83	5.09	5.58	6.03	6.44	6.64
A7-C	C	18	12 to 18	16.3	17.2	18.8	20.3	21.8	22.4	12.1	12.7	14.0	15.1	16.1	16.6	8.06	8.49	9.30	10.0	10.7	11.1
AS, ASB20	—	5	2 to 5	4.89	5.16	5.65	6.10	6.53	6.73	3.63	3.82	4.19	4.52	4.83	4.98	2.42	2.55	2.79	3.01	3.22	3.32

■ Gold areas are standard conditions.

Refrigerant	Liquid Temperature Entering AEV							
	-10°C	0°C	10°C	20°C	30°C	40°C	50°C	60°C
	Correction Factor							
R-22	1.52	1.42	1.32	1.21	1.11	1.00	0.89	0.78
R-407C	1.53	1.41	1.28	1.15	1.02	0.88	0.74	0.59

These factors include corrections for liquid refrigerant density and net refrigerating effect, and are based on an evaporator temperature of -15°C. However, they may be used for any evaporator temperature from -40°C to 10°C since the variation in the actual factors across this range is insignificant.

AEV Capacity = AEV Rating x CF Liquid Temperature – Example: Actual capacity of an A7-B using R-407C at a 10°C evaporator, 7 bar pressure drop across the AEV, and a 30°C liquid temperature entering the AEV = 10.7 (from rating chart) x 1.02 (CF liquid temperature) = 10.9 kW

Capacity Tables

R-404A Capacities in Tons (R-507 Refrigerant & Liquid Temperature Correction Factor below)

Valve Type	Orifice	Nominal Capacity (Tons)	Capacity Range (Tons)	Evaporator Temperature °F																	
				40°F						20°F						0°F					
				Pressure Drop (PSI)																	
				75	100	125	150	175	200	75	100	125	150	175	200	75	100	125	150	175	200
A1, A2, AT	B	2	1 to 2	1.73	2.00	2.24	2.45	2.65	2.83	1.66	1.92	2.15	2.35	2.54	2.72	1.51	1.74	1.95	2.13	2.30	2.46
A4	—	1/2	1/4 to 3/4	0.65	0.75	0.84	0.92	0.99	1.06	0.62	0.72	0.80	0.88	0.95	1.02	0.57	0.65	0.73	0.80	0.86	0.92
A7-AA	AA	1/2	1/8 to 1/2	0.43	0.50	0.56	0.61	0.66	0.71	0.42	0.48	0.54	0.59	0.63	0.68	0.38	0.44	0.49	0.53	0.58	0.62
A7-A	A	1	1/4 to 1	0.87	1.00	1.12	1.22	1.32	1.41	0.83	0.96	1.07	1.18	1.27	1.36	0.75	0.87	0.97	1.07	1.15	1.23
A7-B	B	2	1 to 2	1.73	2.00	2.24	2.45	2.65	2.83	1.66	1.92	2.15	2.35	2.54	2.72	1.51	1.74	1.95	2.13	2.30	2.46
A7-C	C	4	1-1/2 to 4	3.46	4.00	4.47	4.90	5.29	5.66	3.33	3.84	4.29	4.70	5.08	5.43	3.01	3.48	3.89	4.26	4.60	4.92
AS, ASB20	—	1	1/4 to 1	0.87	1.00	1.12	1.22	1.32	1.41	0.83	0.96	1.07	1.18	1.27	1.36	0.75	0.87	0.97	1.07	1.15	1.23

Valve Type	Orifice	Nominal Capacity (Tons)	Capacity Range (Tons)	Evaporator Temperature °F																	
				-10°F						-20°F						-40°F					
				Pressure Drop (PSI)																	
				100	125	150	175	200	225	125	150	175	200	225	250	125	150	175	200	225	250
A1, A2, AT	B	2	1 to 2	1.48	1.65	1.81	1.96	2.09	2.22	1.36	1.49	1.61	1.73	1.83	1.93	0.87	0.96	1.03	1.10	1.17	1.23
A4	—	1/2	1/4 to 3/4	0.56	0.62	0.68	0.73	0.78	0.83	0.51	0.56	0.61	0.65	0.69	0.72	0.33	0.36	0.39	0.41	0.44	0.46
A7-AA	AA	1/2	1/8 to 1/2	0.37	0.41	0.45	0.49	0.52	0.56	0.34	0.37	0.40	0.43	0.46	0.48	0.22	0.24	0.26	0.28	0.29	0.31
A7-A	A	1	1/4 to 1	0.74	0.83	0.91	0.98	1.05	1.11	0.68	0.75	0.81	0.86	0.92	0.96	0.44	0.48	0.52	0.55	0.59	0.62
A7-B	B	2	1 to 2	1.48	1.65	1.81	1.96	2.09	2.22	1.36	1.49	1.61	1.73	1.83	1.93	0.87	0.96	1.03	1.10	1.17	1.23
A7-C	C	4	1-1/2 to 4	2.96	3.31	3.63	3.92	4.19	4.44	2.73	2.99	3.23	3.45	3.66	3.86	1.74	1.91	2.06	2.21	2.34	2.47
AS, ASB20	—	1	1/4 to 1	0.74	0.83	0.91	0.98	1.05	1.11	0.68	0.75	0.81	0.86	0.92	0.96	0.44	0.48	0.52	0.55	0.59	0.62

■ Gold areas are standard conditions.

Refrigerant	Liquid Temperature Entering AEV							
	0°F	20°F	40°F	60°F	80°F	100°F	120°F	140°F
	Correction Factor							
R-404A	2.04	1.84	1.64	1.43	1.22	1.00	0.77	0.53
R-507	1.95	1.76	1.56	1.37	1.18	0.98	0.76	0.50

These factors include corrections for liquid refrigerant density and net refrigerating effect, and are based on an evaporator temperature of 0°F. However, they may be used for any evaporator temperature from -40°F to 40°F since the variation in the actual factors across this range is insignificant.

AEV Capacity = AEV Rating x CF Liquid Temperature – Example: Actual capacity of an A7-B using R-507 at a 20°F evaporator, 175 psi pressure drop across the AEV, and a 80°F liquid temperature entering the AEV = 2.54 (from rating chart) x 1.18 (CF liquid temperature) = 3.00 tons

R-404A Capacities in Kilowatts (R-507 Refrigerant & Liquid Temperature Correction Factor below)

Valve Type	Orifice	Nominal Capacity (kW)	Capacity Range (kW)	Evaporator Temperature °C																	
				10°C						0°C						-10°C					
				Pressure Drop (BAR)																	
				5	7	9	10	12	14	5	7	9	10	12	14	5	7	9	10	12	14
A1, A2, AT	B	7	4 to 7	6.06	7.17	8.14	8.58	9.39	10.1	5.88	6.96	7.89	8.32	9.11	9.84	5.58	6.60	7.48	7.89	8.64	9.33
A4	—	3	1 to 3	2.27	2.69	3.05	3.22	3.52	3.80	2.21	2.61	2.96	3.12	3.42	3.69	2.09	2.48	2.81	2.96	3.24	3.50
A7-AA	AA	2	1/2 to 2	1.52	1.79	2.03	2.14	2.35	2.54	1.47	1.74	1.97	2.08	2.28	2.46	1.39	1.65	1.87	1.97	2.16	2.33
A7-A	A	4	1 to 4	3.03	3.59	4.07	4.29	4.70	5.07	2.94	3.48	3.95	4.16	4.56	4.92	2.79	3.30	3.74	3.94	4.32	4.67
A7-B	B	7	4 to 7	6.06	7.17	8.14	8.58	9.39	10.1	5.88	6.96	7.89	8.32	9.11	9.84	5.58	6.60	7.48	7.89	8.64	9.33
A7-C	C	14	5 to 14	12.1	14.3	16.3	17.2	18.8	20.3	11.8	13.9	15.8	16.6	18.2	19.7	11.2	13.2	15.0	15.8	17.3	18.7
AS, ASB20	—	4	1 to 4	3.03	3.59	4.07	4.29	4.70	5.07	2.94	3.48	3.95	4.16	4.56	4.92	2.79	3.30	3.74	3.94	4.32	4.67

Valve Type	Orifice	Nominal Capacity (kW)	Capacity Range (kW)	Evaporator Temperature °C																	
				-20°C						-30°C						-40°C					
				Pressure Drop (BAR)																	
				7	9	10	12	14	16	9	10	12	14	16	17	9	10	12	14	16	17
A1, A2, AT	B	7	4 to 7	5.67	6.43	6.77	7.42	8.02	8.57	4.80	5.06	5.54	5.99	6.40	6.60	3.09	3.26	3.57	3.86	4.12	4.25
A4	—	3	1 to 3	2.13	2.41	2.54	2.78	3.01	3.21	1.80	1.90	2.08	2.24	2.40	2.47	1.16	1.22	1.34	1.45	1.55	1.59
A7-AA	AA	2	1/2 to 2	1.42	1.61	1.69	1.86	2.00	2.14	1.20	1.26	1.39	1.50	1.60	1.65	0.77	0.81	0.89	0.96	1.03	1.06
A7-A	A	4	1 to 4	2.83	3.21	3.39	3.71	4.01	4.28	2.40	2.53	2.77	2.99	3.20	3.30	1.55	1.63	1.78	1.93	2.06	2.12
A7-B	B	7	4 to 7	5.67	6.43	6.77	7.42	8.02	8.57	4.80	5.06	5.54	5.99	6.40	6.60	3.09	3.26	3.57	3.86	4.12	4.25
A7-C	C	14	5 to 14	11.3	12.9	13.5	14.8	16.0	17.1	9.60	10.1	11.1	12.0	12.8	13.2	6.18	6.52	7.14	7.71	8.24	8.50
AS, ASB20	—	4	1 to 4	2.83	3.21	3.39	3.71	4.01	4.28	2.40	2.53	2.77	2.99	3.20	3.30	1.55	1.63	1.78	1.93	2.06	2.12

■ Gold areas are standard conditions.

Refrigerant	Liquid Temperature Entering AEV							
	-10°C	0°C	10°C	20°C	30°C	40°C	50°C	60°C
	Correction Factor							
R-404A	1.98	1.79	1.60	1.41	1.21	1.00	0.79	0.56
R-507	1.89	1.71	1.53	1.35	1.17	0.98	0.78	0.53

These factors include corrections for liquid refrigerant density and net refrigerating effect, and are based on an evaporator temperature of -15°C. However, they may be used for any evaporator temperature from -40°C to 10°C since the variation in the actual factors across this range is insignificant.

AEV Capacity = AEV Rating x CF Liquid Temperature – Example: Actual capacity of an A7-B using R-507 at a 0°C evaporator, 12 bar pressure drop across the AEV, and a 30°C liquid temperature entering the AEV = 9.11 (from rating chart) x 1.17 (CF liquid temperature) = 10.7 kW

PARKER CIC GROUP AFTERMARKET - OFFER OF SALE

The goods, services or work (referred to as the "Products") offered by **Parker-Hannifin Corporation, CIC Group Aftermarket** ("Seller") are offered for sale at prices to be established by Seller. This offer and its acceptance by any customer ("Buyer") shall be governed by all of the following Terms and Conditions. Buyer's order for any Products described in its document or the attached proposal, quote or offer, when communicated to Seller verbally, or in writing, shall constitute acceptance of this offer.

1. Terms and Conditions. Seller's willingness to offer Products for sale or accept an order for Products is subject to the terms and conditions contained in this Offer of Sale (also referred to as the "Terms & Conditions") or any newer version of the same, published by Seller electronically at www.parker.com/saleterms/. Seller objects to any contrary or additional terms or conditions of Buyer's order or any other document or other communication issued by Buyer.

2. Price; Payment. Prices stated on Seller's offer, proposal or quote ("Quote") are valid for 30 days, except as explicitly otherwise stated therein, and do not include any sales, use, or other taxes or duties unless specifically stated. Subject to credit approval, payment for all purchases is due 30 days from the date of invoice (or such date as may be specified by Seller's Credit Department). Unpaid invoices beyond the specified payment date incur interest at the rate of 1.5% per month or the maximum allowable rate under applicable law.

3. Shipment; Delivery; Title and Risk of Loss. Unless otherwise specified by Seller, shipment of all Products shall be FOB Seller's facility, or if international, EXW Seller's facility (INCOTERMS 2010). All delivery dates are approximate. Seller is not responsible for damages resulting from any delay. Regardless of the manner of shipment, delivery occurs and title and risk of loss or damage pass to Buyer, upon placement of the Products in shipment with the carrier at Seller's facility. Unless otherwise stated, Seller may exercise its judgment in choosing the carrier and means of delivery. No deferment of shipment at Buyer's request beyond the respective dates indicated will be made except on terms that will indemnify, defend and hold Seller harmless against all loss and additional expense. Buyer shall be responsible for any additional shipping charges incurred by Seller due to Buyer's acts or omissions.

4. Warranty. Seller warrants that the Products sold hereunder shall be free from defects in material or workmanship for a period of twelve months from the date of delivery or 2,000 hours of normal use, whichever occurs first. All prices are based upon the exclusive limited warranty stated above, and upon the following disclaimer: **DISCLAIMER OF WARRANTY: THIS WARRANTY COMPRISES THE SOLE AND ENTIRE WARRANTY PERTAINING TO PRODUCTS PROVIDED. SELLER DISCLAIMS ALL OTHER WARRANTIES, EXPRESS AND IMPLIED, INCLUDING DESIGN, MERCHANTABILITY AND FITNESS FOR A PARTICULAR PURPOSE.**

5. Claims; Commencement of Actions. Buyer shall promptly inspect all Products upon receipt. No claims for shortages will be allowed unless reported to the Seller within 10 days of delivery. No other claims against Seller will be allowed unless asserted in writing within 30 days after delivery. Buyer shall notify Seller of any alleged breach of warranty within 30 days after the date the defect is or should have been discovered by Buyer. Any claim or action against Seller based upon breach of contract or any other theory, including tort, negligence, or otherwise must be commenced within 12 months from the date of the alleged breach or other alleged event, without regard to the date discovered.

6. LIMITATION OF LIABILITY. IN THE EVENT OF A BREACH OF WARRANTY, SELLER WILL, AT ITS OPTION, REPAIR OR REPLACE A DEFECTIVE PRODUCT, OR REFUND THE PURCHASE PRICE WITHIN A REASONABLE PERIOD OF TIME. **IN NO EVENT IS SELLER LIABLE FOR ANY SPECIAL, INDIRECT, INCIDENTAL OR CONSEQUENTIAL DAMAGES ARISING OUT OF, OR AS THE RESULT OF, THE SALE, DELIVERY, NON-DELIVERY, SERVICING, USE OR LOSS OF USE OF THE PRODUCTS OR ANY PART THEREOF, OR FOR ANY CHARGES OR EXPENSES OF ANY NATURE INCURRED WITHOUT SELLER'S WRITTEN CONSENT, EVEN IF SELLER HAS BEEN NEGLIGENT, WHETHER IN CONTRACT, TORT OR OTHER LEGAL THEORY. IN NO EVENT SHALL SELLER'S LIABILITY UNDER ANY CLAIM MADE BY BUYER EXCEED THE PURCHASE PRICE OF THE PRODUCTS.**

7. User Responsibility. The user, through its own analysis and testing, is solely responsible for making the final selection of the system and Product and assuring that all performance, endurance, maintenance, safety and warning requirements of the application are met. The user must analyze all aspects of

the application and follow applicable industry standards and Product information. If Seller provides Product or system options, the user is responsible for determining that such data and specifications are suitable and sufficient for all applications and reasonably foreseeable uses of the Products or systems.

8. Loss to Buyer's Property. Any designs, tools, patterns, materials, drawings, confidential information or equipment furnished by Buyer or any other items which become Buyer's property, will be considered obsolete and may be destroyed by Seller after two consecutive years have elapsed without Buyer ordering the items manufactured using such property. Seller shall not be responsible for any loss or damage to such property while it is in Seller's possession or control.

9. Special Tooling. A tooling charge may be imposed for any special tooling, including without limitation, dies, fixtures, molds and patterns, acquired to manufacture Products. Such special tooling shall be and remain Seller's property notwithstanding payment of any charges by Buyer. In no event will Buyer acquire any interest in apparatus belonging to Seller which is utilized in the manufacture of the Products, even if such apparatus has been specially converted or adapted for such manufacture and notwithstanding any charges paid by Buyer. Unless otherwise agreed, Seller has the right to alter, discard or otherwise dispose of any special tooling or other property in its sole discretion at any time.

10. Buyer's Obligation; Rights of Seller. To secure payment of all sums due or otherwise, Seller retains a security interest all Products delivered to Buyer and this agreement is deemed to be a Security Agreement under the Uniform Commercial Code. Buyer authorizes Seller as its attorney to execute and file on Buyer's behalf all documents Seller deems necessary to perfect its security interest.

11. Improper use and Indemnity. Buyer shall indemnify, defend, and hold Seller harmless from any claim, liability, damages, lawsuits, and costs (including attorney fees), whether for personal injury, property damage, patent, trademark or copyright infringement or any other claim, brought by or incurred by Buyer, Buyer's employees, or any other person, arising out of: (a) improper selection, improper application or other misuse of Products purchased by Buyer from Seller; (b) any act or omission, negligent or otherwise, of Buyer; (c) Seller's use of patterns, plans, drawings, or specifications furnished by Buyer to manufacture Product; or (d) Buyer's failure to comply with these terms and conditions. Seller shall not indemnify Buyer under any circumstance except as otherwise provided.

12. Cancellations and Changes. Buyer may not modify or cancel any order for any reason, except with Seller's written consent and upon terms that will indemnify, defend and hold Seller harmless against all direct, incidental and consequential loss or damage. Seller may change product features, specifications, designs and availability with notice to Buyer.

13. Limitation on Assignment. Buyer may not assign its rights or obligations under this agreement without the prior written consent of Seller.

14. Force Majeure. Seller does not assume the risk and is not liable for delay or failure to perform any of Seller's obligations by reason of events or circumstances beyond its reasonable control (hereinafter "Events of Force Majeure"). Events of Force Majeure shall include without limitation: accidents, strikes or labor disputes, acts of any government or government agency, acts of nature, delays or failures in delivery from carriers or suppliers, shortages of materials, or any other cause beyond Seller's reasonable control.

15. Waiver and Severability. Failure to enforce any provision of this agreement will not invalidate that provision; nor will any such failure prejudice Seller's right to enforce that provision in the future. Invalidation of any provision of this agreement by legislation or other rule of law shall not invalidate any other provision herein. The remaining provisions of this agreement will remain in full force and effect.

16. Termination. Seller may terminate this agreement for any reason and at any time by giving Buyer thirty (30) days advance written notice. Seller may immediately terminate this agreement, in writing, if Buyer: (a) commits a breach of any provision of this agreement (b) appointments a trustee, receiver

or custodian for all or any part of Buyer's property (c) files a petition for relief in bankruptcy on its own behalf, or by a third party (d) makes an assignment for the benefit of creditors, or (e) dissolves or liquidates all or a majority of its assets.

17. Governing Law. This agreement and the sale and delivery of all Products are deemed to have taken place in, and shall be governed and construed in accordance with, the laws of the State of Ohio, as applicable to contracts executed and wholly performed therein and without regard to conflicts of laws principles. Buyer irrevocably agrees and consents to the exclusive jurisdiction and venue of the courts of Cuyahoga County, Ohio with respect to any dispute, controversy or claim arising out of or relating to this agreement.

18. Indemnity for Infringement of Intellectual Property Rights. Seller is not liable for infringement of any patents, trademarks, copyrights, trade dress, trade secrets or similar rights except as provided in this Section. Seller will defend and indemnify Buyer against allegations of infringement of U.S. patents, U.S. trademarks, copyrights, trade dress and trade secrets ("Intellectual Property Rights"). Seller will defend at its expense and will pay the cost of any settlement or damages awarded in an action brought against Buyer based on an allegation that a Product sold pursuant to this agreement infringes the Intellectual Property Rights of a third party. Seller's obligation to defend and indemnify Buyer is contingent on Buyer notifying Seller within ten (10) days after Buyer becomes aware of such allegations of infringement, and Seller having sole control over the defense of any allegations or actions including all negotiations for settlement or compromise. If a Product is subject to a claim that it infringes the Intellectual Property Rights of a third party, Seller may, at its sole expense and option, procure for Buyer the right to continue using the Product, replace or modify the Product so as to make it noninfringing, or offer to accept return of the Product and return the purchase price less a reasonable allowance for depreciation. Notwithstanding the foregoing, Seller is not liable for claims of infringement based on information provided by Buyer, or directed to Products delivered hereunder for which the designs are specified in whole or part by Buyer, or infringements resulting from the modification, combination or use in a system of any Product sold hereunder. The foregoing provisions of this Section constitute Seller's sole and exclusive liability and Buyer's sole and exclusive remedy for infringement of Intellectual Property Rights.

19. Entire Agreement. This agreement contains the entire agreement between the Buyer and Seller and constitutes the final, complete and exclusive expression of the terms of sale. All prior or contemporaneous written or oral agreements or negotiations with respect to the subject matter are herein merged.

20. Compliance with Law, U. K. Bribery Act and U.S. Foreign Corrupt Practices Act. Buyer agrees to comply with all applicable laws and regulations, including both those of the United Kingdom and the United States of America, and of the country or countries of the Territory in which Buyer may operate, including without limitation the U. K. Bribery Act, the U.S. Foreign Corrupt Practices Act ("FCPA") and the U.S. Anti-Kickback Act (the "Anti-Kickback Act"), and agrees to indemnify and hold harmless Seller from the consequences of any violation of such provisions by Buyer, its employees or agents. Buyer acknowledges that it is familiar with the provisions of the U. K. Bribery Act, the FCPA and the Anti-Kickback Act, and certifies that Buyer will adhere to the requirements thereof. In particular, Buyer represents and agrees that Buyer will not make any payment or give anything of value, directly or indirectly to any governmental official, any foreign political party or official thereof, any candidate for foreign political office, or any commercial entity or person, for the purpose of influencing such person to purchase products or otherwise benefit the business of Seller.

For Products sold by CIC Group Aftermarket Division, the following additional terms apply:

- Payment Terms: Subject to credit approval, 1% 10th-Prox; Net 30 days
- Freight prepaid on \$1,500 net order value



Parker Hannifin Corporation
Climate and Industrial Controls Group
2445 South 25th Avenue • Broadview, IL 60155-3891 USA
phone 800 742 2681 • fax 800 241 2872
www.parker.com/coolparts