

# Model RVS32

ASME Safety Valve  
10322 Series

## SUBMITTAL SHEET

# "Apollo" Valves



Job Name:	
Job Location:	
Engineer:	
Contractor:	
Tag:	
PO#:	
Rep:	
Wholesale Dist.:	

### DESCRIPTION

ASME Section VIII design certified safety valve to protect portable steam vessel applications such as autoclaves, sterilizers and pressure cookers against excess build-up. Made from proved ASTM grade brass with optional decorative chrome finish.

### FEATURES

- 15-60 psig Pressure Range
- Corrosion Resistant Construction
- Chrome Plate Finish Option
- **Made in the USA**

### APPROVALS

- National Board (NB) Certified Capacity
- ASME Section VIII Div 1 Pressure Vessels for Steam, Air/Gas and Liquids
- Canadian Registration Number OG8547.5C
- Pressure Equipment Directive 2014/68/EU (PED)

### STANDARD MATERIALS LIST

<b>BODY</b>	ASTM B16 Brass
<b>NOZZLE</b>	ASTM B62 Bronze
<b>SPRING</b>	Stainless Steel
<b>SEAT</b>	Steam Grade EPDM

\*Set pressures and temperatures vary by model.  
Refer to catalog for sizing and selection information

### AVAILABLE CONFIGURATIONS

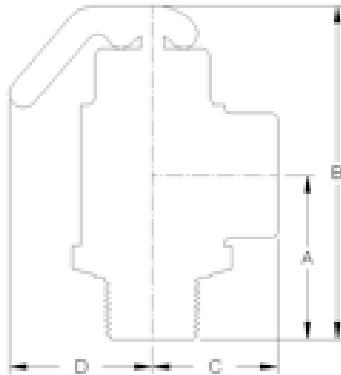

MODEL NUMBER	SERIES NUMBER	SIZE (.in)	DIMENSIONS (.in)			
			A	B	C	D
RVS32	10322	3/4M X 3/4F	1.81 (46)	3.69 (94)	1.38 (35)	1.56 (40)

### CAPACITY

SET PRESSURE PSIG (bar)	10-322 Capacity Lb/Hr (Kg/Hr)
20 (1.38)	325 (147)
25 (1.72)	375 (170)
30 (2.07)	425 (193)
35 (2.41)	475 (215)
40 (2.76)	525 (238)
45 (3.10)	575 (261)
50 (3.45)	625 (284)
55 (3.79)	675 (306)
60 (4.14)	725 (339)

### PART NUMBER MATRIX

10	XXX	XX	X	X
SERIES NUMBER	MODEL	FINISH	SET PRESSURE	OPTION
10	322 (3/4" x 3/4")	B = Plain Brass P = Polished Chrome	Set Pressure, PSIG (2 digits)	B = BSPP Connections CE = PED/CE S = Stainless Steel Trim V = Viton X = Outlet Not Threaded