

TORQUE AND CURRENT VS SPEED CURVE

Three Phase Induction Motor - Squirrel Cage



Customer :

Product line : Rolled Steel NEMA Premium Efficiency Three-Phase

Product code : 12502805

Catalog # : 01518OT3E254T-S

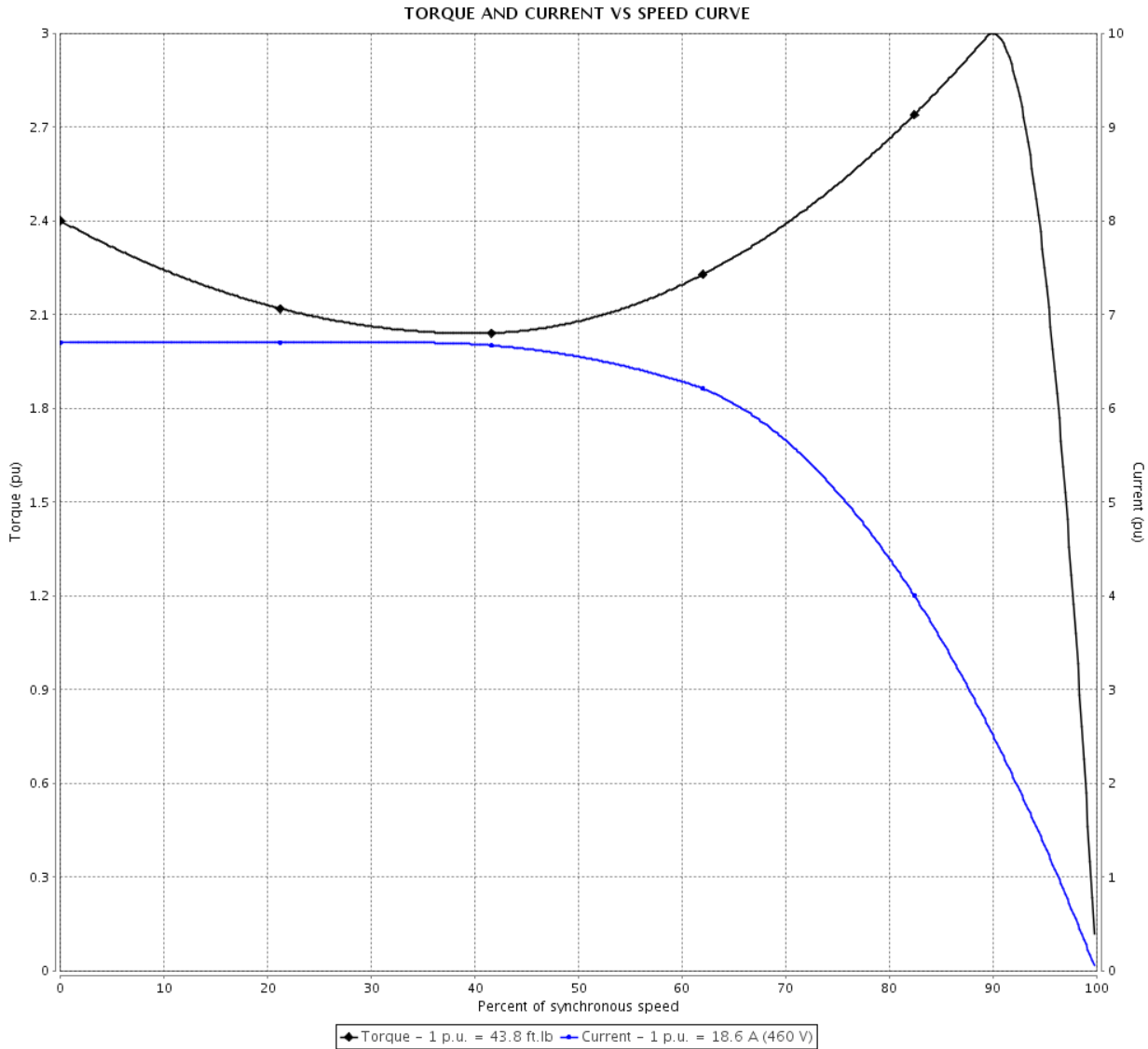

Performance : 208-230/460 V 60 Hz 4P

Rated current	: 41.1-37.2/18.6 A	Moment of inertia (J)	: 1.82 sq.ft.lb
LRC	: 6.7	Duty cycle	: Cont.(S1)
Rated torque	: 43.8 ft.lb	Insulation class	: F
Locked rotor torque	: 240 %	Service factor	: 1.15
Breakdown torque	: 300 %	Temperature rise	: 80 K
Rated speed	: 1775 rpm	Design	: B

Locked rotor time : 30s (cold) 17s (hot)

Rev.	Changes Summary	Performed	Checked	Date
Performed by			Page 2 / 6	Revision
Checked by				
Date	26/10/2018			

LOAD PERFORMANCE CURVE

Three Phase Induction Motor - Squirrel Cage



Customer : _____

Product line : Rolled Steel NEMA Premium Efficiency Three-Phase

Product code : 12502805

Catalog # : 01518OT3E254T-S

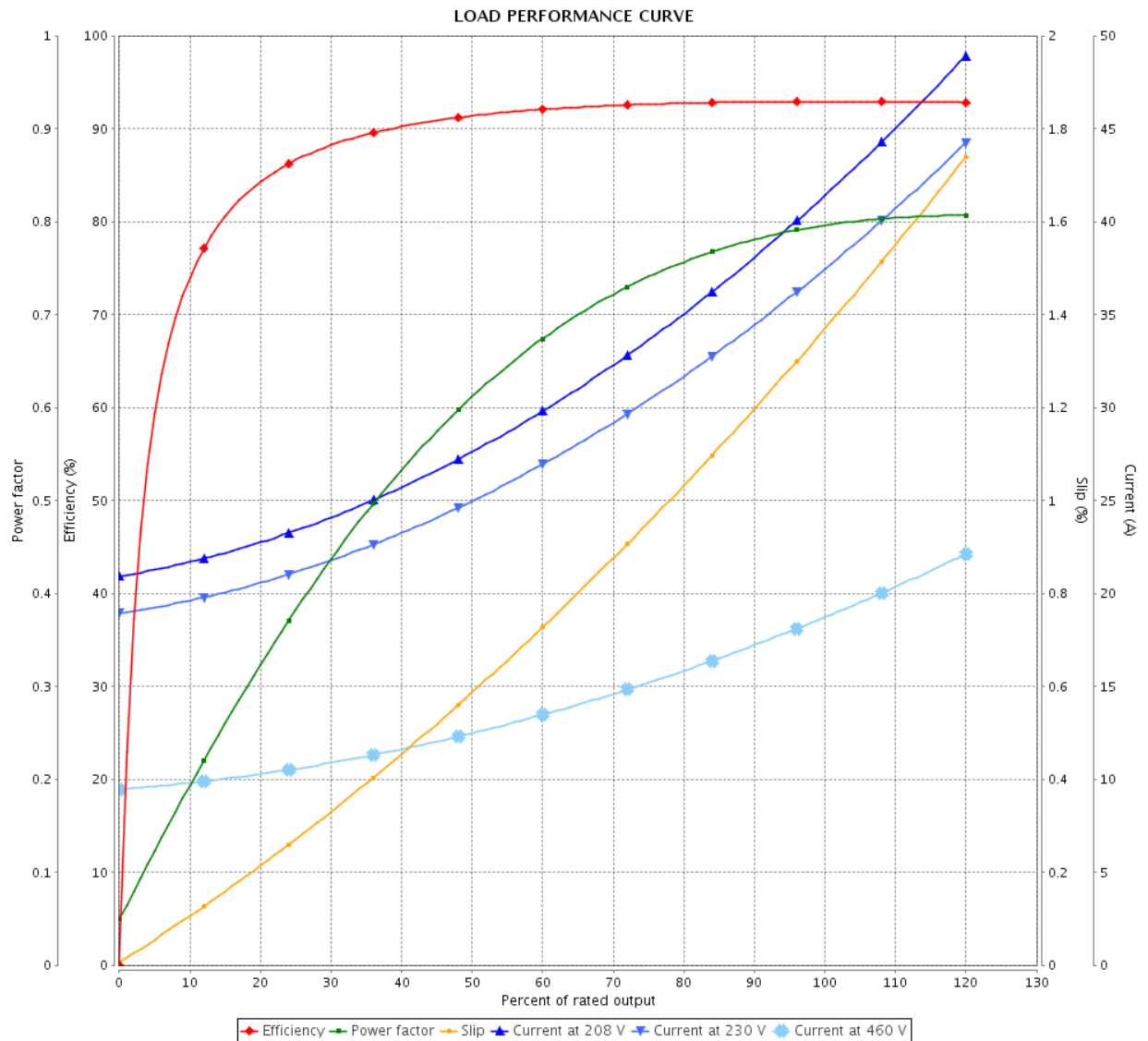

Performance : 208-230/460 V 60 Hz 4P

Rated current : 41.1-37.2/18.6 A
 LRC : 6.7
 Rated torque : 43.8 ft.lb
 Locked rotor torque : 240 %
 Breakdown torque : 300 %
 Rated speed : 1775 rpm

Moment of inertia (J) : 1.82 sq.ft.lb
 Duty cycle : Cont.(S1)
 Insulation class : F
 Service factor : 1.15
 Temperature rise : 80 K
 Design : B

Rev.	Changes Summary	Performed	Checked	Date
Performed by			Page	Revision
Checked by				
Date				

THERMAL LIMIT CURVE



Three Phase Induction Motor - Squirrel Cage

Customer :

Product line : Rolled Steel NEMA Premium
Efficiency Three-Phase

Product code : 12502805

Catalog # : 01518OT3E254T-S

Performance : 208-230/460 V 60 Hz 4P

Rated current : 41.1-37.2/18.6 A
LRC : 6.7
Rated torque : 43.8 ft.lb
Locked rotor torque : 240 %
Breakdown torque : 300 %
Rated speed : 1775 rpm

Moment of inertia (J) : 1.82 sq.ft.lb
Duty cycle : Cont.(S1)
Insulation class : F
Service factor : 1.15
Temperature rise : 80 K
Design : B

Heating constant

Cooling constant

Rev.	Changes Summary	Performed	Checked	Date
Performed by				
Checked by			Page	Revision
Date	26/10/2018		4 / 6	

THERMAL LIMIT CURVE

Three Phase Induction Motor - Squirrel Cage



Customer : _____

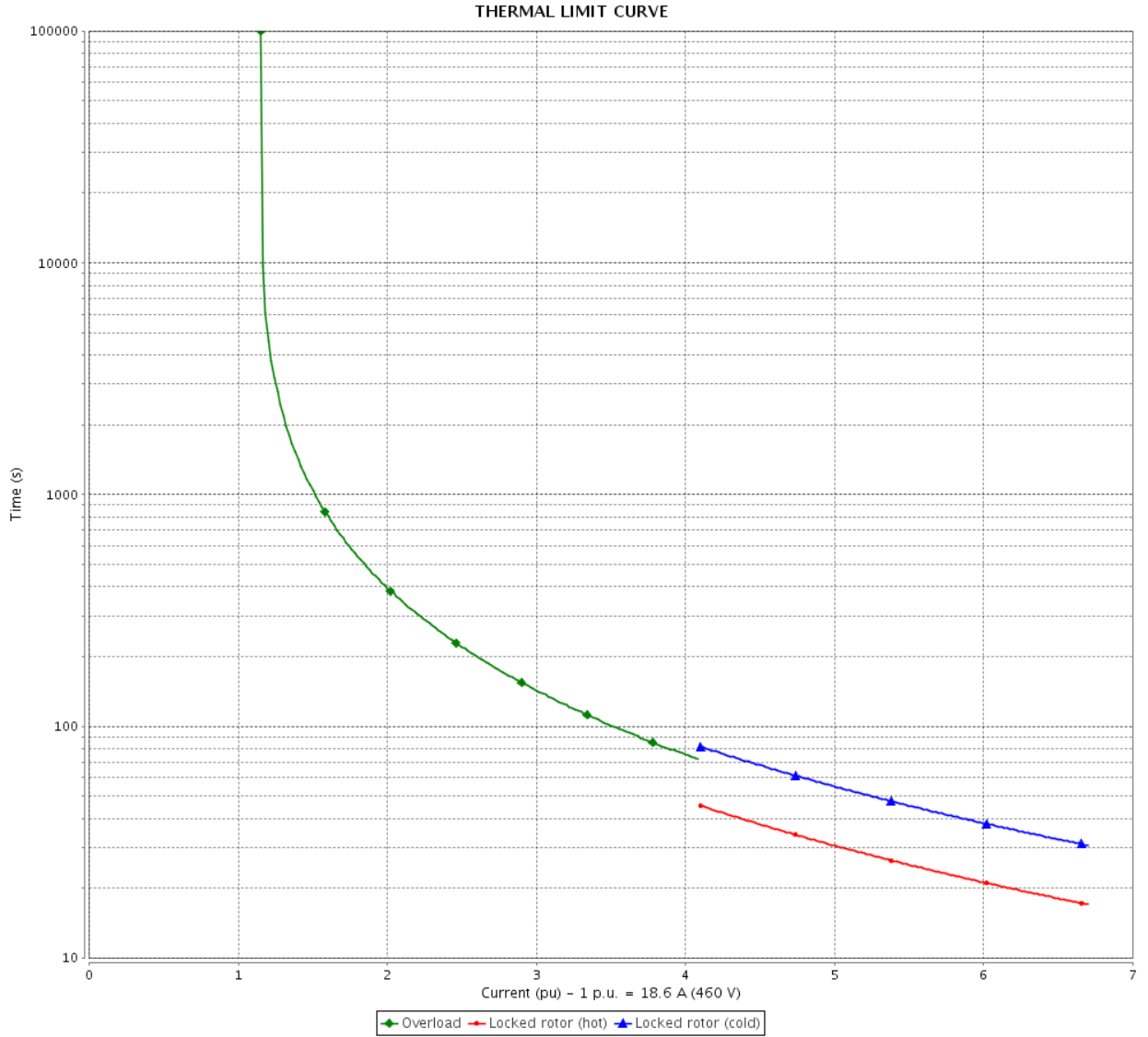

Rev.	Changes Summary	Performed	Checked	Date
Performed by		Page Revision 5 / 6		
Checked by				
Date				

VFD OPERATION CURVE

Three Phase Induction Motor - Squirrel Cage



Customer :

Product line : Rolled Steel NEMA Premium Efficiency Three-Phase

Product code : 12502805

Catalog # : 01518OT3E254T-S

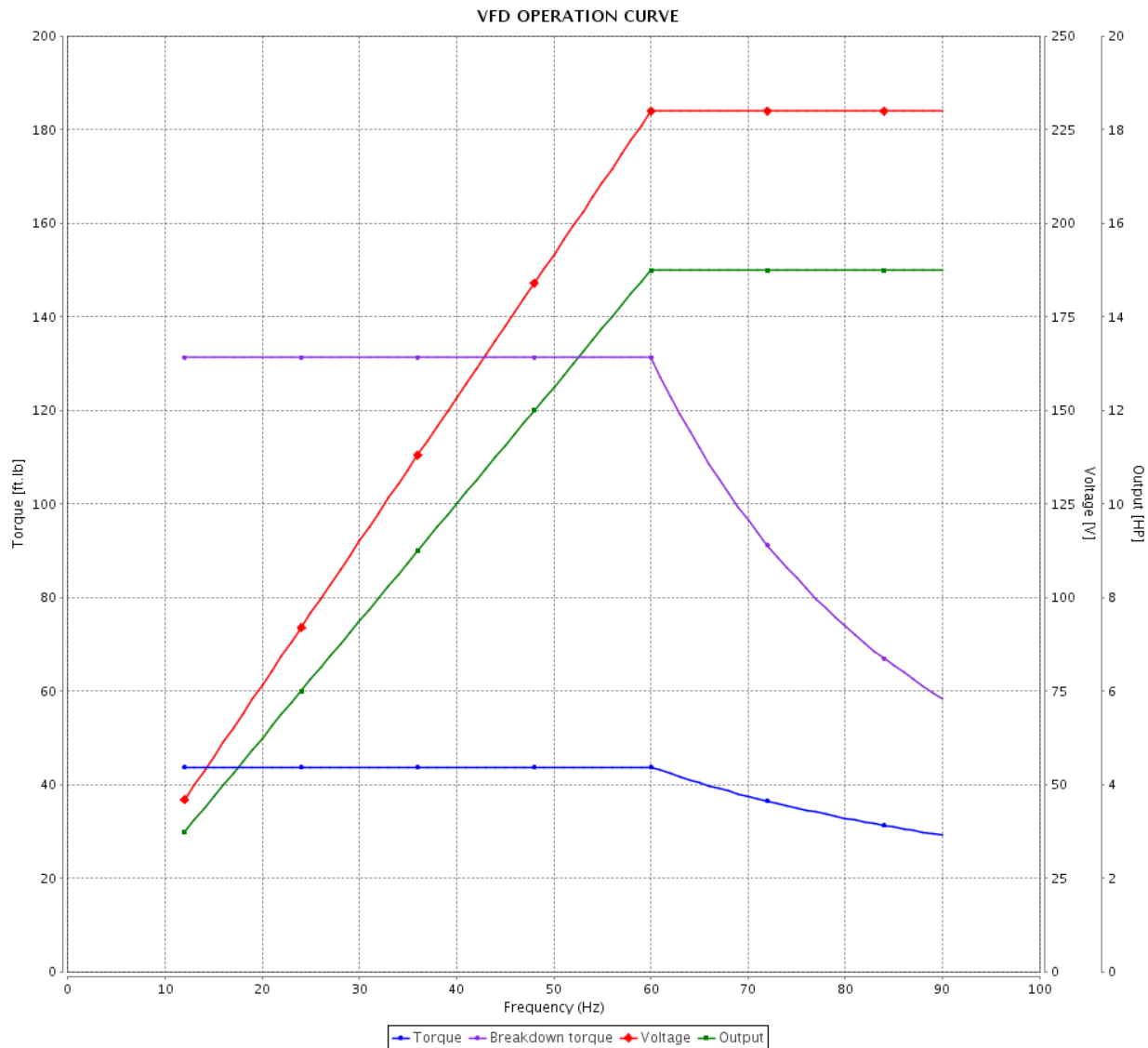

Performance : 208-230/460 V 60 Hz 4P

Rated current : 41.1-37.2/18.6 A
 LRC : 6.7
 Rated torque : 43.8 ft.lb
 Locked rotor torque : 240 %
 Breakdown torque : 300 %
 Rated speed : 1775 rpm

Moment of inertia (J) : 1.82 sq.ft.lb
 Duty cycle : Cont.(S1)
 Insulation class : F
 Service factor : 1.15
 Temperature rise : 80 K
 Design : B

Rev.	Changes Summary	Performed	Checked	Date
Performed by			Page 6 / 6	Revision
Checked by				
Date	26/10/2018			

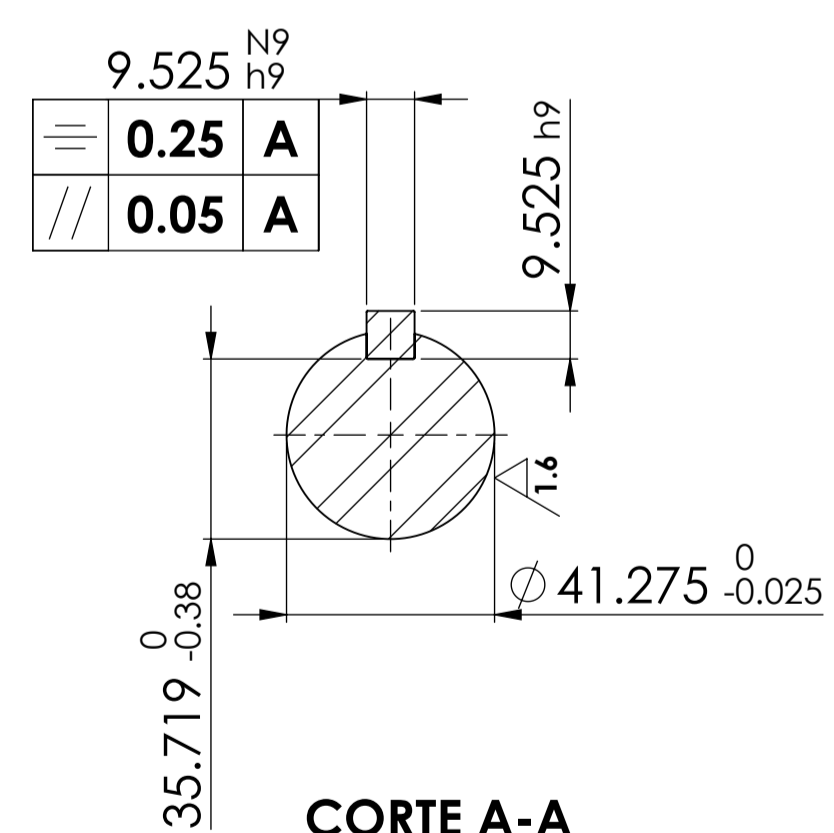
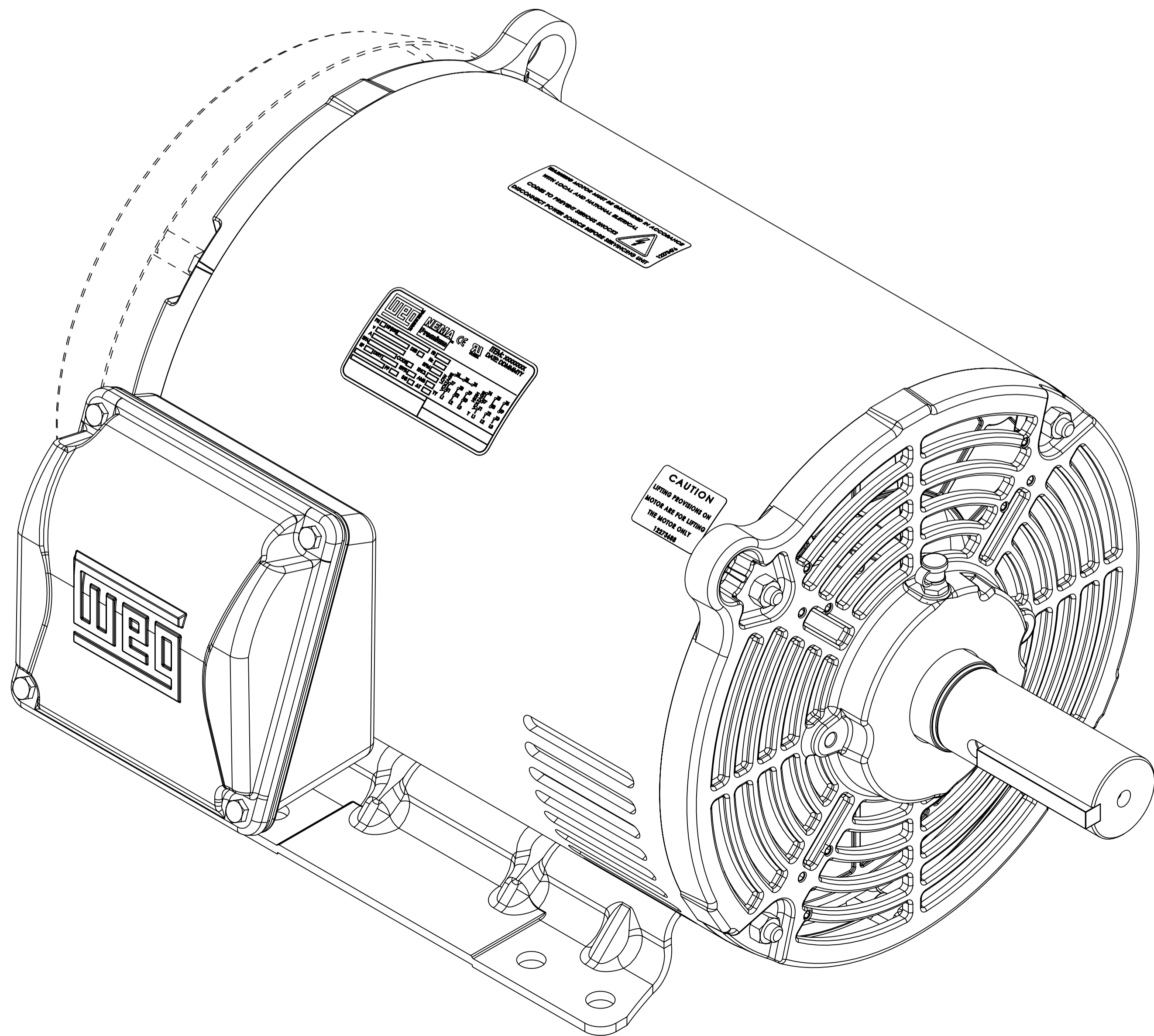
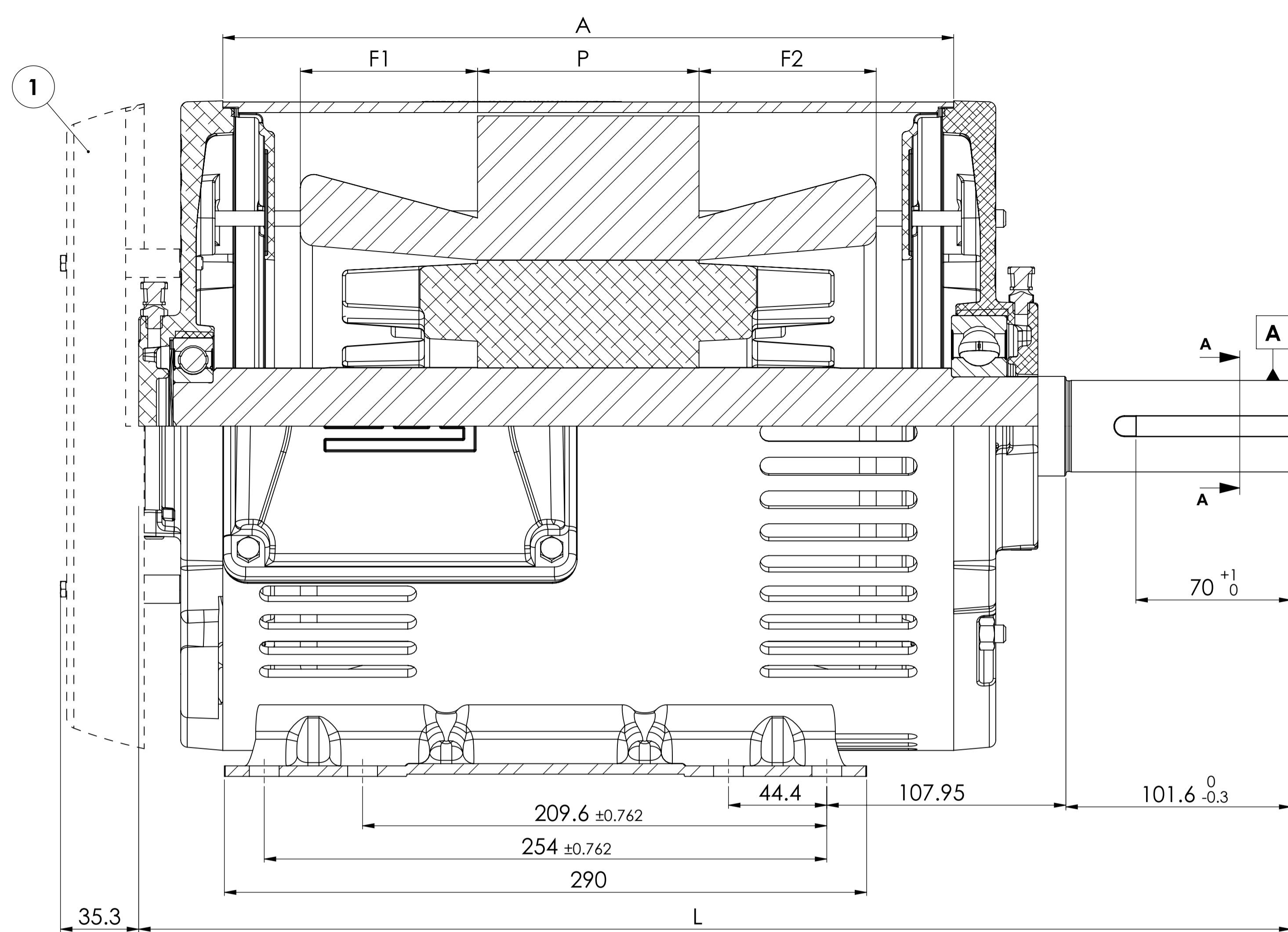
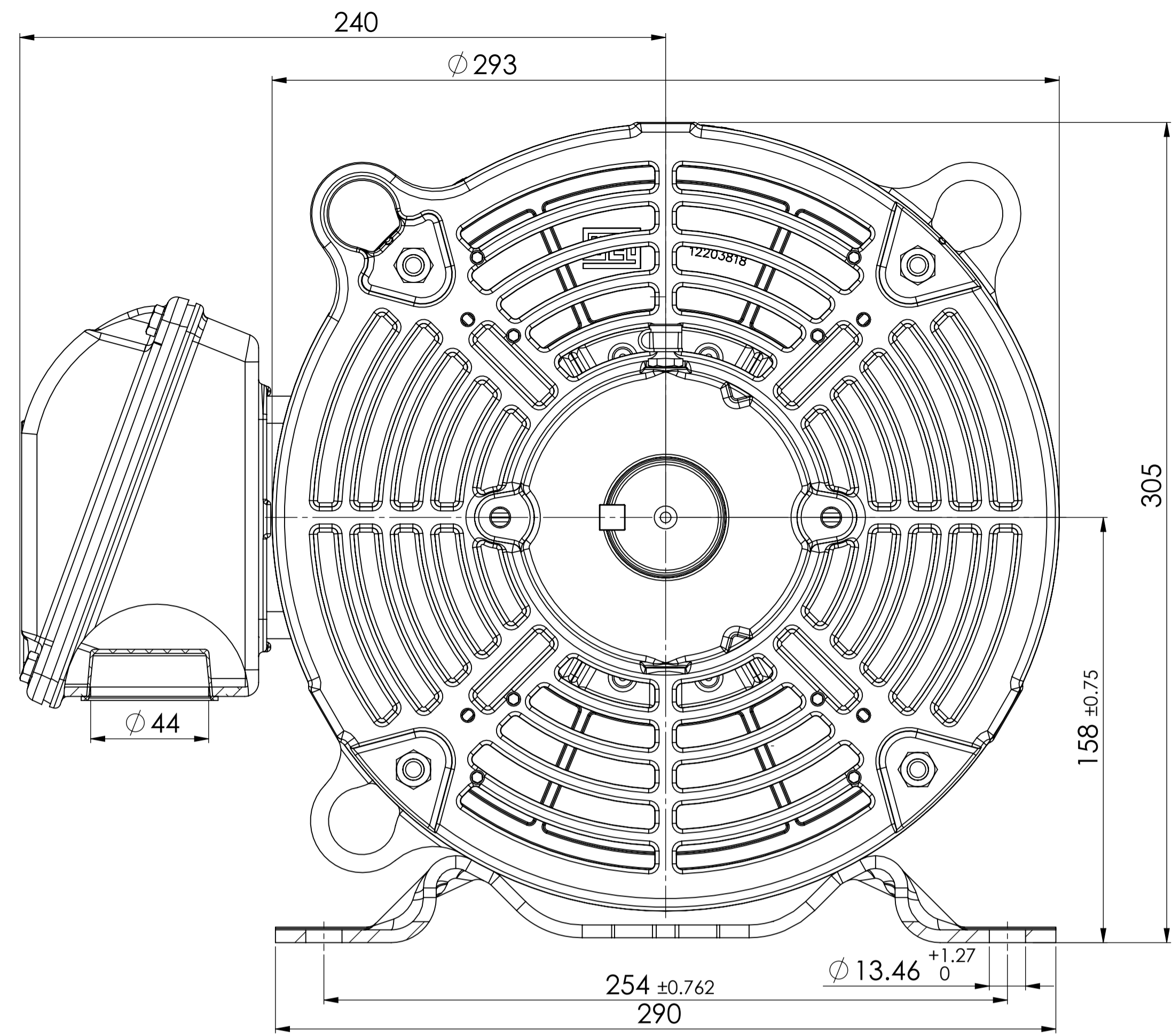

Cabeça de Bobina	F1	F2
II	80	80
IV - VI	65	65

Cotas / Carcaça	330
A	330
P	80-150
L	520

1. SOMENTE QUANDO INDICADO NA LISTA TÉCNICA DO MOTOR

MASSA BRUTA/GROSS WEIGHT	MASSA LÍQUIDA/NET WEIGHT	ESCALA/SCALE	1:5
500001081712	REVISÃO NORMA CABEÇA BOBINA	JROPELATO	JHONATANP
500000886238	ALT. CONF. CLAIM 413416105	PMAUERBERG	ALISSON
ECM	LOC	RESUMO DE MODIFICAÇÕES SUMMARY OF MODIFICATIONS	EXECUTADO CHECKED
EXEC	RAFAELLOPES	DIMENSIONAL 254 ODP TPA NORMAL	10002035853
VERIFICADO	JTOGNERI		000 05
LIBERADO	24.04.2013	WMO JARAGUÁ DO SUL	DESENVOLVIMENTO DE PRODUTO
DT LIBER/REL DT	24.04.2013	WMO	JARAGUÁ DO SUL